

# SWOG FALL 2011 GROUP MEETING



© Teach and Learn

## Welcome to SWOG's Fall 2011 Meeting!



“Bench to bedside” is a well worn phrase, referring to the movement of basic science results from the lab to clinical practice where it can improve outcomes for patients. But the flow of knowledge should not go just one way; bench to bedside should also imply bedside to bench, with what’s learned in clinical research informing and guiding the laboratory research agenda as well.

This bench-to-bedside-to-bench cycle for advancing medical knowledge is a major theme of our meeting this fall. Don’t miss Friday’s plenary session to see some of this cycle in motion.

While you’re here in San Antonio, take advantage of some of what this great city has to offer – the River Walk, the Alamo, the Spanish Governor’s Palace, the food. Part of why we’re here is to mark the 30th anniversary of our Operations Office’s making this city its home. Take time to celebrate!

Un cordial saluda,

A handwritten signature in black ink that reads "Laurence H. Baker, D.O." in a cursive style.

Laurence H. Baker, D.O.  
Group Chairman

## Fall 2011 Meeting Plenary Session

12:15 - 2:45 pm  
Friday, October 14  
Regency Ballroom

# Bench to Bedside

**James B. Hicks**  
Research Professor,  
Cold Spring Harbor Laboratory

**Ana Maria Gonzalez-Angulo**  
Associate Professor, MD Anderson Cancer Center

**Raffaella Sordella**  
Assistant Professor, Cold Spring Harbor Laboratory

**John Crowley**  
Group Statistician, SWOG

**Mikala Egeblad**  
Assistant Professor, Cold Spring Harbor Laboratory

**Anne Schott**  
Associate Professor, University of Michigan

SWOG's Fall 2011 Group Meeting Plenary Session brings three eminent laboratory scientists together with three leading clinical researchers. Each laboratory scientist will present on current research in cancer science. Each clinical researcher will place that work into a clinical context, exploring its implications for the treatment of patients and how it might drive clinical trials. Visit [swog.org/plenary](http://swog.org/plenary).

**SWOG**   
Leading cancer research. Together.

## Connecting the docs

# GROUP MEETING INDEX

	PAGE(S)
<b>Plenary Session</b> .....	3 & 13
<b>Hyatt Regency San Antonio Travel and Hotel Information and Hotel Maps</b> .....	6-7
<b>Schedule of Events</b> .....	11-14
<b>Roster of Committee Speakers</b> .....	15-16
<b>Administrative Committees</b> .....	17
<b>The Hope Foundation</b> .....	18
<b>Accrual Information (Accrual by Institution and Accrual by Institution and Committee)</b> .....	21-28
<b>Committee Information</b>	
Barlogie-Salmon Myeloma Committee .....	13 & 29-32
Breast Committee .....	13 & 33-39
Board of Governors .....	14
Bone Marrow & Stem Cell Transplantation Committee.....	13
Cancer Control and Prevention Committees.....	12-13 & 40-53
Cancer Survivorship Committee .....	13 & 42
Molecular Epidemiology Committee.....	12 & 43
Outcomes and Comparative Effectiveness Committee .....	12 & 44
Prevention Committee.....	12 & 45-46
Symptom Control and Quality of Life Committee .....	12 & 47-48
Clinical Practices Committee.....	14
Committee Chairs .....	14
Early Therapeutics Committee.....	12 & 54
Gastrointestinal Committee.....	13 & 55-59
Genitourinary Committee .....	14 & 60-64
Gynecologic Committee.....	65
Leukemia Committee.....	13 & 66-70
Lung Committee.....	14 & 71-74
Lymphoma Committee.....	14 & 75-78
Melanoma Committee .....	13 & 79-82
Pharmaceutical Sciences Committee .....	14
Radiation Therapy Committee .....	14
Scientific Leaders Advisory Meeting.....	12
Surgery Committee .....	13 & 20
<b>Training &amp; Workshops</b>	
Clinical Research Associates Continuing Education Workshop .....	13 & 20
Clinical Research Associates Open Forum.....	12 & 19
Clinical Research Associates Plenary Session.....	12
Jeri and Noboru Oishi Nurse Oncologist Symposium .....	11 & 19
Special Symposia .....	19-20
<b>Future Group Meeting Dates</b> .....	83
<b>Group Meeting Supporters</b> .....	8 & 88



# OUR EVENT HAS GONE MOBILE!

Schedule, Maps, Twitter and more on your mobile device - completely free.

Download **Guidebook** on the Apple App Store or Android Marketplace or visit [m.guidebookapp.com](http://m.guidebookapp.com)



guidebook

[guidebookapp.com](http://guidebookapp.com)

# San Antonio Travel & Hotel Information

**Hyatt Regency San Antonio**  
**123 Losoya Street**  
**San Antonio, TX 78205**  
**Phone: 210-222-1234**  
**Fax: 210-227-4928**



## Arrival/Departure:

Check-in time is 3:00 p.m. Check-out time is 12:00 noon. Room amenities include a full bath, hair dryer, ironing board and iron. The concierge staff serves as a liaison between guests and the hotel and outside services.

## Hotel Safety Deposit Boxes:

For your convenience, safety deposit boxes are available at the front desk for your valuables. Please do not leave valuables in your room.

## Recreational Facilities:

The fitness center offers a variety of exercise equipment, free weights, treadmills, and more, exclusively for hotel guests. It is open 24 hours a day. There is a heated rooftop swimming pool and whirlpool for any interested guests. Also available is the DASA Spa on the River Walk, which is conveniently located in the hotel atrium.

## Hotel Restaurants and Lounges:

- Q Restaurant offers authentic Texas-style cuisine with a flare. Open for breakfast, lunch and dinner.
- Q Bar specializes in a wide variety of cocktails, wines, beers and cognacs.
- Einstein Bros Bagels offers on-the-go breakfast or a quick lunch
- In-room dining is available from 6:00 a.m. - 12:00 a.m. daily.

## Business Center:

The Business Center is located on the Ballroom level of the hotel. It is open Monday - Friday from 7:00 am - 7:00 pm and on Saturday from 9:00 am - 1:00 pm. The Business Center offers fax machines, computer services, color copies, mail drop, Internet access and photocopying.

## Ground Transportation:

- A taxi ride from San Antonio airport to the hotel is approximately \$30.00 one-way.
- Valet parking at the hotel is \$33.00 per day for hotel guests. Self-parking is available for \$25.00 for hotel guests.

## Temperature:

The average high for October is 82 degrees and the average low is 60 degrees.

## Area Attractions:

- The Alamo
- San Antonio River Walk
- Six Flags Fiesta Texas Theme Park
- Sea World
- San Antonio Zoo
- Japanese Sunken Gardens
- Majestic Theater
- San Antonio Museum of Art
- San Antonio Children's Museum
- Institute of Texan Cultures
- King William Historic District
- La Villita Spanish Village
- Southwest Craft Center
- Wittee Museum
- McNay Art Museum

## Local Restaurants:

(The hotel concierge can assist with reservations and suggestions)

- Acenar - Mexican
- Biga on the Banks - American
- Boudros - American
- Dick's Last Resort - American
- Landry's - Seafood
- Le Reve - French
- Little Rhein Steakhouse - Steak
- Paesano's Riverwalk - Italian
- Pesca on the River - Seafood
- Republic of Texas - American
- Rio Rio Cantina - Mexican
- Rosarios - Mexican
- Zuni Grill - Southwest

Hyatt Regency San Antonio

LOBBY LEVEL

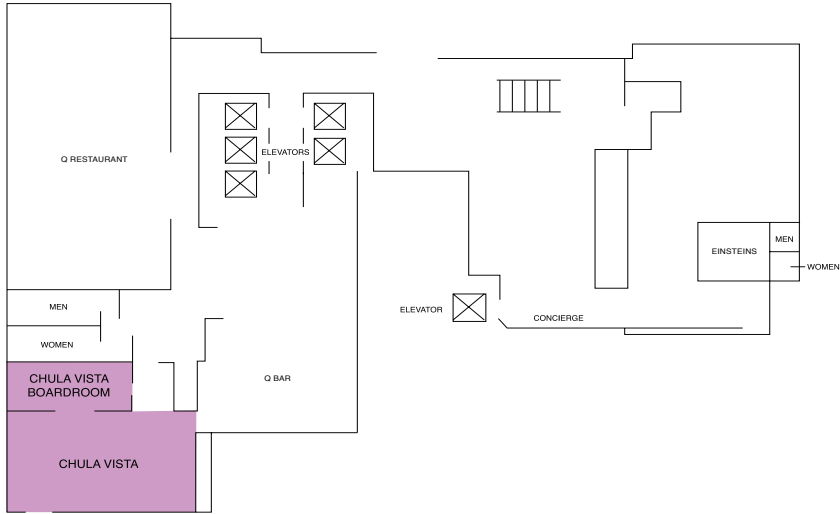

**Order of Levels (Bottom to Top):**  
 Lobby Level  
 Ballroom Level  
 Hill Country Level

BALLROOM LEVEL

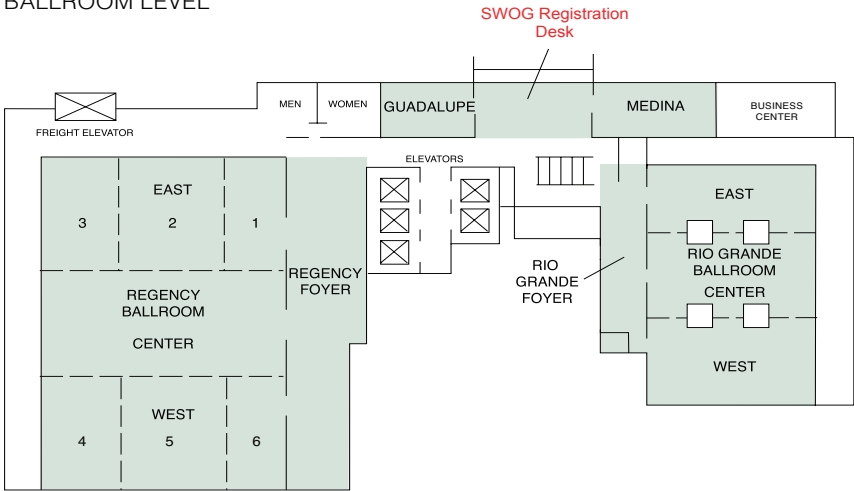

HILL COUNTRY LEVEL

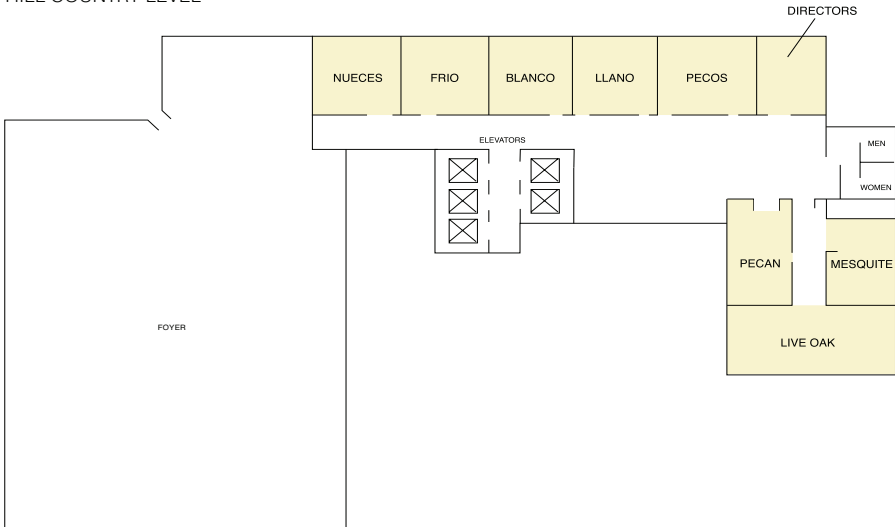

## CME Credit Information

### Procedures for CME Credit

CME credit forms for the Group Meeting are available on pages 85 and 87 of the Group Meeting agenda booklet. Only one form per person is required to list the CME credits for the entire meeting. Credits for each committee session are listed on the form.

Forms should be turned in to the Registration Desk before the desk closes at 12:30 p.m. on October 15, 2011. If the forms are not turned in to the desk, they can be mailed to the Operations Office the week following the Group Meeting. The Operations Office will submit all CME forms to the accrediting institution at one time. **Forms will be submitted 30 days following the meeting. You will then receive a certificate of completion in the mail following submission and processing of the CME forms by the accrediting institution.**

### Group Meeting Target Audience and Educational Objectives

SWOG meets semi-annually to keep its members abreast of Group science. The target audience for these meetings are Physicians, Nurse Oncologists and Clinical Research Associates.

The educational objectives of these meetings are: to educate attendees about active and proposed studies so that they may implement the studies at their local institutions; to educate attendees about new treatments and prevention strategies that are available; to identify areas that can be improved in cancer research and study implementation and educate attendees on the best ways to implement the solutions at the local level.

These objectives apply to the following areas: Cancer Control and Prevention, including Outcomes and Comparative Effectiveness Committee, Symptom Control and Quality of Life Committee, Prevention Committee, Molecular Epidemiology Committee, Cancer Survivorship Committee and Harry Hynes Symposium; Genitourinary Committee; Early Therapeutics Committee; Myeloma Committee; Melanoma Committee; Surgery Committee; Radiation Therapy Committee; Plenary Session; Leukemia Committee; Breast Committee; Gastrointestinal Committee; Lung Committee and Lymphoma Committee.

### Continuing Medical Education Credit

This activity has been planned and implemented in accordance with the Essential Areas and policies of the Accreditation Council for Continuing Medical Education (ACCME) through the joint sponsorship of Wayne State University School of Medicine, Karmanos Cancer Institute and SWOG. The Wayne State University School of Medicine is accredited by the ACCME to provide continuing medical education for physicians..

The Wayne State University School of Medicine designates this live activity for a maximum of 23.00 **AMA PRA Category 1 Credit(s)**<sup>™</sup>. Physicians should only claim the credit commensurate with the extent of their participation in the activity.

SWOG gratefully acknowledges the support of our CME Commercial Supporters

#### Double Platinum Supporters

Novartis

#### Platinum Supporters

Amgen

Eli Lilly & Co.

#### Gold Supporters

Otsuka Pharmaceuticals

#### Silver Supporters

Abbott Oncology

Eisai

Merck

#### Bronze Supporters

Astellas Pharmaceuticals

### Speaker and Planner CME Disclosure Information

Each speaker and planner for Wayne State University - CME courses has been requested to complete a Faculty Disclosure Form prior to the activity. Information regarding affiliations or interests that might be perceived as a potential conflict of interest is provided in the agenda book, for everyone to review.

**Disclosure of Relevant Financial Relationships with Commercial Companies**

Wayne State University School of Medicine Office of Continuing Medical Education endorses the Standards of the Accreditation Council for Continuing Medical Education and the Guidelines of the American Medical Association.

Wayne State University School of Medicine requires that all presentations at CME activities be fair, balanced, free of commercial bias, and fully supported by scientific evidence.

Everyone who is in a position to control the content of a continuing medical education activity is required to disclose relevant relationships with commercial companies whose products or services are discussed in educational presentations. The ACCME considers relationships of the person involved in the CME activity to include financial relationships of a spouse or partner.

Disclosure of a relationship is not intended to suggest bias in any presentation but is made to provide participants with information that might be of potential importance to their evaluation of a presentation.

All potential conflicts of interest have been resolved prior to this program.

Acknowledging a relevant relationship with the following companies or organizations having a direct interest in the subject of this presentation include:

<u>Planner/Faculty Member</u>	<u>Nature of Relationship</u>	<u>Company</u>
<b>Frederick Appelbaum, M.D.</b>	Consultant	Abbott, SuperGen and Celator
<b>Laurence Baker, D.O.</b>	No Disclosures	
<b>Marianne Berwick, Ph.D.</b>	No Disclosures	
<b>Charles Blanke, M.D.</b>	Consultant	Novartis
<b>Powell Brown, M.D.</b>	No Disclosures	
<b>John Crowley, Ph.D.</b>	Consultant	SuperGen
<b>Mikala Egeblad, Ph.D.</b>	No Disclosures	
<b>Richard Fisher, M.D.</b>	Consultant	Pfizer, Roche and Millennium
<b>David Gandara, M.D.</b>	Consultant	Amgen, AstraZeneca, Biodesix, BI, BMS, ImClone, GSK, Genentech, Merck, Novartis and Sanofi-Aventis
	Research Grant	Abbott, BMS, ImClone, Genentech, Lilly, Merck, Novartis and Pfizer
	Other	Response Genetics, Inc., BOD (relationship ended)
<b>Ana Maria Gonzalez-Angulo, M.D.</b>	No Disclosures	
<b>Joe Gray, Ph.D.</b>	Consultant	GSK, Pfizer, Roche (preclinical only)
	Grant/Research Support	GSK, Pfizer, Roche, Millennium and Progen
	Other	Royalties from Abbott
<b>Dawn Hershman, M.D.</b>	No Disclosures	
<b>James Hicks, Ph.D.</b>	Consultant	Gene Prognostics
<b>Johanna Horn</b>	No Disclosures	
<b>Gabriel Hortobagyi, M.D.</b>	Consultant	Novartis, Allergan, Merck, Genentech and Sanofi-Aventis
	Research Grant	Novartis
<b>Gregory Kalemkerian, M.D.</b>	Grant/Research Support	Pfizer and Lilly
<b>Robert Krouse, M.D.</b>	No Disclosures	

<b>Razelle Kurzrock, M.D.</b>	Research Grant	Abraxis, Amgen, Amplimed, Antigenics, AstraZeneca, Bayer, BMS, Callisto, Centocor, Concordia, Curagen, Eisai, Eli Lilly, Enzon, Exelixis, Genentech, GSK, Globomax, Hoffman La-Roche, Kinex, Merck, Metastatix, MGI, Myriad, Nereus, NIH, Novartis, Pfizer, Pharmacyclics, pharmion, phoenix, Biotech, Reata, Taiho, Vioquest and Ziopharm
	Honoraria	Amgen, AstraZeneca, CBCE, Genentech, Enzon, IDSC, ImClone, Johnson&Johnson, Maxygen, Merck, pharmion and Roche
	Consultant	AstraZeneca, Centocor, Johnson&Johnson, Maxygen and Merck
<b>JoAnn Manson, M.D., Dr.PH.</b>	No Disclosures	
<b>Frank Meyskens, Jr., M.D.</b>	Co-Founder	Cancer Prevention Pharmaceuticals
<b>David McConkey, Ph.D.</b>	Grant/Research Support	AstraZeneca
	Stock Shareholder	Apocell, Inc.
<b>Carol Moinpour, Ph.D.</b>	No Disclosures	
<b>Paul Okunieff, M.D.</b>	No Disclosures	
<b>Robert Orlowski, M.D.</b>	Consultant	Celgene, Centocor, Cephalon, Millennium, Onyx and Novartis
	Research Grant	Celgene and Millennium
<b>David Ota, M.D.</b>	Grant/Research Support	Novartis, Sanofi-Aventis, Pfizer, ValleyLab, Oncura, OSI, Amgen, and Covidien
<b>Vassiliki Papadimitrakopoulou, M.D.</b>	Consultant	Amgen, GlaxoSmithKline
	Grant/Research Support	Merck, Bayer-Onyx, AstraZeneca, Novartis and Astellas
<b>Mary Redman, Ph.D.</b>	No Disclosures	
<b>Antoni Ribas, M.D.</b>	Consultant	Roche-Genentech, Merck and Amgen
<b>Regina Santella, Ph.D.</b>	No Disclosures	
<b>Kathryn Schmitz</b>	No Disclosures	
<b>Anne Schott, M.D.</b>	No Disclosures	
<b>Veena Shankaran, M.D.</b>	No Disclosures	
<b>Vernon Sondak, M.D.</b>	Consultant	Merck (Schering), Pfizer, BMS/Medarex, Bayer/Onyx, GlaxoSmithKline/Synta, Abbott, and Eli Lilly
	Speaker's Bureau	Merck/Schering
<b>Raffaella Sordella, Ph.D.</b>	No Disclosures	
<b>Dana Sparks</b>	No Disclosures	
<b>Cathy Tangen, Dr.PH.</b>	No Disclosures	
<b>Rahber Thariani, Ph.D.</b>	No Disclosures	
<b>Ian Thompson, M.D.</b>	Consultant	Ferring Pharmaceuticals
<b>Courtney Wille</b>	No Disclosures	
<b>Song Yao, Ph.D.</b>	No Disclosures	
<b>George Yoo, M.D.</b>	No Disclosures	
<b>Jason Zell, D.O., M.P.H.</b>	No Disclosures	

# SCHEDULE OF EVENTS

## WEDNESDAY, OCTOBER 12, 2011

**4:00 p.m. - 7:00 p.m.**  
**Hill Country Level**  
 Room: Blanco

Nursing Committee Executive Meeting (Committee Members Only)

**Note:** This activity has been planned and implemented in accordance with the Essential Areas and Policies of the Accreditation Council for Continuing Medical Education (ACCME) through the joint sponsorship of Wayne State University School of Medicine, Karmanos Cancer Institute and SWOG. The Wayne State School of Medicine is accredited by the ACCME to provide continuing medical education for physicians.

The Wayne State School of Medicine designates this live activity for a maximum of 23.00 **AMA PRA Category 1 Credits™**. Physicians should only claim credit commensurate with the extent of their participation in the activity.

**NOTE: Gray Areas Indicate Workshops  
 Bolded Meetings Receive CME Credits**

## THURSDAY, OCTOBER 13, 2011

Group Meeting Registration & Information Desk  
 7:00 a.m. - 5:00 p.m. - Los Rios Foyer

Hope Foundation Information Desk  
 8:00 a.m. - 5:00 p.m. - Los Rios Foyer

Exhibits & Complimentary Coffee Service  
 8:00 a.m. - 4:00 p.m. - Rio Grande Foyer

**7:30 a.m. – 9:30 a.m.**  
**Ballroom Level**  
 Room: Rio Grande Center

Head Clinical Research Associates (Open to Member, Affiliate and CCOP Head CRAs Only)

**8:00 a.m. – 8:45 a.m.**  
**Ballroom Level**  
 Room: Regency East Foyer

Jeri and Noboru Oishi Nurse Oncologist Symposium Check-In

**8:30 a.m. – 8:45 a.m.**  
 Room: Regency East #1 & #2

New Nurse Committee Orientation / Business Meeting (Open Session)

**8:45 a.m. – 12:00 p.m.**  
 Room: Regency East #1 & #2

Jeri and Noboru Oishi Nurse Oncologist Symposium (Open Session)

**12:30 p.m. – 1:30 p.m.**  
**Lobby Level**  
 Room: Chula Vista

Nursing Committee Special Session A: Education & Program Subcommittee

**1:30 p.m. – 2:30 p.m.**  
**Lobby Level**  
 Room: Chula Vista

Nursing Committee Special Session B: QOL Coordinators / Disease & Discipline and Research Subcommittee

# SCHEDULE OF EVENTS

## THURSDAY, OCTOBER 13, 2011

Group Meeting Registration & Information Desk  
7:00 a.m. - 5:00 p.m. - Los Rios Foyer

Hope Foundation Information Desk  
8:00 a.m. - 5:00 p.m. - Los Rios Foyer

Exhibits & Complimentary Coffee Service  
8:00 a.m. - 4:00 p.m. - Rio Grande Foyer

**8:00 a.m. – 10:00 a.m.**  
***Hill Country Level***  
Room: Live Oak  
Cancer Control and Prevention Executive Council (Committee Members Only)

**8:00 a.m. – 11:00 a.m.**  
***Hill Country Level***  
Room: Pecan  
Advocates Committee Meeting (Committee Members Only)

**10:15 a.m. – 12:15 p.m.**  
***Ballroom Level***  
Room: Rio Grande Center  
**MOLECULAR EPIDEMIOLOGY COMMITTEE**

**12:00 p.m. – 2:00 p.m.**  
***Hill Country Level***  
Room: Mesquite  
Quality Initiative Meeting (Committee Members Only)

**12:45 p.m. – 2:45 p.m.**  
***Hill Country Level***  
Room: Live Oak  
**SYMPTOM CONTROL AND QUALITY OF LIFE COMMITTEE**

**1:00 p.m. – 4:00 p.m.**  
***Ballroom Level***  
Room: Regency East #1 & #2  
Clinical Research Associates Plenary Session

**2:30 p.m. – 4:30 p.m.**  
***Hill Country Level***  
Room: Frio  
Hope Foundation Annual Board Meeting (Committee Members Only)

**3:15 p.m. – 5:15 p.m.**  
***Hill Country Level***  
Room: Live Oak  
**PREVENTION COMMITTEE**

**3:30 p.m. – 4:30 p.m.**  
***Ballroom Level***  
Room: Regency Center  
**EARLY THERAPEUTICS COMMITTEE**

**4:00 p.m. – 6:00 p.m.**  
***Hill Country Level***  
Room: Mesquite  
Conflict of Interest Committee (Committee Members Only)

**4:15 p.m. – 6:00 p.m.**  
***Ballroom Level***  
Room: Rio Grande Ballroom  
Clinical Research Associates Open Forum

**5:30 p.m. – 7:00 p.m.**  
Hope Foundation Platinum Reception (Invitation Only)

**5:30 p.m. – 7:30 p.m.**  
***Ballroom Level***  
Room: Regency West  
**OUTCOMES & COMPARATIVE EFFECTIVENESS COMMITTEE**

**7:00 p.m. – 9:00 p.m.**  
***Lobby Level***  
Room: Chula Vista  
Scientific Leaders Advisory Session (Invitation Only)

**NOTE: Bolded Meetings Receive CME Credits**

# SCHEDULE OF EVENTS

## FRIDAY, OCTOBER 14, 2011

Group Meeting Registration & Information Desk  
7:30 a.m. - 5:00 p.m. - Los Rios Foyer

Hope Foundation Information Desk  
8:00 a.m. - 5:00 p.m. - Los Rios Foyer

Exhibits & Complimentary Coffee Service  
7:00 a.m. - 12:00 p.m.; 2:45 p.m. - 4:00 p.m. - Rio Grande Foyer

**7:30 a.m. – 9:30 a.m.**      **BARLOGIE-SALMON  
MYELOMA COMMITTEE**  
*Ballroom Level*  
Room: Rio Grande West/Center

**7:30 a.m. – 9:30 a.m.**      **MELANOMA COMMITTEE**  
*Ballroom Level*  
Room: Regency East #1 & #2

**7:30 a.m. – 9:45 a.m.**      **CANCER SURVIVORSHIP  
COMMITTEE**  
*Ballroom Level*  
Room: Rio Grande East

**8:00 a.m. – 11:00 a.m.**      Clinical Research Associates  
*Ballroom Level*                  Continuing Education Workshop  
Room: Regency East #3

**9:30 a.m. – 10:30 a.m.**      Professional Review Committee  
*Hill Country Level*              Meeting (Committee Members  
Room: Mesquite                  Only)

**9:30 a.m. – 11:00 a.m.**      Quality Assurance Committee  
*Ballroom Level*                  Meeting (Committee Members  
Room: Medina                  Only)

**10:00 a.m. – 11:30 a.m.**      Bone Marrow & Stem Cell  
*Hill Country Level*              Transplantation Committee  
Room: Blanco/Llano/Pecos

**NOTE: Bolded Meetings Receive CME Credits**

**10:00 a.m. – 12:00 p.m.**      **CANCER CONTROL AND  
PREVENTION OUTREACH**  
*Ballroom Level*                  (HARRY HYNES SYMPOSIUM)  
Room: Regency East #1 & #2

**10:00 a.m. – 12:00 p.m.**      **SURGERY COMMITTEE**  
*Hill Country Level*  
Room: Live Oak

**11:30 a.m. – 12:15 p.m.**      Plenary Reception (Light Hors  
*Ballroom Level*                  D'oeuvres)  
Room: Regency Foyer

**12:15 p.m. – 2:45 p.m.**      **PLENARY SESSION**  
*Ballroom Level*  
Room: Regency West

**3:00 p.m. – 5:00 p.m.**      Clinical Research Associates  
*Ballroom Level*                  Executive Committee  
Room: Medina                  (Committee Members Only)

**3:00 p.m. – 7:00 p.m.**      **LEUKEMIA COMMITTEE**  
*Ballroom Level*  
Room: Regency East #1 & #2

**3:15 p.m. – 7:00 p.m.**      **BREAST COMMITTEE**  
*Ballroom Level*  
Room: Regency West

**5:00 p.m. – 7:00 p.m.**      **GI COMMITTEE**  
*Ballroom Level*  
Room: Regency East #3

**5:00 p.m. – 8:00 p.m.**      SWOG Data & Safety Monitoring  
*Hill Country Level*              Committee (Committee Members  
Room: Frio                          Only)

**6:45 p.m. – 8:00 p.m.**      Reception  
*Ballroom Level*  
Room: Rio Grande Ballroom

**7:15 p.m. – 7:45 p.m.**      Mid-Career Investigator  
*Ballroom Level*                  Reception (Invitation Only)  
Room: Medina

# SCHEDULE OF EVENTS

## SATURDAY, OCTOBER 15, 2011

Group Meeting Registration & Information Desk  
7:30 a.m. - 12:30 p.m. - Los Rios Foyer

Hope Foundation Information Desk  
8:00 a.m. - 12:30 p.m. - Los Rios Foyer

- |  |  |
|--|--|
| <p><b>7:00 a.m. – 8:00 a.m.</b><br/><b><i>Ballroom Level</i></b><br/>Room: Rio Grande Center</p> | <p>Board of Governors (Board Members Only)</p>   |
| <p><b>8:15 a.m. – 9:30 a.m.</b><br/><b><i>Ballroom Level</i></b><br/>Room: Rio Grande Center</p> | <p>Committee Chairs (Committee Members Only)</p> |
| <p><b>10:15 a.m. – 11:45 a.m.</b><br/><b><i>Hill Country Level</i></b><br/>Room: Mesquite</p>    | <p>Pharmaceutical Sciences Committee</p>         |
| <p><b>10:30 a.m. – 11:30 a.m.</b><br/><b><i>Hill Country Level</i></b><br/>Room: Live Oak</p>    | <p>Clinical Practices Committee</p>              |
| <p><b>10:30 a.m. – 12:00 p.m.</b><br/><b><i>Hill Country Level</i></b><br/>Room: Pecan</p>       | <p><b>RADIATION THERAPY COMMITTEE</b></p>        |
| <p><b>11:30 a.m. – 3:00 p.m.</b><br/><b><i>Ballroom Level</i></b><br/>Room: Regency West</p>     | <p><b>GU COMMITTEE</b></p>                       |
| <p><b>11:30 a.m. – 3:30 p.m.</b><br/><b><i>Ballroom Level</i></b><br/>Room: Regency Center</p>   | <p><b>LUNG COMMITTEE</b></p>                     |
| <p><b>11:30 a.m. – 3:30 p.m.</b><br/><b><i>Ballroom Level</i></b><br/>Room: Regency East</p>     | <p><b>LYMPHOMA COMMITTEE</b></p>                 |

**NOTE: Bolded Meetings Receive CME Credits**

# Roster of Committee Speakers

**Thursday, October 13, 2011**

**Molecular Epidemiology Committee, 10:15 a.m. - 12:15 p.m. - Rio Grande Center**

**African ancestry and aggressive breast cancer: a potential role of vitamin D** - Song Yao, Ph.D., Roswell Park Cancer Institute

**Symptom Control & Quality of Life Committee, 12:45 p.m. - 2:45 p.m. - Live Oak**

**Exercise Interventions During Curative Cancer Care: Benefits, Barriers and Opportunities** - Kathryn H. Schmitz, Ph.D., M.P.H., Center for Clinical Epidemiology and Biostatistics, University of Pennsylvania School of Medicine and Abramson Cancer Center

**Prevention Committee, 3:15 p.m. - 5:15 p.m. - Live Oak**

**Vitamin D in the Prevention of Cancer and Cardiovascular Disease: A Critical Appraisal** - JoAnn E. Manson, M.D., Dr.PH.

**Outcomes and Comparative Effectiveness Committee, 5:30 p.m. - 7:30 p.m. - Regency West**

**Risk Factors for Financial Hardship in Colon Cancer Patients** - Veena Shankaran, M.D., Seattle Cancer Care Alliance

**A Sero-Epidemiologic Survey of HIV and Hepatitis B/C in Cancer Patients in the US** - Mary Redman, Ph.D., SWOG Statistical Center, Fred Hutchinson Cancer Research Center

**Center for Comparative Effectiveness Research in Cancer Genomics (CANCERGEN): Progress and Updates** - Rahber Thariani, Ph.D., University of Washington School of Pharmacy

**Update on S1105, "Randomized Trial of Text-Messaging Intervention to Reduce Early Discontinuation of Adjuvant Aromatase Inhibitor Therapy in Women with Early Stage Breast Cancer"** - Dawn Hershman, M.D., Co-Chair Outcomes and Comparative Effectiveness Committee

**Friday, October 14, 2011**

**Melanoma Committee, 7:30 a.m. - 9:30 a.m. - Regency East #1 & #2**

**The last 20 years and SWOG's role in the evolution of the management of melanoma** - Vernon K. Sondak, M.D., Moffitt Cancer Center

**Metastatic melanoma in 2011: Breakthroughs and opportunities for improvement** - Antoni Ribas, M.D., UCLA

# Roster of Committee Speakers

## **Cancer Survivorship Committee, 7:30 a.m. - 9:45 a.m. - Rio Grande East**

**Increasing Strength and Physical Activity for Cancer Prevention and Survivorship - The Evolution and Reversal of a Sedentary Lifestyle** - Kathryn H. Schmitz, Ph.D., M.P.H., Center for Clinical Epidemiology and Biostatistics, University of Pennsylvania School of Medicine and Abramson Cancer Center

## **Harry E. Hynes CCOP Symposium, 10:00 a.m. - 12:00 p.m. - Regency East #1 & #2**

**Vitamin D and Human Health: A Critical Appraisal of the Evidence** - JoAnn E. Manson, M.D., Dr.PH.

**Solar Radiation and Cancer: a two edge sword?** - Marianne Berwick, Ph.D., M.P.H., Univ of New Mexico

**Aromatase Inhibitors: Improving Adherence and Reducing Toxicities** - Dawn Hershman, M.D., M.S.

## **Surgery Committee, 10:00 a.m. - 12:00 p.m. - Live Oak**

**Update: S0820, "A Double Blind Placebo-Controlled Trial of Eflornithine and Sulindac to Prevent Recurrence of Colorectal Cancers and Adenomas in Patients with Stage I-III Colon Cancer, Phase III"**

- Jason Zell, D.O., M.P.H., Assistant Professor, Dept. of Epidemiology and Division of Hematology/Oncology, Dept. of Medicine Cancer Prevention Program, Chao Family Comprehensive Cancer Center, University of California, Irvine

**Surgeons in the New Cooperative Groups** - David Ota, M.D., Duke University

## **Breast Committee, 3:15 p.m. - 7:00 p.m. - Regency West**

**Next Generation Sequencing: Where Can SWOG Get Involved?** - Joe Gray, Ph.D., University of Oregon Health Center

## **GI Committee, 5:00 p.m. - 7:00 p.m. - Regency East #3**

**Cancer Survivorship Committee** - Robert S. Krouse, M.D., Committee Co-Chair

## **Saturday, October 15, 2011**

## **GU Committee, 11:30 a.m. - 3:00 p.m. - Regency West**

**Use of Molecular Markers in Clinical Trials** - David J. McConkey, Ph.D., Chair, GU Translational Medicine Subcommittee

**Evidence Needed for Prognostic and Predictive Factors: A Statistical Perspective** - Cathy M. Tangen, Dr. P.H., GU Biostatistician

## **Lung Committee, 11:30 a.m. - 3:30 p.m. - Regency Center**

**BATTLE-2: A Multi-Arm, Adaptive Randomization, Biomarker-Driven, Clinical Trial Program for Refractory NSCLC** - Vassiliki Papadimitrakopoulou, M.D., MD Anderson Cancer Center

**Cancer Stem Cell-Directed Therapy in Lung Cancer** - Gregory Kalemkerian, M.D., University of Michigan

## **SWOG ADMINISTRATIVE COMMITTEES**

### **Board of Governors**

Chair: Laurence H. Baker, D.O.

### **Bone Marrow and Stem Cell Transplantation Committee**

Chair: Stephen J. Forman, M.D.

### **Clinical Practices Committee**

Chair: Saul E. Rivkin, M.D.

### **Clinical Research Associates (CRA) Committee**

Chair: Susan A. Majeski, C.C.R.P.

### **Conflict of Interest Committee**

Chair: Vernon K. Sondak, M.D.

### **Membership Committee**

Chair: James K. Weick, M.D.

### **Nursing Committee**

Chair: Rose B. Ermete, R.N., B.S.N.

### **Pharmaceutical Sciences Committee**

Chair: Siu-Fun Wong, Pharm.D.

### **Professional Review Committee**

Chair: Primo N. Lara, Jr., M.D.

### **Quality Assurance Committee**

Chair: Manuel Valdivieso, M.D.

### **Radiation Therapy Committee**

Chair: Paul Okunieff, M.D.

### **Surgery Committee**

Chair: George H. Yoo, M.D.

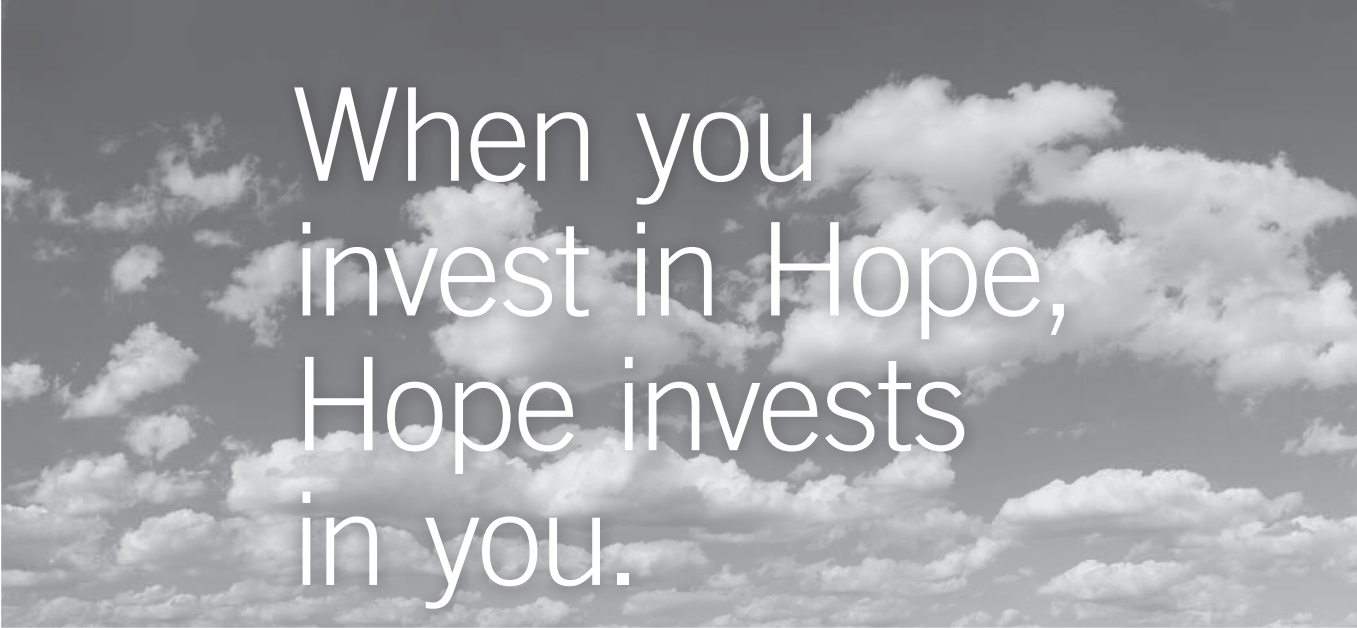

When you  
invest in Hope,  
Hope invests  
in you.

We invest because your work is invaluable to SWOG and to our common mission of preventing and treating cancer.

**All investors will be entered to win up to \$10,000 in outstanding prizes at the SWOG Reception on Friday, October 14 at 6:45pm, Rio Grande Ballroom, The Hyatt Regency San Antonio.**

Entries must be received by 12:00 pm on October 14, 2011.  
Entrants must be present to win.

The Hope Foundation, a nonprofit organization, is the philanthropic arm of SWOG, and accepts investments from individuals, corporations and foundations. In support of SWOG's mission to eradicate cancer, 93% of all contributions are directly invested in programming.

## THE HOPE FOUNDATION

---

*Because answers to cancers come from clinical trials*

**Hope Foundation Information Desk: Los Rios Foyer, Ballroom Level, Thursday - Saturday**

**Johanna (Jo) Horn, Executive Director** | [jo@thehopefoundation.org](mailto:jo@thehopefoundation.org) | 734-998-7150 | [www.thehopefoundation.org](http://www.thehopefoundation.org)

# Special Symposia

## **Clinical Research Associates Open Forum**

**Thursday, October 13, 2011 - 4:15 p.m. - 6:00 p.m.**

**Location: Rio Grande Ballroom (Ballroom Level)**

**Topic:** This forum offers an opportunity to get answers to your clinical trial questions and address the science and technical research issues that challenge us today.

### **Featured Topics:**

- Quality Assurance Audits & SAE Reporting
- The Wild World of Regulatory Affairs
- Data Management Tips & Tools for CRAs
- Cancer Treatment Modalities - Q & A
- Specimen Preparation and Shipment
- SWOG Federal & CTI Non-Federal Reimbursement
- Head CRA Perspective
- SWOG Nursing Committee

---

## **Jeri and Noboru Oishi Nurse Oncologist Symposium**

**Thursday, October 13, 2011 - 8:45 a.m. - 12:00 p.m.**

**Location: Regency East #1 and #2 (Ballroom Level)**

**Topic: Navigating Reform: Resources and Assistance Programs for Cancer Patients**

### **Featured Speakers:**

- Healthcare Reform and Research Billing - Ryan D. Meade, J.D.
- Information & Resources for Cancer-Related Legal Issues - Shawn Kravich, Esq.
- Patient Assistance Programs for Drug Coverage - Jessie Modlin, Pharm.D.

Certificates for continuing education credits (CEUs) will be distributed to attendees upon completion and return of their evaluation sheets. Certificates of attendance will be given for Society of Clinical Research Associates.

This activity has been submitted to the Oncology Nursing Society for approval to award contact hours. ONS is accredited as an approver of continuing nursing education by the American Nurses Credentialing Center's COA.

# Special Symposia

## **Surgery Committee**

**Friday, October 14, 2011 - 10:00 a.m. - 12:00 p.m.**

**Location: Live Oak (Hill Country Level)**

**Topic: Surgeons in the New Cooperative Groups**

### **Featured Speakers:**

- **Update: S0820, "A Double Blind Placebo-Controlled Trial of Eflornithine and Sulindac to Prevent Recurrence of Colorectal Cancers and Adenomas in Patients with Stage I-III Colon Cancer, Phase III"**  
Jason Zell, D.O., M.P.H., Assistant Professor, Dept. of Epidemiology, and Division of Hematology/Oncology, Dept. of Medicine Cancer Prevention Program, Chao Family Comprehensive Cancer Center, University of California, Irvine
- **Surgeons in the New Cooperative Groups**  
David Ota, M.D., Duke University

---

## **CRA Continuing Education Workshop**

**Friday, October 14, 2011 - 8:00 a.m. - 11:00 a.m.**

**Location: Regency East #3 (Ballroom Level)**

**Topic: GI Malignancies**

### **Featured Speakers:**

- **MedOnc Overview of Hepatobiliary Carcinoma** - Christopher Lieu, M.D., Assistant Professor, University of Colorado Anschutz Medical Campus
- **MedOnc Overview of Pancreatic Carcinoma** - Philip A. Philip, M.D., GI Oncology, Karmanos Cancer Center
- **QOL Portfolio and GI Committee Initiatives** - James L. Wade, III, M.D. - Co-Chair Symptom Control and Quality of Life Committee, Cancer Care Specialists, Decatur, Illinois
- **RT and Pancreatic and Hepatobiliary Carcinomas** - Edgar Ben-Josef, M.D., Department of Radiation Oncology, University of Michigan
- **Revised SAE Reporting Criteria** - TBD



**Accrual by Institution**  
**All Initial Registrations (Excluding Correlatives)**  
**July 1, 2010 - June 30, 2011**

MEMBERS/AFFILIATES	SWOG Treatment	SWOG Endorsed/ non-SWOG Intergroup	Cancer Control & Prevention	Total
<b>Arizona, U of (3009)</b>	<b>22</b>	<b>3</b>	<b>0</b>	<b>25</b>
<b>Arkansas, U of (101)</b>	<b>9</b>	<b>5</b>	<b>0</b>	<b>14</b>
Highlands Onc Group (10885)	6	1	0	7
MD Anderson, Florida (10955)	5	1	0	6
NEA Baptist Mem Hosp (11728)	6	0	1	7
Sacred Heart Med Onc (10549)	0	1	2	3
<b>BAMC/WHMC (10330)</b>	<b>0</b>	<b>1</b>	<b>0</b>	<b>1</b>
Eisenhower Army MC (10564)	0	0	1	1
Madigan Army Med Ctr (11460)	4	2	0	6
S Georgia Med Ctr (10807)	2	0	1	3
<b>Baylor College (11988)</b>	<b>14</b>	<b>11</b>	<b>0</b>	<b>25</b>
<b>Boston Univ Med Ctr (10635)</b>	<b>7</b>	<b>4</b>	<b>0</b>	<b>11</b>
<b>Cincinnati MC, U of (10509)</b>	<b>5</b>	<b>2</b>	<b>0</b>	<b>7</b>
Good Samaritan Hosp (11488)	1	0	0	1
<b>City of Hope Med Ctr (10082)</b>	<b>9</b>	<b>5</b>	<b>0</b>	<b>14</b>
<b>Cleveland Clinic OH (301)</b>	<b>27</b>	<b>15</b>	<b>10</b>	<b>52</b>
Akron Gen Med Ctr (8217)	0	2	2	4
Mansfield Gen Hosp (10934)	1	1	1	3
Mid Illinois Hem Onc (10679)	0	1	0	1
Our Lady, Bellefonte (10960)	1	0	3	4
<b>Colorado, U of (10120)</b>	<b>26</b>	<b>19</b>	<b>0</b>	<b>45</b>
Mem Hosp, Co Springs (10436)	1	2	0	3
Poudre Valley Hosp (11190)	3	3	0	6
<b>Columbia University (10769)</b>	<b>4</b>	<b>12</b>	<b>2</b>	<b>18</b>
Nyack Hospital (11412)	0	1	0	1
Orange Reg Med Ctr (10889)	6	2	0	8
St Luke's-Roosevelt (10892)	3	2	0	5
Valley Hospital (10926)	0	6	0	6
Winthrop - Univ Hosp (11492)	0	1	0	1
<b>Davis, U of CA (10176)</b>	<b>44</b>	<b>28</b>	<b>14</b>	<b>86</b>
California Ca Ctr (10733)	1	1	0	2
Lahey Clinic Med Ctr (15003)	13	5	0	18
Loma Linda Univ (10682)	10	4	0	14
NorthBay Med Ctr (10180)	0	2	0	2

SWOG and SWOG Endorsed registrations count toward MEM and Affiliate minimum accrual requirements.

**Accrual by Institution**  
**All Initial Registrations (Excluding Correlatives)**  
**July 1, 2010 - June 30, 2011**

	SWOG Treatment	SWOG Endorsed/ non-SWOG Intergroup	Cancer Control & Prevention	Total
St Elizabeth's MC (11173)	2	10	1	13
Sutter Hlth CRG-East (10712)	4	0	4	8
Sutter Hlth Western (10714)	7	1	0	8
<b>Fox Chase Cancer Ctr (13926)</b>	<b>3</b>	<b>0</b>	<b>0</b>	<b>3</b>
<b>H Lee Moffitt CC (11898)</b>	<b>9</b>	<b>13</b>	<b>0</b>	<b>22</b>
Broward Gen Med Ctr (11938)	0	3	0	3
Leesburg Reg Med Ctr (14513)	1	2	0	3
Martin Memorial CC (11941)	1	1	0	2
North Broward MC (11939)	0	0	1	1
St Joseph's/Candler (11980)	5	7	0	12
Watson Clinic Center (11935)	0	4	0	4
<b>Harrington CC (11446)</b>	<b>1</b>	<b>6</b>	<b>6</b>	<b>13</b>
<b>Henry Ford Hosp (501)</b>	<b>5</b>	<b>4</b>	<b>1</b>	<b>10</b>
Breslin Cancer Ctr (10415)	0	0	3	3
<b>Irvine, U of CA (10498)</b>	<b>12</b>	<b>4</b>	<b>0</b>	<b>16</b>
Glendale Mem Hosp (11581)	0	2	1	3
Long Beach Mem MC (10617)	1	0	0	1
Northridge Hosp (11580)	1	0	0	1
Presbyterian Hosp (11524)	0	6	0	6
St Jude Medical Ctr (11553)	1	1	0	2
<b>KaiserPermanenteNCAL (13655)</b>	<b>18</b>	<b>23</b>	<b>29</b>	<b>70</b>
KaiserPermanenteCOL (15184)	0	5	1	6
KaiserPermanenteSCAL (15468)	0	1	0	1
<b>Kansas, U of (3004)</b>	<b>38</b>	<b>20</b>	<b>0</b>	<b>58</b>
Good Samaritan Hosp (10628)	0	1	0	1
Stormont-Vail Health (10496)	8	9	0	17
<b>Kentucky, U of (10012)</b>	<b>22</b>	<b>6</b>	<b>0</b>	<b>28</b>
<b>Lahey Clinic Med Ctr (16037)</b>	<b>0</b>	<b>1</b>	<b>0</b>	<b>1</b>
<b>Loyola University (10080)</b>	<b>29</b>	<b>27</b>	<b>2</b>	<b>58</b>
Edward Hospital (12848)	10	2	3	15
Hem-Onc Consultants (10616)	2	3	0	5
Quad Cities/Genesis (10424)	0	2	0	2
<b>MD Anderson (11439)</b>	<b>79</b>	<b>7</b>	<b>0</b>	<b>86</b>
<b>MUSC, Hollings CC (11421)</b>	<b>15</b>	<b>16</b>	<b>0</b>	<b>31</b>
Lexington Med Ctr (12448)	0	4	0	4

SWOG and SWOG Endorsed registrations count toward MEM and Affiliate minimum accrual requirements.



**Accrual by Institution**  
**All Initial Registrations (Excluding Correlatives)**  
**July 1, 2010 - June 30, 2011**

	SWOG Treatment	SWOG Endorsed/ non-SWOG Intergroup	Cancer Control & Prevention	Total
<b>Michigan, U of (4700)</b>	<b>42</b>	<b>8</b>	<b>15</b>	<b>65</b>
<b>Mississippi, Univ of (3012)</b>	<b>7</b>	<b>3</b>	<b>2</b>	<b>12</b>
Keesler USAF Med Ctr (8307)	0	1	0	1
NE Alabama Reg MC (12075)	2	0	0	2
NE Georgia Med Ctr (11339)	7	2	0	9
Singing River Hosp (12057)	5	4	1	10
St Joseph Hospital (11546)	0	2	0	2
<b>Oregon Hlth Sci Univ (4100)</b>	<b>2</b>	<b>4</b>	<b>0</b>	<b>6</b>
Good Samaritan Hosp (14039)	2	3	1	6
Salem Hospital (8167)	2	1	0	3
<b>Providence Hosp (3500)</b>	<b>8</b>	<b>8</b>	<b>4</b>	<b>20</b>
<b>Puget Sound (3007)</b>	<b>20</b>	<b>16</b>	<b>5</b>	<b>41</b>
Bay Area Hospital (11340)	0	1	1	2
Cancer Care NW (11313)	6	1	0	7
Columbia Basin Hem (12626)	2	0	0	2
Evergreen Hem & Onc (14031)	1	0	0	1
Harrison Bremerton (11548)	2	2	0	4
Minor & James Med (12135)	0	2	0	2
Rockwood Clinic, PS (11435)	0	1	0	1
Skagit Valley Hosp (10666)	4	2	1	7
St Charles Med Ctr (10359)	4	6	1	11
St Joseph Hospital (10023)	2	1	0	3
St Mary Med Ctr (11450)	1	0	0	1
Yakima Valley Mem (10620)	1	1	2	4
<b>Rochester, Univ of (11400)</b>	<b>38</b>	<b>6</b>	<b>0</b>	<b>44</b>
Arnot Ogden Med Ctr (13424)	1	0	0	1
Finger Lakes Hem/Onc (11408)	0	2	0	2
Highland Hospital (11409)	0	1	0	1
Interlakes Foundatn (11547)	3	0	0	3
<b>San Antonio, U of TX (2400)</b>	<b>35</b>	<b>13</b>	<b>0</b>	<b>48</b>
SW Cancer & Res Ctr (8215)	2	0	0	2
Schumpert Med Ctr (10398)	0	1	0	1
Sinai Hospital (11184)	12	0	0	12
Thompson Ca Surv Ctr (10427)	7	7	0	14
<b>So Calif, U of (10138)</b>	<b>24</b>	<b>29</b>	<b>11</b>	<b>64</b>

SWOG and SWOG Endorsed registrations count toward MEM and Affiliate minimum accrual requirements.

**Accrual by Institution**  
**All Initial Registrations (Excluding Correlatives)**  
**July 1, 2010 - June 30, 2011**

	SWOG Treatment	SWOG Endorsed/ non-SWOG Intergroup	Cancer Control & Prevention	Total
Desert Hospital (11205)	6	8	0	14
St Joseph Med Ctr (10283)	3	7	0	10
<b>St Louis University (10357)</b>	<b>3</b>	<b>4</b>	<b>0</b>	<b>7</b>
Christian Hosp NE/NW (11878)	0	1	0	1
<b>Stanford University (12661)</b>	<b>1</b>	<b>15</b>	<b>0</b>	<b>16</b>
<b>Tennessee, U of (11441)</b>	<b>7</b>	<b>13</b>	<b>0</b>	<b>20</b>
<b>Tulane University (1801)</b>	<b>1</b>	<b>3</b>	<b>0</b>	<b>4</b>
<b>Univ of Chicago MC (13924)</b>	<b>4</b>	<b>0</b>	<b>0</b>	<b>4</b>
<b>Univ of Maryland (15076)</b>	<b>1</b>	<b>0</b>	<b>0</b>	<b>1</b>
<b>Utah, U of (2501)</b>	<b>21</b>	<b>7</b>	<b>0</b>	<b>28</b>
McKay-Dee Hospital (8082)	5	1	0	6
Portneuf Medical Ctr (8278)	0	1	0	1
St Luke's Mt State (8081)	6	7	0	13
<b>Wayne State Univ (2701)</b>	<b>33</b>	<b>24</b>	<b>0</b>	<b>57</b>
MidMichigan Med Ctr (11812)	0	1	0	1
Mt Clemens Reg MC (10058)	3	0	0	3
Univ of Louisville (11293)	0	8	0	8
<b>Member &amp; Affiliate Total</b>	<b>840</b>	<b>562</b>	<b>133</b>	<b>1535</b>
<b>CCOPS/MBCCOPS</b>				
Atlanta Reg CCOP (10225)	11	21	5	37
Bay Area CCOP (10706)	7	0	2	9
Beaumont CCOP (11434)	3	19	5	27
Central IL CCOP (10211)	63	13	4	80
Columbia River CCOP (10251)	15	1	1	17
Columbus CCOP (9005)	24	15	1	40
Dayton CCOP (9006)	29	6	1	36
Grand Rapids CCOP (9007)	19	2	5	26
Greenville CCOP (10879)	20	12	8	40
Gulf Coast MBCCOP (11370)	5	3	0	8
Hawaii MBCCOP, U of (10781)	19	23	3	45
Kansas City CCOP (9010)	26	7	0	33
LSU-New Orleans CCOP (10816)	8	4	1	13
LSU-Shreveport CCOP (13521)	13	9	3	25
Michigan CRC CCOP (11110)	64	3	18	85
Montana CCOP (10891)	22	9	1	32

SWOG and SWOG Endorsed registrations count toward MEM and Affiliate minimum accrual requirements.

**Accrual by Institution**  
**All Initial Registrations (Excluding Correlatives)**  
**July 1, 2010 - June 30, 2011**

	SWOG Treatment	SWOG Endorsed/ non-SWOG Intergroup	Cancer Control & Prevention	Total
New Mexico MBCCOP (11331)	20	3	11	34
Northwest CCOP (9016)	10	14	9	33
Ozarks Reg CCOP (10210)	29	5	6	40
Scott & White CCOP (10940)	6	6	0	12
Southeast CCC CCOP (11108)	60	8	16	84
Southern Nevada CCOP (13500)	18	0	1	19
St Louis CCOP (9015)	12	3	9	24
Upstate Carolina (10122)	16	6	1	23
Virginia Mason CCOP (9011)	4	5	5	14
Wichita CCOP (9017)	66	20	15	101
<b>CCOP/MBCCOP Total</b>	<b>589</b>	<b>217</b>	<b>131</b>	<b>937</b>
<b>UCOPS</b>				
Baylor College-UCOP (10310)	8	0	0	8
Cleveland Clin-UCOP (10307)	1	0	0	1
Henry Ford-UCOP (10703)	4	0	0	4
LSU-Shreveport UCOP (10704)	3	0	0	3
Loyola Univ - UCOP (10298)	5	0	0	5
Michigan, U of-UCOP (11386)	11	0	0	11
Oklahoma, U of-UCOP (10788)	7	0	0	7
PSOC UCOP (10300)	1	0	0	1
So Calif, U of-UCOP (10312)	1	0	0	1
Urology Ctr of CO (13800)	2	0	0	2
Utah, U of - UCOP (10313)	3	0	0	3
<b>UCOP Total</b>	<b>46</b>	<b>0</b>	<b>0</b>	<b>46</b>
<b>FOREIGN</b>				
INCan (15434)	1	0	0	1
King Faisal Spec Hos (13697)	1	0	1	2
<b>Foreign Total</b>	<b>2</b>	<b>0</b>	<b>1</b>	<b>3</b>
<b>Other Groups</b>				
ACOSOG	6	0	0	6
CALGB	148	0	0	148
ECOG	191	0	13	204
IBCSG	0	0	16	16
NCCTG	128	0	0	128
NCIC-CTG	7	0	0	7

SWOG and SWOG Endorsed registrations count toward MEM and Affiliate minimum accrual requirements.

**Accrual by Institution  
All Initial Registrations (Excluding Correlatives)  
July 1, 2010 - June 30, 2011**

	<b>SWOG Treatment</b>	<b>SWOG Endorsed/ non-SWOG Intergroup</b>	<b>Cancer Control &amp; Prevention</b>	<b>Total</b>
NSABP	30	0	0	30
RTOG	23	0	0	23
<b>Other Groups Total</b>	<b>533</b>	<b>0</b>	<b>29</b>	<b>562</b>
<b>Grand Total</b>	<b>2010</b>	<b>779</b>	<b>294</b>	<b>3083</b>

SWOG and SWOG Endorsed registrations count toward MEM and Affiliate minimum accrual requirements.

**Accrual by Institution and Committee**  
**All Registrations (Excluding Correlatives)**  
**July 1, 2010 - June 30, 2011**

	Total	Breast	Cancer Control	ET	GI	GU	GYN	Leukemia	Lung	Lymphoma	Melanoma	Myeloma
Arizona, U of	25	2	-	-	1	-	7	-	6	7	2	-
Arkansas, U of	74	9	3	-	10	1	2	2	9	1	-	37
Atlanta Reg CCOP	37	17	5	-	4	-	-	1	8	-	2	-
BAMC/WHMC	13	6	1	-	1	3	-	-	-	-	-	2
Bay Area CCOP	9	3	2	-	1	-	3	-	-	-	-	-
Baylor College	25	-	-	-	7	7	-	3	1	-	-	7
Baylor College-UCOP	8	-	-	-	-	8	-	-	-	-	-	-
Beaumont CCOP	27	14	5	-	3	2	-	-	3	-	-	-
Boston Univ Med Ctr	11	-	-	-	8	1	-	-	-	-	1	1
Central IL CCOP	80	17	4	-	13	1	-	-	35	7	-	3
Cincinnati MC, U of	8	1	-	-	4	1	-	1	1	-	-	-
City of Hope Med Ctr	14	1	-	1	4	-	-	-	5	3	-	-
Cleveland Clinic OH	65	13	16	-	3	11	-	12	-	3	-	7
Colorado, U of	54	8	-	-	6	21	-	-	12	-	3	4
Columbia River CCOP	17	3	1	-	2	-	-	2	7	-	-	2
Columbia Univ-UCOP	3	-	-	-	-	3	-	-	-	-	-	-
Columbia University	36	14	2	-	4	9	-	-	2	2	-	3
Columbus CCOP	40	23	1	-	7	-	-	-	6	1	2	-
Davis, U of CA	153	30	19	1	16	18	6	4	53	3	-	3
Dayton CCOP	36	7	1	-	6	1	-	-	12	3	4	2
Fox Chase Cancer Ctr	3	-	-	-	-	-	3	-	-	-	-	-
Grand Rapids CCOP	26	5	5	-	1	2	-	-	6	2	5	-
Greenville CCOP	40	6	8	-	2	-	-	2	18	-	-	4
Gulf Coast MBCCOP	8	5	-	-	-	-	-	-	2	-	1	-
H Lee Moffitt CC	47	9	1	-	8	7	-	4	12	1	2	3
Harrington CC	13	-	6	-	2	-	-	-	1	3	-	1
Hawaii MBCCOP, U of	45	20	3	-	8	-	-	-	7	1	-	6
Henry Ford Hosp	28	2	4	4	-	4	-	-	3	-	-	11
INCan	1	-	-	-	-	-	-	-	1	-	-	-
Irvine, U of CA	29	3	1	-	13	-	1	2	7	-	1	1
KaiserPermanenteNCAL	77	11	30	-	10	2	-	-	12	1	1	10
Kansas City CCOP	34	12	-	-	8	-	-	1	5	-	3	5
Kansas, U of	78	19	-	-	11	12	-	-	29	3	1	3
Kentucky, U of	28	-	-	5	1	4	-	4	14	-	-	-
King Faisal Spec Hos	2	1	-	-	-	-	-	-	-	-	-	1
LSU-New Orleans CCOP	13	1	1	-	5	-	-	-	5	-	1	-
LSU-Shreveport CCOP	28	14	3	-	1	3	-	1	2	-	-	4
Lahey Clinic Med Ctr	1	-	-	-	-	-	-	-	1	-	-	-
Loyola University	90	32	5	-	10	15	1	8	7	3	2	7
MD Anderson	86	3	-	-	6	4	32	2	28	7	-	4
MUSC, Hollings CC	35	5	-	2	5	1	-	17	4	1	-	-
Michigan CRC CCOP	85	35	18	-	2	3	-	-	18	1	-	8
Michigan, U of	65	10	15	10	7	3	-	3	9	2	6	-
Michigan, U of-UCOP	11	-	-	-	-	11	-	-	-	-	-	-

*Affiliate Accrual Reported with Main Member Institution*

**Accrual by Institution and Committee**  
**All Registrations (Excluding Correlatives)**  
**July 1, 2010 - June 30, 2011**

	Total	Breast	Cancer Control	ET	GI	GU	GYN	Leukemia	Lung	Lymphoma	Melanoma	Myeloma
Mississippi, Univ of	36	17	3	-	6	4	-	2	3	-	-	1
Montana CCOP	32	7	-	-	5	1	3	-	10	2	2	2
New Mexico MBCCOP	34	8	11	5	1	-	-	6	1	1	-	1
Northwest CCOP	33	18	9	-	2	2	-	-	2	-	-	-
Oklahoma, U of-UCOP	7	-	-	-	-	7	-	-	-	-	-	-
Oregon Hlth Sci Univ	15	3	1	-	3	3	-	-	3	-	-	2
Ozarks Reg CCOP	40	8	6	-	2	1	18	-	5	-	-	-
Providence Hosp	20	6	4	-	4	-	-	2	2	-	-	2
Puget Sound	89	24	10	-	10	13	7	4	9	9	1	2
Rochester, Univ of	51	3	-	-	8	7	-	4	7	15	-	7
San Antonio, U of TX	77	15	-	12	3	25	-	1	8	-	3	10
Scott & White CCOP	12	-	-	2	6	-	-	-	4	-	-	-
So Calif, U of	92	33	9	2	27	10	3	-	3	-	-	5
Southeast CCC CCOP	84	10	16	-	8	2	4	1	20	1	5	17
Southern Nevada CCOP	19	1	1	-	3	3	1	-	2	-	1	7
St Louis CCOP	24	2	9	-	2	1	2	-	2	-	4	2
St Louis University	11	1	-	-	4	3	-	-	-	-	-	3
Stanford University	16	-	-	-	-	-	-	16	-	-	-	-
Tennessee, U of	20	7	-	-	3	1	-	2	6	1	-	-
Tulane University	4	3	-	-	-	-	1	-	-	-	-	-
Univ of Chicago MC	4	-	-	-	-	-	4	-	-	-	-	-
Univ of Maryland	1	-	-	-	-	-	1	-	-	-	-	-
Upstate Carolina	23	5	1	-	2	1	-	-	10	1	-	3
Urology Ctr of CO	2	-	-	-	-	2	-	-	-	-	-	-
Utah, U of	51	17	-	-	4	4	-	4	15	5	2	-
Virginia Mason CCOP	14	3	5	-	-	5	-	-	-	-	-	1
Wayne State Univ	69	19	-	-	19	-	-	4	19	2	1	5
Wichita CCOP	101	19	14	12	7	3	13	4	12	11	-	6
<b>SWOG Total</b>	<b>2,589</b>	<b>590</b>	<b>259</b>	<b>56</b>	<b>329</b>	<b>256</b>	<b>112</b>	<b>119</b>	<b>494</b>	<b>103</b>	<b>56</b>	<b>215</b>
ACOSOG	6	2	-	-	1	-	-	-	3	-	-	-
ANZ BCTG/ IBCSG	6	6	-	-	-	-	-	-	-	-	-	-
CALGB	148	40	-	-	24	-	-	4	31	39	-	10
ECOG	204	65	-	-	20	1	-	3	34	20	-	61
FSS/ IBCSG	10	10	-	-	-	-	-	-	-	-	-	-
NCCTG	128	51	-	-	17	-	-	-	33	6	-	21
NCIC-CTG	7	7	-	-	-	-	-	-	-	-	-	-
NSABP	30	19	-	-	3	-	-	-	4	1	-	3
RTOG	23	5	-	-	11	-	-	-	7	-	-	-
<b>Other Group Total</b>	<b>562</b>	<b>205</b>	<b>-</b>	<b>-</b>	<b>76</b>	<b>1</b>	<b>-</b>	<b>7</b>	<b>112</b>	<b>66</b>	<b>-</b>	<b>95</b>
<b>Grand Total</b>	<b>3,151</b>	<b>795</b>	<b>259</b>	<b>56</b>	<b>405</b>	<b>257</b>	<b>112</b>	<b>126</b>	<b>606</b>	<b>169</b>	<b>56</b>	<b>310</b>

*Affiliate Accrual Reported with Main member Institution*

# BARLOGIE-SALMON MYELOMA COMMITTEE

## Committee Leadership

Chair:	Robert Z. Orlowski, M.D., Ph.D.
Vice-Chair:	Brian G.M. Durie, M.D.
Executive Officer:	Harry P. Erba, M.D., Ph.D.
Statisticians:	John J. Crowley, Ph.D. Antje Hoering, Ph.D. Rachael Sexton, M.S.

## Scientific Leadership

Translational Medicine:	Joshua Epstein, D.Sc.
Radiation:	Srinivasan Vijayakumar, M.D.
Surgery:	J. Sybil Biermann, M.D.
Pathology:	Robert B. Lorschach, M.D., Ph.D.
Early Therapeutics:	Frits van Rhee, M.D., Ph.D.

## Designates

Clinical Research Associates:	Ellen Chase, B.S. Jeana N. Cromer, M.P.H.
CCOP Representative:	James D. Bearden, III, M.D.
Data Coordinators:	Jeri Jardine Laura Kingsbury Tracy Maher
Nurses:	Deborah Halk, R.N. Steven M. Burt, R.N.
Patient Advocate:	Robert A. Warriner, III, M.D.
Pharmaceutical Science:	Lara M. Au, Pharm.D. Holly O. Chan, Pharm.D.
Protocol Coordinator:	Sandi Fredette

## Time/Location

### Friday, October 14, 2011

Room: Rio Grande Center and West (Ballroom Level)  
7:30 a.m. – 9:30 a.m.

## Agenda

### Presentations

### Active Studies

- S0777, "A Randomized Phase III Trial of CC-5013 (Lenalidomide, NSC-703813) and Low Dose Dexamethasone (LLD) versus Bortezomib (PS-341, NSC-681239), Lenalidomide and Low Dose Dexamethasone (BLLD) for induction, in Patients with Previously Untreated Multiple Myeloma without an Intent for Immediate Autologous Stem Cell Transplant." Dr. Durie. Activated: 2/28/08.
- S0702, "A Prospective Observational Multicenter Cohort Study to Assess The Incidence of Osteonecrosis of the Jaw (ONJ) in

Cancer Patients with Bone Metastases Starting Zoledronic Acid Treatment." Dr. Van Poznak. Activated: 12/15/08.

- S0833, "Total Therapy 3 (TT3) for Newly Diagnosed Patients with Multiple Myeloma (MM): A Southwest Oncology Group Trial for Patients Aged < 65 Years ." Dr. Abidi. Activated: 3/1/11.
- CTN0702, "A Trial of Single Autologous Transplant with or without Consolidation Therapy versus Tandem Autologous Transplant with Lenalidomide Maintenance for Patients with Multiple Myeloma." Dr. Van Rhee. Activated: 3/15/10.
- E3A06, "Genomic and Immunology Studies for E3A06, Randomized Phase III Trial of Lenalidomide versus Observation Alone in Patients with Asymptomatic Smoldering Multiple Myeloma." Dr. Dhodapkar. Activated: 2/1/11.
- E4A08, "A Randomized Phase III Trial of Melphalan and Dexamethasone (MDex) versus Bortezomib, Melphalan and Dexamethasone (BMDex) for Untreated Patients with Systemic Light-chain (AL) Amyloidosis Ineligible for Autologous Stem-cell Transplantation." Dr. Zonder. Activated: 12/15/10.

### Closed Studies

- S0115, "A Phase II Trial Evaluating Modified High Dose Melphalan (100 mg/m<sup>2</sup>) and Autologous Peripheral Blood Stem Cell Supported Transplantation (SCT) for Patients With AL Amyloidosis or High Risk ( $\geq$  age 70 or Poor Renal Function) Patients With Multiple Myeloma (A BMT Study)." Drs. Sanchorawala and Seldin. Activated: 1/1/04; Closed: 11/1/10.
- S0120, "A Prospective Observational Biologic Study of Asymptomatic Patients with Monoclonal Gammopathy and Plasma Proliferative Disorders." Drs. Dhodapkar, Shaughnessy, and Barlogie. Activated: 6/1/02; Closed: 4/1/11.
- S0309, "Myeloma Specimen Repository, Ancillary." Dr. Rimsza. Activated: 11/15/03; Closed: 11/1/10.
- S0629, "A Phase II Study of DT-PACE Induction Followed by Tandem Autologous Transplant and Maintenance with Thalidomide and Rituximab for Patients with Waldenström's Macroglobulinemia." Dr. Srkalovic. Activated: 9/15/08; Closed: 5/17/10.

# BARLOGIE-SALMON MYELOMA COMMITTEE

## Working Groups

Amyloidosis Working Group update

Waldenström's Working Group update

Myeloma Translational Medicine Subcommittee update

**No publication information for this cycle.**

**Barlogie-Salmon Myeloma Committee**  
**Cumulative Accrual by Institution and Study**  
**For the Period Ending August 17, 2011**

	CTN0702	E3A06	S0115	S0120	S0777
Arkansas, U of	-	-	22	292	2
BAMC/WHMC	-	-	-	12	-
Baylor College	-	-	-	-	14
Boston Univ Med Ctr	-	-	17	-	1
Central IL CCOP	-	-	-	-	4
City of Hope Med Ctr	-	-	1	-	-
Cleveland Clinic OH	-	-	8	2	11
Colorado, U of	-	-	-	-	5
Columbia River CCOP	-	-	1	-	3
Columbia University	-	-	-	2	6
Davis, U of CA	-	-	7	2	-
Dayton CCOP	-	-	1	-	6
Grand Rapids CCOP	-	-	-	-	2
Greenville CCOP	-	5	-	-	-
H Lee Moffitt CC	4	-	-	-	3
Harrington CC	-	-	-	-	1
Hawaii MBCCOP, U of	-	-	-	-	12
Henry Ford Hosp	-	-	3	18	-
Irvine, U of CA	-	-	-	-	5
Kaiser Permanente NCAL	-	-	-	-	10
Kansas City CCOP	-	-	-	4	4
Kansas, U of	-	-	2	15	3
King Faisal Spec Hos	-	-	-	-	1
LSU-Shreveport CCOP	4	-	-	-	-
Loyola University	-	-	-	9	2
MD Anderson	-	-	-	-	4
Michigan CRC CCOP	-	-	-	-	18
Michigan, U of	-	-	-	2	-
Mississippi, Univ of	-	-	-	-	2
Montana CCOP	-	1	-	-	5
New Mexico MBCCOP	-	-	-	-	6
Oregon Hlth Sci Univ	-	-	1	-	1
Providence Hosp	-	-	-	-	2
Puget Sound	-	-	9	2	-
Rochester, Univ of	-	-	-	1	12
San Antonio, U of TX	4	-	2	-	6
So Calif, U of	-	-	-	3	7
Southeast CCC CCOP	-	-	-	-	30

**Barlogie-Salmon Myeloma Committee  
Cumulative Accrual by Institution and Study  
For the Period Ending August 17, 2011**

	CTN0702	E3A06	S0115	S0120	S0777
Southern Nevada CCOP	-	-	-	-	9
St Louis CCOP	-	-	-	-	5
St Louis University	-	-	-	7	-
Tennessee, U of	-	-	-	-	4
Tulane University	-	-	8	-	-
Upstate Carolina	-	-	-	4	7
Utah, U of	1	-	4	-	-
Virginia Mason CCOP	-	-	-	-	1
Wayne State Univ	-	-	6	-	11
Wichita CCOP	-	-	12	-	17
CALGB	-	-	-	-	20
CTSU-NOS	-	-	-	-	4
ECOG	-	-	-	-	128
NCCTG	-	-	-	-	41
NSABP	-	-	-	-	3
RTOG	-	-	-	-	1
<b>Total</b>	<b>13</b>	<b>6</b>	<b>104</b>	<b>375</b>	<b>439</b>

Note: Some studies may not be listed because they were either closed prior to July 1, 2010 or because they are currently active but have not had any accrual through August 17, 2011.

# BREAST COMMITTEE

## Committee Leadership

Chair:	Gabriel N. Hortobagyi, M.D.
Vice-Chair:	Julie R. Gralow, M.D.
Executive Officer:	Anne F. Schott, M.D.
Statisticians:	William E. Barlow, Ph.D. Danika Lew, M.A.

## Scientific Leadership

Translational Medicine:	Daniel F. Hayes, M.D.
Radiation Oncology:	Thomas A. Buchholz, M.D.
Surgery:	Christine A. Lee, M.D.
Pathology:	Allen M. Gown, M.D. Peggy L. Porter, M.D.
Early Therapeutics:	Francisco J. Esteva, M.D., Ph.D.

## Designates

Clinical Research Associates:	Karyn N. Hart, C.C.R.P.
Cancer Survivorship:	Carol J. Fabian, M.D.
Outcomes & Comparative Effectiveness:	Dawn L. Hershman, M.D.
Molecular Epidemiology:	TBD
Prevention:	Melanie R. Palomares, M.D.
Symptom Control & QOL:	Helen K. Chew, M.D.
CCOP Representative:	David A. Decker, M.D.
Data Coordinators:	Jennie Barrett Jean Barce Iris Syquia Jeri Jardine Larry Kaye

Nurses:	Dorothy Coleman, R.N., M.S.
Patient Advocate:	Nancy Singleton
Pharmaceutical Science:	Jessie Modlin, Pharm.D. Craig Elg, Pharm.D.
Protocol Coordinator:	Megan Wardeski

## Time/Location

### Friday, October 14, 2011

Room: Regency West (Ballroom Level)  
3:15 p.m. – 7:00 p.m.

## Agenda

3:15 – 3:20 pm	Welcome and introductions - Gabriel N. Hortobagyi, M.D. and Julie R. Gralow, M.D.
3:20 – 3:30 pm	Publications update - Bill Barlow, Ph.D.
3:30 – 3:45 pm	Reports from Committee Liaisons
3:45 – 4:30 pm	Update of open SWOG and CTSU trials - All
4:30 – 4:45 pm	Studies in Development - All
4:45 – 4:55 pm	CCOP Working Group Report - David Decker

4:55 – 5:00 pm	New business - All
5:00 – 7:00 pm	Translational Medicine Sub-Committee

## SPECIAL PRESENTATION:

5:00 – 5:05 pm	Introduction of Special Speaker - Dan Hayes
5:05 – 5:40 pm	<b>Next Generation Sequencing: Where Can SWOG Get Involved?</b> - Joe Gray, PhD., University of Oregon Health Center
5:40 – 5:50 pm	Q & A
5:50 – 7:00 pm	Translational Medicine Working Group Updates - Daniel F. Hayes, M.D.

## Active Adjuvant Studies

- S0221, "Phase III Trial of Continuous Schedule AC + G Vs. Q 2 Week Schedule AC, Followed by Paclitaxel Given Either Every 2 Weeks or Weekly for 12 Weeks as Post-Operative Adjuvant Therapy in Node-Positive or High-Risk Node Negative Breast Cancer." Drs. Budd and Moore. Activated: 11/1/03.
- S1007, "A Phase III, Randomized Clinical Trial of Standard Adjuvant Endocrine Therapy +/- Chemotherapy in Patients with 1-3 Positive Nodes, Hormone-Receptor-Positive and HER2-Negative Breast Cancer with Recurrence Score (RS) of 25 or Less." Drs. Gonzalez-Angulo, Meric-Bernstam, Ramsey, and Moinpour. Activated: 1/15/11.
- CTSU/NSABP B-39, "A Randomized Phase III Study of Conventional Whole Breast Irradiation (WBI) Versus Partial Breast Irradiation (PBI) for Women with Stage 0, I, or II Breast Cancer." Dr. Pierce. Activated: 8/1/05.
- CTSU/NSABP B-47, "Phase III Adjuvant Therapy vs. Chemo plus Trastuzumab in Node Positive Patients." Dr. Albain. Activated: 1/6/11.
- CTSU/NCCTG N063D (BIG 2-06), "ALTO: Adjuvant Lapatinib and/or Trastuzumab Treatment Optimisation Study: A Randomised, Multi-Centre, Open-Label, Phase III Study of Adjuvant Lapatinib, Trastuzumab, Their Sequence and Their Combination in Patients with HER2/ErbB2 Positive Primary Breast Cancer." Dr. Gralow. Activated: 2/15/08.
- CTSU/CALGB 40601, "Randomized Phase III Trial of Paclitaxel Combined With Trastuzumab, Lapatinib, or Both as Neoadjuvant Treatment of HER2-Positive Primary Breast Cancer." Dr. Henry. Activated: 12/15/08.

# BREAST COMMITTEE

- CTSU/CALGB 40603, "Randomized Phase II 2 X 2 Factorial Trial Of The Addition Of Carboplatin +/- Bevacizumab To Neoadjuvant Weekly Paclitaxel Followed By Dose-Dense AC In Hormone Receptor-Poor/HER2-Negative Resectable Breast Cancer." Dr. Somlo. Activated: 6/1/10.

- CTSU/NCIC MA.32, "A Phase III Randomized Trial of Metformin Versus Placebo on Recurrence and Survival in Early Stage Breast Cancer." Dr. Hershman. Activated: 9/15/10.

## Active Advanced Disease Studies

- S0500, "A Randomized Phase III Trial to Test the Strategy of Changing Therapy Versus Maintaining Therapy for Metastatic Breast Cancer Patients Who Have Elevated Circulating Tumor Cell Levels at First Follow-Up Assessment." Drs. Smerage and Hayes. Activated: 10/1/06.
- S0800, "A Randomized Phase II Trial of Weekly Nanoparticle Albumin Bound Paclitaxel (Nab-Paclitaxel) (NSC-736631) with or without Bevacizumab, either Preceded by or Followed by Q2 Week Doxorubicin (A) and Cyclophosphamide (C) plus Pegfilgrastim (PEG-G) as Neoadjuvant Therapy for Inflammatory and Locally Advanced HER-2/NEU Negative Breast Cancer." Drs. Nahleh, Livingston, Hayes and Schott. Activated: 4/1/10.
- CTSU/NCCTG N0733, "Randomized Phase II Trial of Capecitabine and Lapatinib with or without IMC-A12 in Patients with HER2 Positive Breast Cancer Previously Treated with Trastuzumab and an Anthracycline and/or a Taxane." Dr. Linden. Activated: 8/15/08.
- CTSU/CALGB 40503, "A Randomized, Double-Blind, Placebo-Controlled Phase III Trial of Endocrine Therapy Alone or Endocrine Therapy Plus Bevacizumab (NSC 704865; IND 7921) for Women with Hormone Receptor-Positive Advanced Breast Cancer." Dr. Tripathy. Activated: 5/15/10.
- CTSU/E2108, "Randomized Phase III of Early Local Therapy for Intact Primary Tumor with MBC." Dr. Christine Lee. Activated: 2/8/11.
- CTSU/E3108, "A Phase II Prospective Trial Correlating PFS with CYP2D6 Activity in Patients with Metastatic Breast Cancer Treated with Single Agent Tamoxifen." Dr. Lohrisch. Activated: 11/15/10.

## Active Local/Regional Therapy Studies

- CTSU/ACOSOG Z1071, "A Phase II Study Evaluating the Role of Sentinel Lymph Node Surgery and Axillary Lymph Node Dissection Following Preoperative Chemotherapy in Women with Node Positive Breast Cancer (T1-4, N1-2, MO) at Initial Diagnosis." Dr. Byrd. Activated: 12/1/09.

## Active Cancer Control Studies

- S0702, "A Prospective Observational Multicenter Cohort Study to Assess the Incidence of Osteonecrosis of the Jaw (ONJ) in Cancer Patients with Bone Metastases Starting Zoledronic Acid Treatment." Drs. Van Poznak, Gralow, Schubert, and Bagramian, Lisa Hansen, R.N. Activated: 12/15/08.

## Closed Studies

- S0230, "Phase III Trial of LHRH Analog Administration during Chemotherapy to Reduce Ovarian Failure Following Chemotherapy in Early Stage, Hormone-Receptor Negative Breast Cancer." Drs. Moore, Albain, and Martino. Activated: 10/1/03; Closed: 6/1/11.
- S0715, "Randomized Placebo-Controlled Trial of Acetyl L-Carnitine (ALC) for the Prevention of Taxane Induced Neuropathy – Phase III." Drs. Hershman, Albain, Gotay and Lisa Hansen, R.N., M.S. Activated: 9/15/09; Closed: 2/1/11.

## Studies in Development

- S1101, "A Phase II Randomized, Placebo-Controlled Trial of Exemestane Plus OSI-906 Versus Exemestane Plus Placebo in Postmenopausal Patients with Metastatic Hormone Receptor Positive Breast Cancer." Dr. Somlo.
- S1105, "Text Messaging to Enhance Compliance with Adjuvant Anastrozole." Dr. Neugut.
- S1116, "Low Risk Her-2+ Breast Cancer: Targeted-Only Adjuvant Therapy - Toxicity and Safety (TOATTS)." Dr. Elias.
- "Randomized Phase II Trial of an Aromatase Inhibitor with and without Metformin in Postmenopausal Obese Women with Hormone Receptor Positive Metastatic Breast Cancer." Dr. Esteva. (possible CTI Trial)
- "Investigational Therapy for Patients with Residual Disease following Neoadjuvant Chemotherapy." Dr. Specht.
- "Phase III Study of Duloxetine for AI-Associated Symptoms." Dr. Henry.

# BREAST COMMITTEE

- “Phase III Trial of Armodafinil for Chemotherapy-Associated Fatigue and Cognitive Dysfunction.” Dr. Chew.

## New Proposals

- “Phase I/II Study of XL184 in Combination with Trastuzumab in Patients with HER2/neu Amplified Metastatic Breast Cancer Patients.” Dr. Chavez-MacGregor.
- PARP-Inhibitor + Radiotherapy Study. Dr. Jagsi.
- Physician Choice of Systemic Therapy vs. Tumor Profile-Directed Therapy. Dr. Maurer.
- Biomarker Discordance Study. Dr. Meric-Bernstam.
- “Randomization to Endocrine Therapy Alone Versus Endocrine Therapy Plus RAD-001 in the Neoadjuvant Setting for ER+ Breast Cancers Based Upon On-Therapy Biologic Response.” Drs. Sachdev and Massarweh.
- “Phase II Study of AT-406 in Metastatic Breast Cancer.” Dr. Schott.

## Publications

The publications listed below are those that have been received in published, submitted or accepted form by the Group Chair’s Office since the Spring 2011 meeting agenda booklet publication list.

## Published/Accepted Manuscripts

- S0215 SWOG S0215: A phase II study of docetaxel and vinorelbine plus filgrastim with weekly trastuzumab for HER2-positive, stage IV breast cancer. RB Livingston, WE Barlow, JJ Kash, KS Albain, JR Galow, DL Lew, LE Flaherty, ME Royce, GN Hortobagyi. Breast Cancer Research and Treatment 2011 Aug 9 [Epub ahead of print].
- S0221 Genetic predictors of taxane-induced neurotoxicity: results from a SWOG clinical trial for breast cancer. L Sucheston, H Zhao, S Yao, G Zirpoli, S Liu, W Barlow, G Budd, D Hershman, W Davis, GL Ciupak, JA Stewart, C Isaacs, T Hobday, M Salim, GN Hortobagyi, J Galow, R Livingston, K Albain, D Hayes, C Ambrosone. Breast Cancer Research and Treatment 2011 Jul 16 [Epub ahead of print] (N.B.: also listed under Molecular Epidemiology Committee)

- S9623/Multiple High dose chemotherapy with autologous stem cell support as adjuvant therapy in breast cancer: overview of 15 randomized trials. DA Berry, NT Ueno, MM Johnson, X Lei, J Caputo, S Rodenhuis, WP Peters, RC Leonard, WE Barlow, MS Tallman, J Bergh, UA Nitz, AM Gianni, RL Bassler, AR Zander, RC Coombes, H Roche, Y Tokuda, EGE de Vries, GN Hortobagyi, JP Crown, P Pedrazzoli, M Bregni, T Demirer. Journal of Clinical Oncology 29(24):3214-3223, 2011.
- C9741 Cancer and Leukemia Group B pathology committee guidelines for tissue microarray construction representing multicenter prospective clinical trial tissues. D Rimm, T Nielsen, S Jewel, D Rohrer, G Broadwater, F. Waldman, K Mitchell, B Singh, G Tsongalis, W Frankel, W Magliocco, J Lara, E Hsi, I Bleiweiss, S Badve, B Chen, P Ravdin, R Schilsky, A Thor, D Berry. Journal of Clinical Oncology 29(16):2282-2290, 2011.
- American Society of Clinical Oncology executive summary of the clinical practice guideline update on the role of bone-modifying agents in metastatic breast cancer. CH Van Poznak, S Temin, GC Yee, NA Janian, WE Barlow, JS Biermann, LD Bosserman, C Geoghegan, BE Hillner, RL Theriault, DS Zuckerman, JH Von Roenn. Journal of Clinical Oncology 29(9):1221-1227, 2011.

## Submitted Manuscripts

- S0221 Effect of physician recommendations on use of antioxidant supplements during an intergroup clinical trial for breast cancer (S0221). GR Zirpoli, PM Brennan, C-C Hong, SE McCann, G Ciupak, W Davis, JM Unger, GT Budd, DL Hershman, HCF Moore, J Stewart, C Isaacs, T Hobday, M Salim, GN Hortobagyi, J Galow, K Albain, CB Ambrosone. Journal of the National Cancer Institute, submitted 9/2/11. (N.B.: also listed under Outcomes and Comparative Effectiveness Committee)
- S0430 Phase II trial of simple oral therapy with capecitabine and cyclophosphamide in patients with metastatic breast cancer: SWOG S0430. AF Schott, WE Barlow, KS Albain, HK Chew, JL Wade, KS Lanier, DL Lew, DF Hayes, JR Galow, RB Livingston, GN Hortobagyi. The Oncologist, submitted 7/11/11.

**Breast Committee**  
**Cumulative Accrual by Institution and Study**  
**For the Period Ending August 17, 2011**

	B39	B47	C40101	C40302	C40503	C40601	C40603	C70301	E1105	E2108	IBC24-02	JMA20
Arizona, U of	-	-	20	-	-	2	-	-	-	-	-	-
Arkansas, U of	-	-	10	-	-	-	-	-	-	-	-	-
Atlanta Reg CCOP	-	1	-	-	-	6	-	1	-	14	-	-
BAMC/WHMC	-	-	12	-	-	-	-	-	-	3	-	-
Bay Area CCOP	-	-	1	-	-	-	-	-	-	1	-	-
Beaumont CCOP	-	-	2	-	-	-	-	-	-	12	-	-
Boston Univ Med Ctr	-	-	-	-	-	-	-	-	-	-	-	-
Central IL CCOP	-	-	50	6	8	-	-	-	-	8	-	-
Cincinnati MC, U of	-	-	-	-	-	-	-	-	-	1	-	-
City of Hope Med Ctr	-	-	1	-	-	2	-	-	-	-	-	-
Cleveland Clinic OH	-	-	19	-	-	-	-	-	-	9	-	-
Colorado, U of	-	-	3	2	-	2	-	-	-	1	-	-
Columbia River CCOP	-	-	2	-	1	-	-	-	-	3	-	-
Columbia University	-	-	43	-	4	1	-	-	-	-	-	-
Columbus CCOP	-	-	93	-	3	-	10	-	-	3	2	-
Davis, U of CA	2	1	69	3	-	2	-	7	-	1	13	3
Dayton CCOP	-	-	3	-	-	3	-	-	-	-	-	-
Galveston, U of TX	-	-	37	-	-	-	-	-	-	-	-	-
Grand Rapids CCOP	-	-	-	-	-	-	-	-	-	3	-	-
Greenville CCOP	-	-	-	-	-	-	-	-	-	-	-	-
Gulf Coast MBCCOP	-	-	2	-	-	-	-	1	-	-	-	-
H Lee Moffitt CC	-	3	4	-	-	-	-	1	-	5	-	-
Harrington CC	-	-	1	-	-	-	-	-	-	-	-	-
Hawaii MBCCOP, U of	-	-	5	-	-	2	-	1	-	1	-	-
Henry Ford Hosp	-	-	-	-	-	-	-	-	-	-	-	-
Irvine, U of CA	-	-	-	-	-	-	-	-	-	-	-	-
KaiserPermanenteNCAL	-	-	-	-	-	-	-	-	-	9	-	-
Kansas City CCOP	-	-	-	-	-	-	-	-	-	1	-	-
Kansas, U of	-	-	15	-	6	1	-	1	-	-	-	-
King Faisal Spec Hos	-	-	-	-	-	-	-	-	-	-	-	-
LSU-New Orleans CCOP	-	-	8	1	-	-	-	-	-	-	-	-
LSU-Shreveport	-	-	-	-	-	-	-	-	-	3	-	-
LSU-Shreveport CCOP	1	-	-	-	-	-	-	-	-	4	-	-
Los Angeles, U of CA	-	-	-	-	-	-	-	-	-	2	-	-
Loyola University	8	-	7	-	3	2	-	-	-	10	-	-
MD Anderson	-	-	-	-	-	-	-	-	-	26	-	-
MUSC, Hollings CC	-	-	11	-	-	-	-	-	-	-	-	-
Michigan CRC CCOP	-	-	-	-	-	-	-	-	-	-	-	-
Michigan, U of	-	-	25	12	-	-	-	-	-	14	-	-
Mississippi, Univ of	3	1	20	-	2	-	-	7	-	-	-	-

**Breast Committee**  
**Cumulative Accrual by Institution and Study**  
**For the Period Ending August 17, 2011**

	B39	B47	C40101	C40302	C40503	C40601	C40603	C70301	E1105	E2108	IBC24-02	JMA20
Montana CCOP	-	-	6	1	-	-	-	-	1	-	-	-
New Mexico MBCCOP	-	-	-	-	-	-	-	-	-	-	-	-
Northwest CCOP	-	-	8	-	-	2	-	-	-	-	1	-
Oklahoma, Univ of	-	-	8	-	-	-	-	-	-	-	-	-
Oregon Hlth Sci Univ	-	-	1	-	-	-	-	-	-	-	-	-
Ozarks Reg CCOP	-	-	11	-	2	-	-	-	1	-	-	-
Providence Hosp	-	-	7	-	-	-	-	-	-	-	-	-
Puget Sound	-	-	32	1	6	1	3	-	1	-	6	-
Rochester, Univ of	-	1	45	-	-	-	-	-	-	-	-	-
San Antonio, U of TX	-	-	45	-	-	-	-	1	-	-	8	1
Santa Rosa CCOP	-	-	3	-	-	-	-	-	-	-	3	-
Scott & White CCOP	-	-	-	-	-	-	-	-	-	-	1	-
So Calif, U of	-	-	17	-	-	5	-	-	-	-	4	-
Southeast CCC CCOP	-	-	-	-	-	-	-	-	2	-	3	1
Southern Nevada CCOP	-	-	-	-	-	-	-	-	-	-	-	-
St Louis CCOP	-	-	6	-	-	-	-	3	-	-	-	-
St Louis University	-	-	-	-	-	-	-	-	-	-	-	1
Tennessee, U of	-	-	-	1	-	-	-	-	3	-	-	-
Tulane University	-	-	-	-	-	-	-	-	-	-	-	-
Upstate Carolina	-	-	-	-	-	-	1	-	-	-	2	-
Utah, U of	-	-	12	1	-	-	2	-	-	-	-	-
Virginia Mason CCOP	-	-	-	-	-	-	-	-	-	-	2	-
Wayne State Univ	-	-	14	-	1	-	1	7	2	-	6	-
Western Reg CCOP	-	-	-	-	-	-	-	-	-	-	-	-
Wichita CCOP	-	-	55	-	-	-	4	-	-	-	5	-
ACOSOG	-	-	-	-	-	-	-	-	-	-	-	-
ANZ BCTG/ IBCSG	-	-	-	-	-	-	-	-	-	-	-	-
CALGB	-	-	-	-	-	-	-	-	-	-	-	-
CTSU-NOS	-	-	-	-	-	-	-	-	-	-	-	-
ECOG	-	-	-	-	-	-	-	-	-	-	-	-
FSS/ IBCSG	-	-	-	-	-	-	-	-	-	-	-	-
GOG	-	-	-	-	-	-	-	-	-	-	-	-
NCCTG	-	-	-	-	-	-	-	-	-	-	-	-
NCIC-CTG	-	-	-	-	-	-	-	-	-	-	-	-
NSABP	-	-	-	-	-	-	-	-	-	-	-	-
RTOG	-	-	-	-	-	-	-	-	-	-	-	-
<b>Total</b>	<b>14</b>	<b>7</b>	<b>733</b>	<b>28</b>	<b>36</b>	<b>16</b>	<b>26</b>	<b>35</b>	<b>15</b>	<b>1</b>	<b>187</b>	<b>8</b>

**Breast Committee**  
**Cumulative Accrual by Institution and Study**  
**For the Period Ending August 17, 2011**

	MA32	N063D	N0733	PACCT-1	S0221	S0230	S0307	S0500	S0622	S0800	S1007	Z1071
Arizona, U of	1	-	-	5	37	-	56	-	-	-	-	-
Arkansas, U of	-	4	-	93	56	-	11	5	8	3	-	-
Atlanta Reg CCOP	-	7	-	34	3	-	33	-	-	-	1	3
BAMC/WHMC	-	2	-	29	65	1	10	2	1	-	-	-
Bay Area CCOP	-	-	-	-	3	-	49	-	1	3	-	-
Beaumont CCOP	5	-	-	3	37	-	121	17	1	-	-	9
Boston Univ Med Ctr	-	-	-	-	-	-	2	-	2	-	-	-
Central IL CCOP	3	10	-	-	34	-	22	5	8	-	-	-
Cincinnati MC, U of	-	-	-	16	8	-	-	1	-	-	-	-
City of Hope Med Ctr	-	2	-	23	36	2	7	2	-	-	-	-
Cleveland Clinic OH	2	-	-	35	48	3	46	13	2	1	-	-
Colorado, U of	-	4	-	16	34	-	130	8	7	-	-	-
Columbia River CCOP	-	-	-	16	7	-	57	4	-	-	-	-
Columbia University	2	3	-	70	29	2	46	-	-	-	-	6
Columbus CCOP	-	-	-	2	73	1	22	-	3	12	-	14
Davis, U of CA	-	10	-	71	88	2	120	7	5	7	2	-
Dayton CCOP	-	-	-	2	1	1	9	-	-	2	1	-
Galveston, U of TX	-	-	-	6	-	-	-	7	-	-	-	-
Grand Rapids CCOP	-	-	-	24	25	-	23	6	-	-	-	-
Greenville CCOP	-	-	-	26	21	1	65	23	-	-	-	-
Gulf Coast MBCCOP	-	1	-	11	5	-	8	-	-	2	2	-
H Lee Moffitt CC	-	-	-	68	-	-	52	2	-	-	-	-
Harrington CC	-	-	-	-	-	-	28	-	-	-	-	-
Hawaii MBCCOP, U of	3	7	-	155	104	-	36	13	-	-	-	-
Henry Ford Hosp	-	-	-	14	20	1	8	19	-	-	-	-
Irvine, U of CA	-	-	-	51	6	-	27	1	-	-	-	-
KaiserPermanenteNCAL	6	-	-	37	-	-	85	-	-	-	-	-
Kansas City CCOP	-	2	-	29	24	-	28	-	-	-	-	6
Kansas, U of	-	8	-	24	20	1	79	4	-	-	-	-
King Faisal Spec Hos	-	-	-	-	-	3	-	-	-	-	-	-
LSU-New Orleans CCOP	-	1	-	-	16	-	8	-	-	-	-	-
LSU-Shreveport	-	-	-	12	66	-	-	-	-	-	-	-
LSU-Shreveport CCOP	-	-	-	53	58	-	-	-	-	-	-	-
Los Angeles, U of CA	-	-	-	-	-	-	-	-	-	-	-	-
Loyola University	-	7	-	33	96	2	48	-	2	-	3	1
MD Anderson	-	-	-	96	-	2	62	-	-	-	4	-
MUSC, Hollings CC	-	3	-	11	-	-	-	-	-	-	-	6
Michigan CRC CCOP	-	-	-	-	80	-	18	32	9	9	-	-
Michigan, U of	1	-	-	3	36	3	87	28	13	-	3	3
Mississippi, Univ of	2	3	-	66	11	-	23	11	1	1	-	-

**Breast Committee**  
**Cumulative Accrual by Institution and Study**  
**For the Period Ending August 17, 2011**

	MA32	N063D	N0733	PACCT-1	S0221	S0230	S0307	S0500	S0622	S0800	S1007	Z1071
Montana CCOP	-	-	-	13	62	2	45	7	6	-	-	-
New Mexico MBCCOP	3	-	-	-	29	-	82	3	2	1	1	-
Northwest CCOP	-	4	-	23	48	-	101	3	1	3	1	-
Oklahoma, Univ of	-	-	-	-	-	-	-	-	-	-	-	-
Oregon Hlth Sci Univ	2	-	-	31	3	3	66	1	-	-	-	-
Ozarks Reg CCOP	-	-	-	7	44	2	21	3	-	3	-	-
Providence Hosp	-	3	-	4	18	-	3	9	-	3	-	-
Puget Sound	2	3	2	73	100	2	157	8	-	-	2	3
Rochester, Univ of	-	1	-	49	7	1	28	-	3	-	-	-
San Antonio, U of TX	-	4	-	59	40	-	40	14	1	5	1	-
Santa Rosa CCOP	-	-	-	6	-	-	1	-	-	-	-	-
Scott & White CCOP	-	-	-	-	27	-	5	8	-	-	-	-
So Calif, U of	-	-	-	68	44	6	83	8	-	8	-	5
Southeast CCC CCOP	-	1	1	25	41	2	128	14	2	1	3	-
Southern Nevada CCOP	-	-	-	-	-	-	4	-	1	-	-	-
St Louis CCOP	1	1	-	12	7	-	15	-	-	-	1	-
St Louis University	-	-	-	12	-	-	-	-	-	-	-	-
Tennessee, U of	-	3	-	59	11	2	25	3	-	-	-	-
Tulane University	-	3	-	-	2	-	-	-	-	-	1	-
Upstate Carolina	-	-	-	6	1	-	17	-	5	4	-	-
Utah, U of	3	8	-	61	36	-	97	5	-	-	-	-
Virginia Mason CCOP	-	-	-	2	20	-	101	9	1	-	-	-
Wayne State Univ	-	14	-	66	71	-	76	7	-	5	1	2
Western Reg CCOP	-	-	-	2	6	-	-	-	-	-	-	-
Wichita CCOP	5	-	-	-	16	8	117	4	-	-	5	9
ACOSOG	-	-	-	-	20	-	45	12	-	-	-	-
ANZ BCTG/ IBCSG	-	-	-	-	-	58	-	-	-	-	-	-
CALGB	-	-	-	-	302	14	1,227	53	-	-	7	-
CTSU-NOS	-	-	-	-	43	-	267	-	-	-	-	-
ECOG	-	-	-	-	350	86	603	71	-	-	6	-
FSS/ IBCSG	-	-	-	-	-	46	-	-	-	-	-	-
GOG	-	-	-	-	1	-	13	-	-	-	-	-
NCCTG	-	-	-	-	376	-	388	48	-	-	2	-
NCIC-CTG	-	-	-	-	79	-	398	-	-	-	-	-
NSABP	-	-	-	-	24	-	495	43	-	-	3	-
RTOG	-	-	-	-	17	-	23	1	-	-	-	-
<b>Total</b>	<b>41</b>	<b>119</b>	<b>3</b>	<b>1,712</b>	<b>2,992</b>	<b>257</b>	<b>6,097</b>	<b>544</b>	<b>85</b>	<b>73</b>	<b>50</b>	<b>67</b>

Note: Some studies may not be listed because they were either closed prior to July 1, 2010 or because they are currently active but have not had any accrual through August 17, 2011.

# CANCER CONTROL & PREVENTION COMMITTEES

## Committee Leadership

Assoc. Chair for Cancer Control & Prevention: Frank Meyskens, Jr. M.D.  
 CC&P Executive Council Co-Chair: Powel Brown, M.D. Ph.D.  
 Statisticians: Garnet Anderson, Ph.D.  
 William E. Barlow, Ph.D.  
 Joseph M. Unger, M.S.  
 Danika Lew, M.A.  
 Kathryn B. Arnold, M.S.

## Scientific Leadership

CCOP Representative: Jeffrey Giguere, M.D.  
 Radiation Therapy Committee: Louis "Sandy" Constine, M.D.  
 Surgery Committee: Robert S. Krouse, M.D.FACS  
 Translational Medicine: James (Jimmy) Rae, Ph.D.  
 Liaisons:  
 Breast Committee: Carol J. Fabian, M.D.  
 Regina M. Santella, Ph.D.  
 Helen Chew, M.D.  
 Dawn Hershman, M.D, M.S.  
 Melanie Palomares, M.D.  
 Gastrointestinal Committee  
 Colon: Jason, Zell, D.O.  
 Genitourinary Committee: Peter J. Van Veldhuizen, Jr., M.D.  
 International Liaison: Kathy S. Albain, M.D.  
 Lung Committee: Gary E. Goodman, M.D.  
 Lymphoma Committee: John W. Hayslip, M.D.  
 Melanoma Committee: TBD

## Designates

Clinical Research Associates: Connie Szczepanek, R.N., B.S.N.  
 Susan Majeski, C.C.R.P.  
 Joyce N. Tull, R.N., B.S.N.  
 Micheal F. Stephens, C.C.R.A.  
 Nursing Committee: Lisa Hansen, R.N., M.S.  
 Pharmaceutical Science: Siu-Fun Wong, Pharm.D.  
 Data Coordinators: Stephanie Edwards  
 Jeri Jardine  
 Patient Advocates: Daniel M. Moore, Jr., J.D.  
 Anna Gottlieb

Protocol Coordinator - (Outcomes and Comparative Effectiveness, Prevention, and Molecular Epidemiology): Patricia O'Kane  
 Protocol Coordinator - (Cancer Survivorship; Symptom Control and Quality of Life): Kimberly Kaberle

## Cancer Control and Prevention Executive Council (Committee Members Only)

### Time/Location

**Thursday, October 13, 2011**

Room: Live Oak (Hill Country Level)

8:00 a.m. – 10:00 a.m.

### Agenda

8:00 – 8:05 a.m. Welcome - Frank Meysken, Jr., M.D., University of CA, Irvine, Chao Family Comprehensive Cancer Center

8:05 – 8:15 a.m. Operational Update Q&A - Dana Sparks, M.A.T., SWOG Operations Office

8:15 – 8:20 a.m. Feasibility Check List process and update - Frank Meyskens, Jr., M.D., University of CA, Irvine, Chao Family Comprehensive Cancer Center

8:20 – 8:35 a.m. Funding for Feasibility Studies - Carol Moinpour, Ph.D., Fred Hutchinson CRC

8:35 – 8:45 a.m. Statistical Update - Garnet Anderson, Ph.D./Joseph Unger, M.S., SWOG Statistical Center

### COMMITTEE REPORTS

8:45 – 8:50 a.m. Prevention Committee - Powel Brown, M.D., Ph.D., MD Anderson Cancer Center/ Gary Goodman, M.D., Swedish Medical Center Cancer Institute

8:50 – 9:00 a.m. Molecular Epidemiology Committee Regina Santella, Ph.D., Columbia University

9:00 – 9:10 a.m. Symptom Control and QOL Committee - Carol Moinpour, Ph.D., Fred Hutchinson CRC/James Wade, III, M.D., Cancer Care Specialists of Central Illinois

# CANCER CONTROL & PREVENTION COMMITTEES

9:10 – 9:20 a.m. Outcomes and Comparative Effectiveness Committee - Dawn Hershman, M.D., Columbia University/Scott Ramsey, M.D., Ph.D., Fred Hutchinson CRC

9:20 – 9:30 a.m. Cancer Survivorship Committee - Carol Fabian, M.D., University of Kansas Medical Center/Robert Krouse, M.D., Southern Arizona VA

9:30 – 9:40 a.m. Pharmacy Update - Siu-Fun Wong, Loma Linda University

9:40 – 10:00 a.m. Closing Remarks - Frank Meyskens, Jr., M.D., Jr., M.D., University of CA, Irvine, Chao Family Comprehensive Cancer Center  
 1. Theme for Fall Harry Hynes Symposia  
 2. Turn in presentations for Harry Hynes  
 3. Friday dinner

## Harry E. Hynes CCOP Symposium (Joint Session)

### Time/Location

**Friday, October 14, 2011**

Room: Regency East #1 & #2 (Ballroom Level)

10:00 a.m. – 12:00 p.m.

### Agenda

10:00 – 10:05 a.m.

WELCOME - Jeffrey Giguere, M.D., Cancer Centers of the Carolinas

10:05 – 10:40 a.m.

**Presentation: "Vitamin D and Human Health: A Critical Appraisal of the Evidence."** - JoAnn Manson M.D., Dr.PH., Brigham and Women's Hospital, Harvard Medical School

10:40 – 11:15 a.m.

**"Solar Radiation and Cancer: a two edge sword?"** - Marianne Berwick, Ph.D., M.P.H., University of New Mexico

11:15 – 11:35 a.m.

**"Aromatase Inhibitors: Improving Adherence and Reducing Toxicities"** Dawn Hershman, M.D., M.S., Columbia University

11:35 – 11:55 a.m.

CC&P Committee updates to CCOPs

11:55 a.m. – 12:00 p.m.

Closing Remarks - Frank Meyskens, Jr., M.D., University of CA, Irvine, Chao Family Comprehensive Cancer Center

# CANCER SURVIVORSHIP COMMITTEE

## Cancer Survivorship Committee Co-Chairs:

Carol J. Fabian, M.D.

Robert S. Krouse, M.D.

## Time/Location

**Friday, October 14, 2011**

Room: Rio Grande East (Ballroom Level)

7: 30 a.m. – 9:45 a.m.

## Agenda

Introductions and Updates

### Special Presentation:

**Increasing Strength and Physical Activity for Cancer Prevention and Survivorship - The Evolution and Reversal of a Sedentary Lifestyle.** - Kathryn Schmitz, Ph.D., University of Pennsylvania (Plenary Speaker)

### Presentations of Concepts Under Review and Discussion

- Prediction of Subclinical Cardiac Dysfunction with Cardiopulmonary Testing and Improvement with Exercise: Klemp, Proter, Floyd. Update of Intervention Pilot Results by Dr. Klemp. Critique by Dr. Schmitz.  
Advocate Comments
- A Randomized Trial of High Dose Vitamin D vs Placebo in Women Beginning Adjuvant Aromatase Inhibitors to Increase Adherence and Improve Long Term Quality of Life. Primary Committee is Survivorship and Secondary Committee is Quality of Life and Symptom Control. Update by Dr. Khan.  
Advocate Comments
- Phase III Randomized Placebo Controlled Study of Armodafinil in Patients with Early Stage Breast Cancer for Chemotherapy Associated Fatigue and Cognitive Dysfunction. Update by Dr. Chew.  
Advocate Comments
- Approved R21 Grant; Protocol in development: S1008, "Pilot and Feasibility Study of a Physical Activity and Dietary Change Weight Loss Intervention In Breast and Colorectal Cancer Patients". Dr. Heather Greenlee.

## Active Studies

- Ancillary to S0221 (R01), Antioxidant and CAM Use and Survival, Drs. Ambrosone and Albain.
- S0702, "A Prospective Observational Multicenter Cohort Study to Assess the Incidence of Osteonecrosis of the Jaw (ONJ) in Cancer Patients with Bone Metastasis Starting Zoledronic Acid Treatment." Drs. Van Poznak and Gralow. Activated: 12/15/08. (Primary Committee Symptom Control).

## Closed Studies

- S0230, "Phase III Trial of LHRH Analog Administration During Chemotherapy to Reduce Ovarian Failure Following Chemotherapy in Early Stage, Hormone-Receptor Negative Breast Cancer." Drs. Moore, Albain, and Martino. Activated: 10/1/03; Closed: 6/1/11.
- S0715, "Randomized Placebo-Controlled Trial of Acetyl L-Carnitine For The Prevention Of Taxane-Induced Neuropathy". Drs. Hershman, Albain, Gotay and Lisa Hansen, R.N., M.S. Activated: 9/15/09; Closed: 2/1/11. (Co-assignment to Symptom Control/OOL Committee).

**Other Ideas for Concept Submission:** Dr Krouse et al

## Other Business

1. Report from STAT Office on status of Long Term Follow-up Proposal
2. Report from Kathy Albain on Survivorship Task Force and International Society of Cancer Prevention.
3. Report from Advocate Committee.

## Publications

The publications listed below are those that have been received in published, submitted or accepted form by the Group Chair's Office since the Spring 2011 meeting agenda booklet publication list.

### Published/Accepted Manuscripts

No publication information for this cycle.

### Submitted Manuscripts

- Cancer survivors in the United States: a review of the literature and a call to action. M Valdivieso, A Kujawa, T Jones, L Baker. Cancer, submitted 8/16/11.

# MOLECULAR EPIDEMIOLOGY COMMITTEE

## Molecular Epidemiology Committee Co-Chairs:

Regina M. Santella, Ph.D.

### Time/Location

Thursday, October 13, 2011

Room: Rio Grande Center (Ballroom Level)

10:15 a.m. – 12:15 a.m.

### Agenda

#### Presentation

**African ancestry and aggressive breast cancer: a potential role of vitamin D** - Song Yao, Ph.D., Roswell Park Cancer Institute

#### Discussion

#### Active Studies

- S8897 – status of papers. Dr. Yao.
- S0221 Antioxidant study, status of papers. Dr. Yao.
- PCPT P01 Status of studies/papers. Dr. Hoque.
- SELECT and PCPT biorepository use requests. Dr. Santella.
- Update on collaboration with Margaret Briehl, Lisa Rimsza (Translational Medicine) on Variants in Oxidative Stress Pathways and Lymphoma Outcomes (funded by Hope Foundation). Dr. Yao.

#### Closed Studies

- S0424, "Molecular Epidemiology Case-Series Study of Non-Small Cell Lung Cancer in Smoking and Non-Smoking Women and Men." Drs. Ambrosone, Santella, Albain, Gumerlock and Reid. Activated: 10/1/05; Closed: 3/15/11. (Santella or Redman report)

#### New Business

- Grant to perform a genome wide scan in relation to toxicities in patients on S0221. Dr. Ambrosone. (Yao update progress)
- Study to examine SNPs in microRNAs in relation to toxicity and survival in S8897. Dr. Yao.
- Examine genetic variants in relation to cisplatin-related toxicities among patients with colorectal cancer. Drs. Zell and Ambrosone.

- Prospective validation of karyometric analysis of cutaneous squamous cell carcinoma. Drs. Glazer and Krouse.

- Submission of CCOP grant

### Publications

The publications listed below are those that have been received in published, submitted or accepted form by the Group Chair's Office since the Spring 2011 meeting agenda booklet publication list.

#### Published/Accepted Manuscripts

- S9217 Serum estrogen levels and prostate cancer risk in the Prostate Cancer Prevention Trial: a nested case-control study. S Yao, C Till, A Kristal, P Goodman, A Hsing, C Tangen, E Platz, F Stanczyk, J Reichardt, L Tang, M Neuhaus, R Santella, W Figg, D Price, H Parnes, SM Lippman, IM Thompson, C Ambrosone, A Hoque. *Cancer Cause and Control* 22(8):1121-1131, 2011.
- S9217 Repeat polymorphisms in estrogen metabolism genes and prostate cancer risk: results from the Prostate Cancer Prevention Trial. L Tang, S Yao, C Till, PJ Goodman, CM Tangen, Y Wu, AR Kristal, EA Platz, ML Neuhaus, FZ Stanczyk, JK Reichardt, RM Santella, A Hsing, A Hoque, SM Lippman, IM Thompson, CB Ambrosone. *Carcinogenesis* 2011 Aug 30 [Epub ahead of print].
- S0221 Genetic predictors of taxane-induced neurotoxicity: results from a SWOG clinical trial for breast cancer. L Sucheston, H Zhao, S Yao, G Zirpoli, S Liu, W Barlow, G Budd, D Hershman, W Davis, GL Ciupak, JA Stewart, C Isaacs, T Hobday, M Salim, GN Hortobagyi, J Gralow, R Livingston, K Albain, D Hayes, C Ambrosone. *Clinical Cancer Research*, 2011 Jul 16 [Epub ahead of print] (N.B.: also listed under Breast Committee)
- SWOG cooperative group biorepository resource: access for scientific research studies. C Hoban, W Franklin, K Kopecky, L Baker. *Clinical Cancer Research*, 17(16):5239-46, 2011.

#### Submitted Manuscripts

No publication information for this cycle.

# OUTCOMES AND COMPARATIVE EFFECTIVENESS COMMITTEE

## Outcomes and Comparative Effectiveness Committee Co-Chairs:

Dawn L. Hershman, M.D.

Scott D. Ramsey, M.D., Ph.D.

## Time/Location

**Thursday, October 13, 2011**

Room: Regency West (Ballroom Level)

5:30 p.m. – 7:30 p.m.

## Agenda

### Presentations:

**“Risk Factors for Financial Hardship in Colon Cancer Patients.”**

Veena Shankaran, M.D., Seattle Cancer Care Alliance, Seattle, WA.

**“A Sero-Epidemiologic Survey of HIV and Hepatitis B/C in Cancer Patients in the US.”** – Mary Redman, Ph.D. SWOG

Statistical Center, Fred Hutchinson Cancer Research Center, Seattle, WA.

**“Center for Comparative Effectiveness Research in Cancer Genomics (CANCERGEN): Progress and Updates.”** – Rahber

Thariani, Ph.D., University of Washington School of Pharmacy

**Update on “S1105, Randomized Trial of Text-Messaging Intervention To Reduce Early Discontinuation of Adjuvant Aromatase Inhibitor Therapy in Women With Early Stage Breast Cancer.”** – Dawn Hershman, M.D.

### Active Studies

- **CANCERGEN:** Update on Quality of Life and Economic Analysis Sub-study of Breast protocol S1007. Bill Barlow, Ph.D.

### Closed Studies

- **NexCura Barriers Survey:** “Online survey of barriers to clinical trial participation.” Joseph M. Unger, M.S.

### Ongoing Database projects

- **Toxicity and survival analysis by gender in Southwest Oncology Group Trials.** Dr. Albain, Joseph M. Unger, M.S. and Dr. Gotay. Endpoint/Demographic Factor: Gender – Results to be discussed. Disease type: Multiple
- **Women have similar toxicity profiles as men, but better survival in advanced NSCLC.** Dr. Albain and Joseph M. Unger, M.S.

Endpoint/Demographic Factor: Toxicity and Survival/Gender  
Disease type: NSCLC

- **Evaluating Long Term Effects with SWOG-Medicare.** Dr. Hershman, Joseph M. Unger, M.S.  
Disease type: Multiple

### Approved Concepts

- **S1105, “Randomized Controlled Trial of a Behavioral Intervention to Improve Adherence to Adjuvant Aromatase Inhibitor Therapy in Women with Early Stage Breast Cancer”.** Drs. Neugut and Hershman.

### Proposed Concepts

- **Pragmatic Prospective Trial of Colony Stimulating Factors for Cancer Patients Receiving Myelosuppressive Chemotherapy.** Dr. Ramsey.
- **Genomic Testing Patterns and Preferences in Advanced Nonsmall Cell Lung Cancer.** Dr. Goulart.
- **A prospective, randomized trial of breast tumor markers to detect recurrence in women with local and regional stage breast cancer.** Drs. Ramsey and Henry.

## Publications

The publications listed below are those that have been received in published, submitted or accepted form by the Group Chair’s Office since the Spring 2011 meeting agenda booklet publication list.

### Published/Accepted Manuscripts

- **Multiple Studies** Prioritization in comparative effectiveness research: the CANCERGEN experience in cancer genomics. R Thariani, W Wong, JJ Carlson, L Garrison, S Ramsey, PA Deverka, L Esmail, S Rangarao, C Hoban, L Baker, DL Veenstra. Medical Care, accepted 8/11.

### Submitted Manuscripts

- **S0221** Effect of physician recommendations on use of antioxidant supplements during an intergroup clinical trial for breast cancer (S0221). GR Zirpoli, PM Brennan, C-C Hong, SE McCann, G Ciupak, W Davis, JM Unger, GT Budd, DL Hershman, HCF Moore, J Stewart, C Isaacs, T Hobday, M Salim, GN Hortobagyi, J Gralow, K Albain, CB Ambrosone. Journal of the National Cancer Institute, submitted 9/2/11. (N.B.: also listed under Breast Committee)

# PREVENTION COMMITTEE

## Prevention Committee Co-Chairs:

Powel Brown, M.D., Ph.D.

Gary E. Goodman, M.D.

## Time/Location

**Thursday, October 13, 2011**

Room: Live Oak (Hill Country Level)

3:15 p.m. – 5:15 p.m.

## Agenda

3:15 p.m. Introduction

**Presentation: "Vitamin D in the Prevention of Cancer and Cardiovascular Disease: A Critical Appraisal"** - JoAnn E. Manson, M.D., Dr.PH.

Panel Discussion and Questions

## Active Studies

- S0000-R, "Centralized Follow-up to Selenium and Vitamin E Cancer Prevention Trial (SELECT)." Drs. Klein, Lippman, Thompson and Lucia.
- S0000B, "Prevention of Cataract and Age-Related Macular Degeneration with Vitamin E and Selenium – SELECT Eye Endpoints (SEE) Phase III Ancillary to S0000 – SELECT." Drs. Christen, Glynn and Gaziano. Activated: 7/1/04.
- S0000D, "A Study of the Effect of Vitamin E and/or Selenium on Adenomatous Colorectal Polyps (ACP) in Participants Enrolled in SELECT, Phase III Ancillary to S0000-SELECT." Drs. Lance, Alberts, Battacharyya, Green, and Martinez. Activated: 6/3/08.
- CTSU/C70807, "The Men's Eating and Living (MEAL) Study: A Randomized Trial of Diet to Alter Disease Progression in Prostate Cancer Patients on Active Surveillance". Dr. Van Veldhuizen. Activated: 6/1/11.

## Closed Studies

- S0000, "Selenium and Vitamin E Cancer Prevention Trial (SELECT)." Drs. Klein, Lippman, Thompson and Lucia. Activated: 7/25/01; Closed: 6/24/04.
- S0000A, "Prevention of Alzheimer's Disease with Vitamin E and Selenium (PREADVISE), Phase III Ancillary to S0000 – SELECT."

Drs. Markesbery and Schmitt. Activated: 5/17/02; Closed: 9/30/09.

- S0000C, "Prevention of Lung Function Decline with Vitamin E and Selenium – Respiratory Ancillary Study (RAS) to SELECT". Drs. Cassano and Kristal. Activated 6/4/04; Closed 5/1/07.
- E5597, "Phase III Chemoprevention Trial of Selenium Supplementation in Persons with Resected Stage I Non-Small Cell Lung Cancer." Dr. Kucuk. Activated: 12/1/00; Closed: 11/5/09.
- S0701, "A Phase III Randomized Trial of Three Antibiotic Regimens to Eradicate Helicobacter Pylori." Dr. Greenberg. Activated: 6/16/09; Closed: 6/30/10.

## Studies posted on website for IRB review

- S0812, "A Randomized Double-Blind Placebo-Controlled Biomarker Modulation Study of Vitamin D in Premenopausal Women at High-Risk For Breast Cancer, Phase IIB." Dr. Crew. Posted for IRB review: 9/1/11.
- S0820, "A Double-Blind Placebo-Controlled Trial of Eflornithine and Sulindac to Prevent Recurrence of High Risk Adenomas and Second Primary Colorectal Cancers in Patients With Stage 0-III Colon Cancer, Phase III." Drs. Zell, Brown, Lance, Krouse and Lipkin. Posted for IRB review: 4/15/11.

## New Business

1. Prostate Cancer Prevention Studies
2. Skin Cancer Prevention
3. Water Contamination Study – H. Pylori ancillary

## Publications

The publications listed below are those that have been received in published, submitted or accepted form by the Group Chair's Office since the Spring 2011 meeting agenda booklet publication list.

## Published/Accepted Manuscripts

- S0701 A randomised trial of empiric 14-day triple, 5-day concomitant, and 10-day sequential therapies for helicobacter pylori in seven Latin American sites. ER Greenberg, GL Anderson, DR Morgan, J Torres, WD Chey, LE Bravo, RL Dominguez, C Ferreccio, R Herrero, EC Lazcano-Ponce, M Mezza-Montenegro, R Pena, E Salazar-Martinez, P Correa, ME Martinez, M Valdivieso, GE Goodman, J Crowley, LH Baker. Lancet 378(9790):507-514, 2011.

# PREVENTION COMMITTEE

- S9041 Colorectal chemoprevention pilot study (SWOG-9041), randomized and placebo controlled: the importance of multiple luminal lesions. D Chu, M Hussey, D Alberts, F Meyskens, C Fenoglio-Preiser, S Rivkin, G Mills, J Giguere, C Blanke, G Goodman. Clinical Colorectal Cancer, 2011 Jul 20 [Epub ahead of print]. (N.B.: also listed under GI Committee)
- S9217 Serum phospholipid fatty acids and prostate cancer risk: results from the Prostate Cancer Prevention Trial. TM Brasky, E White, M Neuhouser, IM Thompson, X Song, C Till, A Kristal. American Journal of Epidemiology, 173(12):1429-1439, 2011.
- S9217 Association of symptomatic benign prostatic hyperplasia and prostate cancer: results from the Prostate Cancer Prevention Trial. JM Schenk, AR Kristal, KB Arnold, CM Tangen, ML Neuhouser, DW Lin, E White, IM Thompson. American Journal of Epidemiology 173(12):1419-1428, 2011.
- S9917 Selenium supplementation and prostate cancer among men with high grade prostatic intraepithelial neoplasia: SWOG-directed intergroup trial S9917. JR Marshall, C Tangen, W Sakr, DP Wood, D Berry, E Klein, S Lippman, H Parnes, D Alberts, D Jarrard, WR Lee, JM Gaziano, ED Crawford, B Ely, M Ray, W Davis, L Minasian, I Thompson. Cancer Prevention Research, 2011 Sep 6 [Epub ahead of print]. (N.B.: also listed under GU Committee)
- S0000 Vitamin E and the risk of prostate cancer: updated results of the Selenium and Vitamin E cancer prevention trial (SELECT). EA Klein, IM Thompson, CM Tangen, JJ Crowley, MS Lucia, PJ Goodman, L Minasian, LG Ford, HL Parnes, JM Gaziano, DD Karp, MM Lieber, PJ Walther, L Klotz, JK Parsons, JL Chin, A Darke, SM Lippman, GE Goodman, FL Meyskens, LH Baker. Journal of the American Medical Association, accepted 9/6/11.
- C89803 Relationship between statin use and colon cancer recurrence and survival: results from CALGB 89803. K Ng, S Ogino, J Meyerhardt, J Chan, D Niedzwiecki, D Hollis, LB Saltz, RJ Mayer, AB Benson, PL Schaefer, R Whittom, A Hantel, RM Goldberg, M Bertagnolli, AP Venook, CS Fuchs. Journal of the National Cancer Institute, 2011 Aug 17 [Epub ahead of print]. (N.B.: also listed under Prevention Committee)

## Submitted Manuscripts

- S0000 Evaluation of selenium supplementation on the prevention of bladder cancer in SWOG-coordinated SELECT. Y Lotan, PJ Goodman, R Youssef, RS Svatek, SF Shariat, CM Tangen, IM Thompson, E Klein. Cancer Epidemiology, Biomarkers & Prevention, submitted 9/5/11.
- S9217 Finasteride reduces the risk of incident symptomatic benign prostatic hyperplasia. JK Parsons, JM Schenk, KB Arnold, K Messer, C Till, IM Thompson, AR Kristal. Journal of the American Medical Association, submitted 7/18/11.
- S9217 Predictors of adherence to an end point biopsy: lessons learned from the Prostate Cancer Prevention Trial (SWOG-coordinated intergroup study S9217). ER Gritz, CM Moinpour, KB Arnold, JF Probstfield, AM Burton, WA See, MM Lieber, V Caggiano, S Moody-Thomas, C Szczepanek, A Ryan, S Carlin, S Hill, P Goodman, R Padberg, L Minasian, F Meyskens, IM Thompson. Clinical Trials, under review, 7/11.

# SYMPTOM CONTROL & QUALITY OF LIFE COMMITTEE

## Symptom Control and QOL Committee Co-Chairs:

Carol M. Moinpour, Ph.D.  
James L. Wade, III, M.D.

### Time/Location

**Thursday, October 13, 2011**

Room: Live Oak (Hill Country Level)  
12:45 p.m. – 2:45 p.m.

### Agenda

#### Introductions and Presentations

**Exercise Interventions During Curative Cancer Care: Benefits, Barriers, and Opportunities** - Kathryn H. Schmitz, Ph.D., M.P.H., Center for Clinical Epidemiology and Biostatistics, University of Pennsylvania School of Medicine and Abramson Cancer Center

#### Active Studies

- S0702, "A Prospective Observational Multicenter Cohort Study to Assess the Incidence of Osteonecrosis of the Jaw (ONJ) in Cancer Patients with Bone Metastasis Starting Zoledronic Acid Treatment." Drs. Galow and Van Poznak. Activated: 12/15/08.
- CTSU/C90203, "A Randomized Phase III Study of Neo-Adjuvant Docetaxel and Androgen Deprivation Prior to Radical Prostatectomy Versus Immediate Radical Prostatectomy in Patients with High-Risk, Clinically Localized Prostate Cancer." Dr. Kim. Activated: 7/1/07.
- CTSU/E3805, "CHAARTED: Chemo-Hormonal Therapy versus Androgen Ablation Randomized Trial for Extensive Disease in Prostate Cancer." Dr. Garcia. Activated: 9/1/08.
- CTSU/NCCTG N0733, "Randomized Phase II Trial of Capecitabine and Lapatinib with or without IMC-A12 in Patients with HER2 Positive Breast Cancer Previously Treated with Trastuzumab and an Anthracycline and/or a Taxane." Dr. Linden. Activated: 8/15/08.
- CTSU/R0848, "A Phase III Trial Evaluating both Erlotinib and Chemoradiation As Adjuvant Treatment for Patients with Resected Head of Pancreas Adenocarcinoma." Dr. Philip. Activated: 12/15/09.
- CTSU/RTOG R1010, "A Phase II Trial Evaluating the Addition of Trastuzumab to Trimodality Treatment of HER-2 Overexpressing

Esophageal Adenocarcinoma." Dr. L. Leichman. Activated: 9/1/11.

#### Closed Studies

- S0421, "Phase III Study of Docetaxel and Atrasentan Versus Docetaxel and Placebo for Patients with Advanced Hormone Refractory Prostate Cancer." Drs. Quinn, Hussain, Lara, Garzotto, Gumerlock, Moinpour and Berry. Activated: 8/21/06; Closed: 5/1/10.
- S0715, "Randomized Placebo-Controlled Trial of Acetyl L-Carnitine for the Prevention of Taxane-Induced Neuropathy". Drs. Hershman and Albain. (Co-assignment to Survivorship Committee). Activated: 9/15/09; Closed 2/1/11.
- CTSU/PR11, "A Phase III Study of Active Surveillance Therapy Against Radical Treatment in Patients Diagnosed with Favourable Risk Prostate Cancer (START)." Dr. Thompson (NCIC). Activated: 7/15/07; Closed 5/13/11.

#### Proposed Studies

- S0927, "Randomized Placebo-Controlled Trial of Omega-3-Fatty Acid for the Control of Aromatase Inhibitor-Induced Musculoskeletal Pain and Stiffness in Women with Early Stage Breast Cancer, Phase III." Dr. Hershman.  
· Protocol approved: 10/4/10; Revision 0 approved: 7/22/11.
- S1009, "A Pilot Randomized Double-Blinded Placebo-Controlled Study to Evaluate the Use of a Topical Wound Gel in Patients with Cutaneous Toxicity Cause by Epidermal Growth Factor Receptor (HER1/EGFR) Inhibitors." Dr. Wong.
- S1013, "A Phase II Prospective Study of Epidermal Growth Factor Receptor (Her-1/EGFR) Inhibitor-Induced Dermatologic Toxicity: Validation of the Functional Assessment of Cancer Therapy-EGFRI 18 (FACT-EGFRI 18) Questionnaire for EGFRI-Induced Skin Toxicities". Dr. Wong.  
· Protocol Approved: 8/9/11.
- S1116, "Low Risk Her-2+ Breast Cancer: Targeted-Only Adjuvant Therapy – Toxicity and Safety (TOATTS)." Dr. Elias.
- S1200, "Randomized Blinded Sham- and Waitlist-Controlled Trail of Acupuncture for Joint Symptoms Related to Aromatase Inhibitors in Women with Early Stage Breast Cancer." Dr. Hershman.  
· R01 grant. SWOG approved study: 5/26/11.  
· Protocol in development.



# SYMPTOM CONTROL & QUALITY OF LIFE COMMITTEE

- R01 Grant S1010, "A Phase II Trial Examining the Feasibility of An Exercise Intervention Initiated During Chemotherapy for Breast Cancer in a Cooperative Research Group." Dr. Rogers. · R01 application submitted February 2011.

## Concepts in Development

- "A Feasibility Study of Online Mindfulness Meditation for Newly Diagnosed Cancer Patients". Drs. Huynh , Bantum, Fann, Albain and Gotay.
- Phase III Study of Duloxetine for Treatment of Aromatase Inhibitor-Associated Musculoskeletal Symptoms in Women with Early Stage Breast Cancer. Dr. Henry.
- GWAS analysis for oxaplatin-associated neurotoxicity. Drs. Zell and Ambrosone.

## Cancer Survivorship Studies in Development

- "Phase III Randomized, Placebo-Controlled Study of Armodafinil in Patients With Early Stage Breast Cancer for Chemotherapy-Associated Fatigue and Cognitive Dysfunction." Dr. Chew. (Primary Committee is Cancer Survivorship. Secondary Committees are Symptom Control / QOL and Breast.)

## Committee Process

- Sign meeting attendance list
- Committee communication between Group Meetings

CCOP Renewal: Update

Announcements

## Publications

The publications listed below are those that have been received in published, submitted or accepted form by the Group Chair's Office since the Spring 2011 meeting agenda booklet publication list.

## Published/Accepted Manuscripts

- R0214 Phase III trial of prophylactic cranial irradiation compared with observation in patients with locally advanced non-small-cell lung cancer: neurocognitive and quality of life analysis. A Sun, K Bae, E Gord, B Movsas, S Wong, CA Meyers, J Bonner, S Schild, L Gaspar, J Bogart, M Werner-Wasik, H Choy. Journal of Clinical Oncology 29:279-286, 2011.

## Submitted Manuscripts

- S9217 Health-related quality of life findings for the Prostate Cancer Prevention Trial. CM Moinpour, AK Darke, GW Donaldson, D Cespedes, CR Johnson, PA Ganz, DL Patrick, JE Ware, SA Shumaker, FL Meyskens, IM Thompson. Journal of the National Cancer Institute, submitted 8/11.



**Cancer Control and Prevention Committees  
Cumulative Accrual by Institution and Study  
For the Period Ending August 17, 2011**

	C90203	S0230	S0421	S0424	S0622	S0701	S0702	S0715	S1007
Arizona, U of	-	-	5	1	-	-	-	-	-
Arkansas, U of	-	-	1	13	8	-	1	6	-
Atlanta Reg CCOP	-	-	14	6	-	-	1	7	1
BAMC/WHMC	1	1	5	3	1	-	6	1	-
Bay Area CCOP	-	-	-	-	1	-	-	5	-
Baylor College	-	-	19	-	-	-	-	-	-
Beaumont CCOP	-	-	-	8	1	-	25	7	-
Boston Univ Med Ctr	-	-	4	4	2	-	-	1	-
Catholic U of Chile	-	-	-	-	-	277	-	-	-
Central IL CCOP	-	-	17	7	8	-	79	4	-
Centro de Invest	-	-	-	-	-	241	-	-	-
Cincinnati MC, U of	-	-	12	21	-	-	2	-	-
City of Hope Med Ctr	10	2	51	19	-	-	2	-	-
Cleveland Clinic OH	-	3	1	1	2	-	9	18	-
Colorado, U of	11	-	16	7	7	-	12	12	-
Columbia River CCOP	-	-	9	10	-	-	32	3	-
Columbia Univ-UCOP	-	-	1	-	-	-	-	-	-
Columbia University	-	2	9	54	-	-	10	8	-
Columbus CCOP	-	1	-	15	3	-	14	1	-
DC United MBCCOP	-	-	-	2	-	-	-	-	-
Davis, U of CA	6	2	42	85	5	-	7	26	2
Dayton CCOP	-	1	11	14	-	-	5	1	1
Fundacion Inciensa	-	-	-	-	-	276	-	-	-
Galveston, U of TX	-	-	-	-	-	-	1	-	-
Grand Rapids CCOP	-	-	4	-	-	-	16	9	-
Greenville CCOP	-	1	-	30	-	-	15	9	-
Gulf Coast MBCCOP	-	-	-	-	-	-	7	-	2
H Lee Moffitt CC	2	-	8	19	-	-	53	4	-
Harrington CC	-	-	-	-	-	-	4	6	-
Hawaii MBCCOP, U of	-	-	6	39	-	-	25	3	-
Henry Ford Hosp	1	1	19	3	-	-	18	6	-
Hosp de Occidente	-	-	-	-	-	259	-	-	-
Inst Tecno de Sonora	-	-	-	-	-	249	-	-	-
Irvine, U of CA	-	-	1	5	-	-	4	1	-
KaiserPermanenteNCAL	-	-	-	8	-	-	-	69	-
Kansas City CCOP	-	-	4	5	-	-	18	-	-
Kansas, U of	9	1	32	10	-	-	18	1	-
King Faisal Spec Hos	-	3	-	-	-	-	-	-	-
LSU-New Orleans CCOP	2	-	6	-	-	-	-	1	-
LSU-Shreveport CCOP	1	-	2	-	-	-	-	7	-
Loyola University	10	2	24	17	2	-	45	10	3
MD Anderson	3	2	-	-	-	-	-	-	4

**Cancer Control and Prevention Committees  
Cumulative Accrual by Institution and Study  
For the Period Ending August 17, 2011**

	C90203	S0230	S0421	S0424	S0622	S0701	S0702	S0715	S1007
MUSC, Hollings CC	-	-	7	-	-	-	5	-	-
Michigan CRC CCOP	2	-	9	9	9	-	21	29	-
Michigan, U of	-	3	18	-	13	-	17	21	3
Mississippi, Univ of	-	-	8	5	1	-	28	3	-
Montana CCOP	-	2	10	15	6	-	12	2	-
Natl Inst Public Hlt	-	-	-	-	-	301	-	-	-
Nevada Cancer Inst	-	-	2	-	-	-	2	-	-
New Mexico MBCCOP	1	-	-	-	2	-	4	11	1
Northwest CCOP	-	-	14	7	1	-	18	12	1
Oregon Hlth Sci Univ	-	3	-	13	-	-	9	1	-
Ozarks Reg CCOP	-	2	1	19	-	-	-	10	-
Providence Hosp	-	-	3	8	-	-	2	4	-
Puget Sound	1	2	16	34	-	-	34	16	2
Rochester, Univ of	2	1	7	19	3	-	-	-	-
San Antonio, U of TX	-	-	24	7	1	-	10	-	1
Santa Rosa CCOP	-	-	-	5	-	-	-	-	-
Scott & White CCOP	-	-	8	-	-	-	7	-	-
So Calif, U of	3	6	48	1	-	-	-	21	-
Southeast CCC CCOP	-	2	16	37	2	-	37	25	3
Southern Nevada CCOP	-	-	3	-	1	-	4	1	-
St Louis CCOP	-	-	5	12	-	-	14	12	1
St Louis University	-	-	-	3	-	-	3	-	-
Tennessee, U of	-	2	16	2	-	-	1	-	-
Tulane University	-	-	-	-	-	-	-	-	1
Univ del Valle	-	-	-	-	-	256	-	-	-
Upstate Carolina	1	-	3	18	5	-	8	3	-
Utah, U of	-	-	31	9	-	-	13	-	-
Virginia Mason CCOP	7	-	7	2	1	-	38	11	-
Wayne State Univ	4	-	12	6	-	-	5	-	1
Western Reg CCOP	-	-	-	4	-	-	-	-	-
Wichita CCOP	-	8	7	16	-	-	136	29	5
ACOSOG	-	-	4	28	-	-	-	-	-
ANZ BCTG/ IBCSG	-	58	-	-	-	-	-	-	-
CALGB	-	14	113	99	-	-	97	-	7
CTSU-NOS	-	-	17	1	-	-	-	-	-
ECOG	-	86	200	56	-	-	88	-	6
FSS/ IBCSG	-	46	-	-	-	-	-	-	-
NCCTG	-	-	84	52	-	-	106	-	2
NSABP	-	-	13	13	-	-	4	-	3
RTOG	-	-	9	75	-	-	2	-	-
<b>Total</b>	<b>77</b>	<b>257</b>	<b>1,038</b>	<b>981</b>	<b>85</b>	<b>1,859</b>	<b>1,154</b>	<b>437</b>	<b>50</b>

Note: Some studies may not be listed because they were either closed prior to July 1, 2010 or because they are currently active but have not had any accrual through August 17, 2011.

**SELECT Ancillary Studies**  
**Cumulative Accrual by Institution and Study**  
**For the Period Ending August 17, 2011**

	S0000B	S0000D
Abramson Cancer Ctr	13	23
Anne Arundel Med Ctr	5	-
Arizona Cancer Ctr	-	100
Baptist Regional	10	-
Bassett Research Ins	6	-
Bay Area CCOP	18	1
Carle Cancer Center	2	5
Cascadia Cancer Prev	95	165
Cedar Rapids CCOP	15	30
Christiana Care Hlth	7	-
Colorado Ca Res Prog	8	52
Colorado, Univ of	56	-
Duluth CCOP	42	80
Fox Chase Cancer Ctr	26	37
Geisinger Clinic	-	77
George Washington U	74	208
Good Samaritan Hosp	22	-
Grand Rapids CCOP	-	167
Greenville CCOP	-	68
Harbor-UCLA	-	54
Harrington CC	10	-
Hawaii CCOP	15	-
Hem-Onc Assoc of CNY	5	41
Henry Ford Hosp	10	51
Huntington Mem Hosp	5	-
Illinois, Univ of	350	420
Iowa Oncology CCOP	48	70
Ireland Cancer Ctr	7	-
Kaiser Permanente-GA	3	-
Kaiser-Oakland	5	-
Kalamazoo CCOP	-	70
Kansas City CCOP	-	26
Kimmel Cancer Ctr	5	-
Knoxville, U of TN	19	47
Kootenai Cancer Ctr	6	-

**SELECT Ancillary Studies**  
**Cumulative Accrual by Institution and Study**  
**For the Period Ending August 17, 2011**

	\$00000B	\$00000D
Lawrence & Mem Hosp	7	-
Lehigh Valley Hosp	5	-
Lionel B. Katchem	6	-
Los Angeles, U of CA	11	-
Loyola University	7	-
MD Anderson	96	225
Main Line/Lankenau	1	-
Martin Memorial CC	3	-
MeritCare Hosp CCOP	39	88
Methodist, Dallas	1	10
Metro-Minnesota CCOP	19	102
Mississippi, Univ of	36	88
Montana CCOP	6	-
Mount Sinai CCOP	-	54
NY Methodist Hosp	4	-
Northern Indiana CRC	37	25
Northwestern Univ	21	18
Ohio State Univ	2	-
Oregon Hlth Sci Univ	19	-
SELECT Coord Center	-	10
SUNY Stony Brook	45	-
SW Cancer & Res Ctr	3	-
San Antonio, U of TX	-	49
San Diego, U of CA	-	306
Sanford Cancer Ctr	27	37
Schiffler Cancer Ctr	-	49
Scott & White CCOP	25	-
Southeast CCC CCOP	80	238
Southern Nevada CCOP	16	50
St Luke's Mt State	29	-
St Vincent Hospital	-	68
Stormont-Vail Health	26	75
Summa Health System	8	-
Swedish Medical Ctr	150	263
Thompson Ca Surv Ctr	18	-

**SELECT Ancillary Studies**  
**Cumulative Accrual by Institution and Study**  
**For the Period Ending August 17, 2011**

	\$0000B	\$0000D
Toledo CCOP	44	68
Trinitas Hospital	-	16
Tulane University	-	3
UAB Div of Prev Med	9	14
Upstate Carolina	154	568
VAMC Boston	41	-
VAMC Fargo	71	109
VAMC Hines	28	50
VAMC Kansas City	22	-
VAMC Loma Linda	8	-
VAMC Minneapolis	84	3
VAMC Syracuse	8	-
VAMC Washington DC	19	25
Vancouver Hospital	47	-
Vermont Cancer Ctr	1	-
Virginia Mason CCOP	4	-
WNY Urology Assoc	3	-
Walter Reed AMC	42	-
Washington Univ	18	-
Wichita CCOP	82	143
Wilford Hall Med Ctr	78	150
William Beau Hosp	26	108
York Cancer Center	13	-
<b>Total</b>	<b>2,436</b>	<b>4,804</b>

Note: Some studies may not be listed because they were either closed prior to July 1, 2009 or because they are currently active but have not had any accrual through August 17, 2011.

# EARLY THERAPEUTICS COMMITTEE

## Committee Leadership

Chair:	Razelle Kurzrock, M.D.
Executive Officer:	Bruce Redman, D.O.
Statisticians:	Antje Hoering, Ph.D. Megan Othus, Ph.D. Rachael Sexton, M.S. Danika Lew, M.A.

## Designates

Clinical Research Associate:	Corrine Turrell
Data Coordinators:	Laura Kingsbury Christine McLeod
Nurse:	Margaret Ward, R.N., B.S.N.
Pharmaceutical Science:	Siu-Fun Wong, Pharm.D.
Liaisons	
Breast Committee:	Francisco Esteva, M.D.
Genitourinary Committee:	Neeraj Agarwal, M.D.
Lung Committee:	Shirish M. Gadgeel, M.D.
Lymphoma Committee:	Daruka Manadevan, M.D., Ph.D.
Melanoma Committee:	Ragini R. Kudchadkar, M.D.
Myeloma Committee:	Frits van Rhee, M.D., Ph.D.
Protocol Coordinator:	Sandi Fredette

## Time/Location

**Thursday, October 13, 2011**

Room: Regency Center (Ballroom Level)

3:30 p.m. – 4:30 p.m.

## Agenda

Introduction to Early Therapeutics

### Active Studies

- S0711, "A Phase I Trial of Dasatinib (BMS-354825) in Patients with Advanced Malignancies and Varying Levels of Liver Dysfunction." Dr. Sarantopoulos. Activated: 10/15/08.

### New Concepts

- "A Phase I Study of an EMD c-Met Inhibitor and Bevacizumab in Patients with Advanced Malignancies" Dr. Fu.

Open Discussion

**No publication information for this cycle.**

## Early Therapeutics Committee Cumulative Accrual by Institution and Study For the Period Ending August 17, 2011

	S0711	S0916
City of Hope Med Ctr	1	-
Davis, U of CA	1	-
Henry Ford Hosp	7	-
Kansas, U of	3	-
Kentucky, U of	-	5
MUSC, Hollings CC	-	2
Michigan, U of	-	10
New Mexico MBCCOP	-	5
San Antonio, U of TX	33	1
Scott & White CCOP	2	-
So Calif, U of	7	-
Wichita CCOP	-	21
<b>Total</b>	<b>54</b>	<b>44</b>

Note: Some studies may not be listed because they were either closed prior to July 1, 2010 or because they are currently active but have not had any accrual through August 17, 2011.

# GASTROINTESTINAL COMMITTEE

## Committee Leadership

Chair:	Charles D. Blanke, M.D.
Vice-Chair:	Heinz-Josef Lenz, M.D.
Executive Officer:	Bruce Redman, D.O.
Statisticians:	Jacqueline K. Benedetti, Ph.D. Bryan Goldman, M.S. Holly Gundacker, M.S. Cathryn Rankin, M.S.

## Scientific Leadership

Gastroesophageal:	Syma Iqbal, M.D. Lawrence P. Leichman, M.D. Scott A. Hundahl, M.D. (Surgical representative)
Pancreatic:	Philip A. Philip, M.D., Ph.D. Andrew M. Lowy, M.D. (Surgical representative)
Hepatobiliary:	Anthony B. El-Khoueiry, M.D. Edgar Ben-Josef, M.D. Syed Ahmad, M.D. (Surgical representative)
Colorectal:	Philip J. Gold, M.D. Anthony F. Shields, M.D., Ph.D. Kevin G. Billingsley, M.D. (Surgical representative)
Translational Medicine:	Christopher L. Corless, M.D., Ph.D. Heinz-Josef Lenz, M.D.
Drug Development:	Ramesh Ramanathan, M.D. Sunil Sharma, M.D.
Radiation Oncology:	Lisa A. Kachnic, M.D.
<b>Designates</b>	
Cancer Control Liaison:	Jason A. Zell, D.O.
Clinical Research Associate:	Michelle King, R.H.I.A.
Data Coordinators:	Stephanie Edwards Christine McLeod Rodney Sutter
Nurses:	Rita Kaul, R.N., B.S.N. Valerie A. Parks, R.N.
Patient Advocates:	Mortimer Brown, Ph.D. Porsha James, M.P.H.
Pharmaceutical Science:	Craig Elg, Pharm.D. Holly O. Chan, Pharm.D.
Protocol Coordinator:	Kimberly Kaberle

## Time/Location

**Friday, October 14, 2011**

Room: Regency East #3 (Ballroom Level)

5:00 p.m. – 7:00 p.m.

## Agenda

### Presentation

**Cancer Survivorship Committee** - Robert S. Krouse, M.D.,  
Committee Co-chair

### Gastroesophageal

#### Active Studies

- S1005, "A Phase II Study of MK-2206 (NSC-749607) as Second Line Therapy for Advanced Gastric and Gastroesophageal Junction Cancer." Drs. Ramanathan and Kennecke. Activated: 1/1/11.
- CTSU/RTOG R1010, "A Phase II Trial Evaluating the Addition of Trastuzumab to Trimodality Treatment of HER2-Overexpressing Esophageal Adenocarcinoma." Dr. L. Leichman. Activated: 9/1/11.

#### Proposed Studies

- S1201, "A Randomized Phase II Pilot Study Prospectively Evaluating Treatment for Patients Based on ERCC1 for Advanced/Metastatic Esophageal, Gastric, or Gastroesophageal (GE) Junction Cancer." Dr. Iqbal.
- "A Randomized Phase II Study to Evaluate the OS Benefit of Lapatinib with Docetaxel versus Doxorubicin as Second Line Therapy in Trastuzumab Resistant HER2 Positive Gastric Cancer Patients." Drs. Barzi and Lenz.

### Pancreatic

#### Active Studies

- CTSU/RTOG 0848, "A Phase III Trial Evaluating Both Erlotinib and Chemoradiation as Adjuvant Treatment for Patients with Resected Head of Pancreas Adenocarcinoma." Dr. Philip. Activated: 12/15/09.

#### Closed Studies

- S0727, "A Phase I and Randomized Phase II Trial of Gemcitabine + Erlotinib (NSC-718781) + IMC-A12 (NSC-742460) vs. Gemcitabine + Erlotinib as First-Line Treatment in Patients with Metastatic Pancreatic Cancer." Drs. Philip and Lenz. Activated: 3/1/08; Closed: 9/1/10.

#### Proposed Studies

- S1112, "A Phase II Randomized Study of FOLFIRINOX versus FOLFOX in Patients with Metastatic Pancreatic Adenocarcinoma." Drs. Ramanathan and Fine.

# GASTROINTESTINAL COMMITTEE

- S1115, "Randomized Phase II Clinical Trial of AZD-6244 and MK-2206 vs mFOLFOX in Patients with Metastatic Pancreatic Cancer After Prior Chemotherapy." Dr. Chung.

## Hepatobiliary

### Active Studies

- S0809, "A Phase II Trial of Adjuvant Capecitabine / Gemcitabine Chemotherapy Followed by Concurrent Capecitabine and Radiotherapy in Extrahepatic Cholangiocarcinoma (EHCC)." Drs. Ben-Josef, Zalupski, Lowy and Corless. Activated: 12/1/08.
- CTSU/E1208, "A Phase III Randomized, Double-Blind Trial of Chemoembolization with or without Sorafenib in Unresectable Hepatocellular Carcinoma (HCC) in Patients with and without Vascular Invasion." Dr. El-Khoueiry. Activated: 7/15/10.
- CTSU/C80802, "Phase III Randomized Study of Sorafenib Plus Doxorubicin Versus Sorafenib in Patients with Advanced Hepatocellular Carcinoma (HCC)." Dr. Siegel. Activated: 6/1/11.

### Closed Studies

- S0941, "Phase II Study of Sorafenib (NSC-724772) and Erlotinib (NSC-718781) in Patients with Advanced Gallbladder Carcinoma or Cholangiocarcinoma." Drs. El-Khoueiry and Iqbal. Activated: 4/15/10; Closed: 9/15/11.

## Colorectal

### Active Studies

- S0713, "A Phase II Study of Oxaliplatin, Capecitabine, Cetuximab and Radiation in Pre-Operative Therapy of Rectal Cancer." Drs. G. Leichman, Smalley, Billingsley and Lenz. Activated: 2/1/09.
- S0820, "A Double Blind Placebo-Controlled Trial of Eflornithine and Sulindac to Prevent Recurrence of High Risk Adenocarcinomas and Second Primary Colorectal Cancers in Patients with Stage 0-III Colon Cancer, Phase III." Dr. Zell. Distributed for IRB review only: 4/15/11.
- CTSU/C80405, "A Phase III Trial of Irinotecan / 5-FU / Leucovorin or Oxaliplatin / 5-FU / Leucovorin with Bevacizumab, or Cetuximab (C225), or with the Combination of Bevacizumab and Cetuximab for Patients with Untreated Metastatic Adenocarcinoma of the Colon or Rectum." Dr. Blanke. Activated: 10/1/05.

- CTSU/C80702, "A Phase III Trial of 6 versus 12 Treatments of Adjuvant FOLFOX plus Celecoxib or Placebo for Patients with Resected Stage III Colon Cancer." Dr. Shields. Activated: 8/15/10.

### Closed Studies

- S0600, "Phase III Trial of Irinotecan-Based Chemotherapy Plus Cetuximab (NSC-714692) or Bevacizumab (NSC-704865) as Second-Line Therapy for Patients with Metastatic Colorectal Cancer who have Progressed on Bevacizumab with Either FOLFOX, OPTIMOX or XELOX." Drs. Gold, Grothey and Shields. Activated: 6/15/07; Closed: 11/10/10.

## Other

### Active Studies

- S0518, "Phase III Prospective Randomized Comparison of Depot Octreotide Plus Interferon Alpha Versus Depot Octreotide Plus Bevacizumab (NSC #704865) in Advanced, Poor Prognosis Carcinoid Patients." Drs. Yao, Kvols and Moran. Activated: 12/1/07.

### Correlative Studies

- S0205A-ICSC, "Predictive and Prognostic Value of Tumor K-ras Mutation Status, Amphiregulin and Epiregulin and Gene Expression Levels and Germline Polymorphisms Involved in the EGFR and Gemcitabine Pathway in Advanced Pancreas Cancer: A Pilot Study of Tissues from Southwest Oncology Group Study S0205." Dr. Lenz.

### Proposed Studies

- "A Randomized Phase II International Study Assessing Adjuvant Standard and High-Dose Imatinib Mesylate Treatment in Fully Resected Intermediate and High-Risk GIST Patients with KIT Exon 9 Mutations." Dr. Blanke.
- "A Phase II Study of Trastuzumab and mFOLFOX6 as First Line Therapy of HER2-Positive Advanced Gastric or Gastroesophageal Cancer." Dr. Lenz.
- Pilot esophageal study assessing treatment based on ERCC-1 data. Dr. L. Leichman.
- Borderline unresectable locally advanced pancreas. Drs. Esnaola and Ahmad.
- Frankly unresectable locally advanced pancreas – MK-2206 and FOLFOX. Dr. Esnaola.



# GASTROINTESTINAL COMMITTEE

- Colon Targeted Therapy Pilot. Drs. Lenz and Shields.
- Phase II NCCTG Cholangiocarcinoma: Concept for metastatic disease involving IMC112 and PARP inhibitor.
- Phase II trial of Afibercept in sorafenib refractory patients with advance hepatocellular carcinoma. Dr. Kim.

## Publications

The publications listed below are those that have been received in published, submitted or accepted form by the Group Chair's Office since the Spring 2011 meeting agenda booklet publication list.

### Published/Accepted Manuscripts

- S9041 Colorectal chemoprevention pilot study (SWOG-9041), randomized and placebo controlled: the importance of multiple luminal lesions. D Chu, M Hussey, D Alberts, F Meyskens, C Fenoglio-Preiser, S Rivkin, G Mills, J Giguere, C Blanke, G Goodman. Clinical Colorectal Cancer, 2011 Jul 20 [Epub ahead of print]. (N.B.: also listed under Prevention Committee)
- S0202 A phase II trial of gemcitabine and capecitabine in patients with unresectable or metastatic gallbladder cancer or cholangiocarcinoma: Southwest Oncology Group study S0202. S Iqbal, C Rankin, HJ Lenz, PJ Gold, S Ahmad, A El-Khoueiry, M Messino, R Holcombe, CD Blanke. Cancer Chemotherapy and Pharmacology, 2011 May 10 [Epub ahead of print].
- S0356 Therapy of adenocarcinoma of the esophagus with oxaliplatin, 5-fluorouracil and external beam radiation therapy prior to surgery: a report of SWOG trial S0356. LP Leichman, B Goldman, C Thomas, K Billingsley, C Corless, J Benedetti, HJ Lenz, S Iqbal, P Gold, CD Blanke. Journal of Clinical Oncology, accepted 8/8/11.
- S0413 Southwest Oncology Group study S0413: a phase II Trial of GW572016 (lapatinib) as first line therapy in patients with advanced or metastatic gastric cancer. S Iqbal, B Goldman, C Fenoglio-Preiser, HJ Lenz, W Zhang, KD Dannenberg, S Shibata, C Blanke. Annals of Oncology, 2011 May 20 [Epub ahead of print].
- S0514 SWOG 0514: A phase II study of sorafenib in patients with resectable or metastatic gallbladder carcinoma and cholangiocarcinoma. A El-Khoueiry, C Rankin, E Ben-Josef, HJ Lenz, PJ Gold, RD Hamilton, R Govindarajan, C Eng, CD Blanke. Investigational New Drugs, 2011 Jul12 [Epub ahead of print]
- C89803 Relationship between statin use and colon cancer recurrence and survival: results from CALGB 89803. K Ng, S Ogino, J Meyerhardt, J Chan, D Niedzwiecki, D Hollis, LB Saltz, RJ Mayer, AB Benson, PL Schaefer, R Whittom, A Hantel, RM Goldberg, M Bertagnolli, AP Venook, CS Fuchs. Journal of the National Cancer Institute, 2011 Aug 17 [Epub ahead of print]. (N.B.: also listed under Prevention Committee)

### Submitted Manuscripts

- S9008 Updated analysis of SWOG-directed intergroup study 0116: a phase III trial of adjuvant radiochemotherapy versus observation following curative gastric cancer resection (CALGB-9195; ECOG-6290; NCCTG-90-41-51; RTOG 9018 and SWOG 9008. S Smalley, J Benedetti, D Haller, S Hundahl, N Estes, J Ajani, L Gunderson, B Goldman, J Martenson, J Jessup, G Stemmermann, C Blanke, J Macdonald. Journal of Clinical Oncology, pending response to reviewers' comments, 8/11.
- S0414 Cetuximab plus cisplatin, irinotecan, and thoracic radiotherapy as definitive treatment for locally advanced, unresectable esophageal cancer: a phase II study of the SWOG (S0414). MB Tomblyn, BH Goldman, CR Thomas, JK Benedetti, HJ Lenz, V Mehta, T Beeker, PJ Gold, JL Abbruzzese, CD Blanke. Journal of Thoracic Oncology, submitted 8/20/11.

**Gastrointestinal Committee**  
**Cumulative Accrual by Institution and Study**  
**For the Period Ending August 17, 2011**

	C80405	C80702	E1208	E5202	R04	R0848	S0518	S0600	S0713	S0727	S0809	S0941	S1005
Arizona, U of	-	-	-	-	-	-	-	-	1	-	-	1	-
Arkansas, U of	9	-	4	8	-	-	3	-	-	1	1	4	-
Atlanta Reg CCOP	30	-	-	38	-	-	-	-	-	2	1	-	-
BAMC/WHMC	8	-	-	17	4	-	-	-	-	1	-	-	-
Bay Area CCOP	-	-	-	-	-	-	-	-	-	1	-	-	-
Baylor College	4	3	-	2	-	-	-	-	3	2	-	-	-
Beaumont CCOP	10	-	-	7	-	-	-	-	-	1	-	-	-
Boston Univ Med Ctr	6	-	-	-	-	-	1	1	-	8	2	1	-
Cedars-Sinai Med Ctr	-	-	-	-	-	-	1	-	-	-	-	-	-
Central IL CCOP	16	4	-	-	-	-	9	2	6	8	-	2	-
Cincinnati MC, U of	-	-	-	-	-	-	7	-	-	-	2	-	-
City of Hope Med Ctr	26	-	-	-	-	-	-	3	-	5	-	-	-
Cleveland Clinic OH	11	-	-	4	-	-	1	-	-	-	-	-	-
Colorado, U of	4	1	1	10	-	-	3	-	-	4	-	-	-
Columbia River CCOP	7	-	-	2	-	-	5	-	-	-	3	-	-
Columbia University	1	-	-	6	4	-	4	-	3	-	-	-	-
Columbus CCOP	12	2	-	-	-	-	4	4	-	-	-	-	-
Davis, U of CA	49	4	-	6	3	-	9	1	1	6	1	9	-
Dayton CCOP	6	-	-	1	-	-	-	3	3	-	1	1	-
Galveston, U of TX	13	-	-	-	-	-	-	-	-	-	-	-	-
Grand Rapids CCOP	-	-	-	2	-	-	-	1	-	8	-	-	1
Greenville CCOP	-	-	-	23	-	1	5	-	-	-	-	-	-
Gulf Coast MBCCOP	-	-	-	1	-	-	-	-	-	4	-	-	-
H Lee Moffitt CC	11	1	-	10	6	-	19	-	-	4	-	-	-
Harrington CC	3	-	-	3	3	-	-	-	-	-	-	-	-
Hawaii MBCCOP, U of	29	6	-	10	-	-	-	-	-	-	-	1	-
Henry Ford Hosp	-	-	-	-	-	-	-	-	1	-	-	-	-
Irvine, U of CA	8	6	-	8	1	-	-	3	-	1	-	3	1
KaiserPermanenteNCAL	5	12	-	-	-	-	-	-	-	-	-	-	-
Kansas City CCOP	-	-	-	-	-	-	-	-	-	14	-	2	-
Kansas, U of	32	6	-	12	11	1	4	-	-	-	2	-	1
Kentucky, U of	-	1	-	-	-	-	-	-	-	-	-	-	-
LSU-New Orleans CCOP	12	2	-	-	-	-	1	-	-	-	-	-	-
LSU-Shreveport	1	-	-	-	-	-	-	-	-	-	-	-	-
LSU-Shreveport CCOP	6	-	-	3	2	-	-	-	-	1	-	-	-
Loyola University	4	2	-	19	-	1	-	-	-	-	2	5	-

**Gastrointestinal Committee**  
**Cumulative Accrual by Institution and Study**  
**For the Period Ending August 17, 2011**

	C80405	C80702	E1208	E5202	R04	R0848	S0518	S0600	S0713	S0727	S0809	S0941	S1005
MD Anderson	18	-	-	5	-	-	39	-	-	-	-	-	-
MUSC, Hollings CC	-	-	-	-	-	-	-	1	-	8	3	2	-
Michigan CRC CCOP	1	-	-	-	-	-	4	1	-	-	-	1	-
Michigan, U of	-	-	1	1	-	-	8	-	-	5	5	-	-
Mississippi, Univ of	11	1	-	21	-	-	6	2	-	-	-	1	-
Montana CCOP	2	1	-	4	-	-	2	3	-	1	-	1	-
Nevada Cancer Inst	2	-	-	-	-	-	-	-	-	-	-	-	-
New Mexico MBCCOP	-	-	-	-	-	-	12	-	-	5	-	-	-
Northwest CCOP	13	-	-	8	-	-	2	-	-	-	-	-	-
Oregon Hlth Sci Univ	6	1	-	2	3	-	-	-	-	2	-	-	-
Ozarks Reg CCOP	6	2	-	5	-	-	6	1	-	-	-	-	2
Providence Hosp	11	1	1	10	-	-	-	-	-	-	-	-	-
Puget Sound	28	3	-	15	-	-	6	6	1	4	-	1	1
Rochester, Univ of	16	-	-	5	-	-	2	-	7	3	-	-	3
San Antonio, U of TX	18	-	-	6	-	-	-	-	-	1	-	-	-
Santa Rosa CCOP	1	-	-	2	-	-	-	-	-	-	-	-	-
Scott & White CCOP	6	-	-	-	-	-	-	2	-	2	-	-	-
So Calif, U of	62	4	1	25	-	-	7	9	9	9	3	4	-
Southeast CCC CCOP	-	-	-	17	-	-	5	-	3	10	-	-	-
Southern Nevada CCOP	-	-	-	-	-	-	3	-	-	-	-	-	-
St Louis CCOP	1	-	-	7	-	-	8	-	-	-	-	-	-
St Louis University	4	-	-	1	-	-	2	-	-	3	-	-	1
Tennessee, U of	25	-	-	5	6	-	2	1	-	-	-	-	-
Upstate Carolina	7	-	-	5	-	-	-	1	1	-	1	-	-
Utah, U of	17	1	-	17	3	-	-	-	-	2	-	-	-
Virginia Mason CCOP	4	-	-	1	-	-	1	-	-	-	-	-	-
Wayne State Univ	30	6	-	8	3	-	-	2	-	8	3	-	-
Wichita CCOP	-	1	-	-	-	-	14	1	5	-	3	1	-
ACOSOG	-	-	-	-	-	-	-	-	-	-	2	-	-
CALGB	-	-	-	-	-	-	64	2	-	-	12	-	-
ECOG	-	-	-	-	-	-	32	7	-	-	12	-	-
NCCTG	-	-	-	-	-	-	31	12	-	-	4	-	-
NSABP	-	-	-	-	-	-	4	3	-	-	-	-	-
RTOG	-	-	-	-	-	-	-	-	-	-	14	-	-
<b>Total</b>	<b>612</b>	<b>71</b>	<b>8</b>	<b>362</b>	<b>49</b>	<b>3</b>	<b>336</b>	<b>72</b>	<b>44</b>	<b>134</b>	<b>77</b>	<b>40</b>	<b>10</b>

Note: Some studies may not be listed because they were either closed prior to July 1, 2010 or because they are currently active but have not had any accrual through August 17, 2011.

# GENITOURINARY COMMITTEE

## Committee Leadership

Chair:	Ian M. Thompson, Jr., M.D.
Vice-Chair:	Nicholas J. Vogelzang, M.D.
Executive Officer:	Bruce Redman, D.O.
Statisticians:	Cathy M. Tangen, Dr.P.H. Benjamin W. Ely, M.S.

## Scientific Leadership

Translational Medicine:	David J. McConkey, Ph.D.
Radiation Oncology:	David Raben, M.D.
Surgery:	Daniel J. Culkin, M.D.
Medical Oncology:	Celestia S. Higano, M.D.
Pathology:	M. Scott Lucia, M.D.
Liaison to the SPORES:	Colin P.N. Dinney, M.D.
Early Therapeutics:	Neeraj Agarwal, M.D.

## Designates

Clinical Research Associates:	Debra W. Christie, M.B.A. Jean M. Sauvain Peter J. Van Veldhuizen, M.D.
Cancer Control:	Jean Barce Brian Zeller
Data Coordinators:	TBD
Nurses:	Rick Bangs
Patient Advocate:	Gilland Dea, Pharm.D.
Pharmaceutical Science:	Jessie Modlin, Pharm.D.
Protocol Coordinator:	Jennifer I. Scott

## Time/Location

### Saturday, October 15, 2011

Room: Regency West (Ballroom Level)  
11:30 a.m. – 3:00 p.m.

## Agenda

**“Use of Molecular Markers in Clinical Trials.”** - David J. McConkey, Ph.D., Chair, GU Translational Medicine Subcommittee

**“Evidence Needed for Prognostic and Predictive Factors: A Statistical Perspective.”** - Cathy M. Tangen, Dr.P.H., GU Biostatistician

## Priority Studies

- S1107, “Parallel (Randomized) Phase II Evaluation of ARQ 197 and ARQ 197 in Combination with Erlotinib in Papillary Renal Cell Carcinoma.”
- S11XX, “Phase III Randomized Trial Comparing LHRHa + TAK-700 With LHRHa + Bicalutamide In Patients With Newly Diagnosed D2 Prostate Cancer.”

 **SWOG • Leading Cancer Research. Together.**

- S11XX, “COXEN (Coexpression Extrapolation) Directed Neoadjuvant Chemotherapy for Bladder Cancer.”
- Evans Transformative Prostate Trial
- Mims/Heath Transformative Renal Trial

## Bladder

Organ Site Chairs: Drs. Daniel P. Petrylak (Advanced) and Seth P. Lerner (Local)

## Active Studies

- S0337, “A Phase III Blinded Study of Immediate Post-TURBT Instillation of Gemcitabine versus Saline in Patients with Newly Diagnosed or Occasionally Recurring Grade I/II Superficial Bladder Cancer.” Drs. Messing, Sahasrabudhe, Koppie, Wood and Mack. Activated: 7/15/07.
- S1011, “A Phase III Surgical Trial to Evaluate the Benefit of a Standard Versus an Extended Pelvic Lymphadenectomy Performed at Time of Radical Cystectomy for Muscle Invasive Urothelial Cancer.” Drs. Lerner, Koppie, Alva and Svatek, and R. Bangs. Activated: 8/1/11.
- CTSU/C90601, “A Randomized Double-Blinded, Phase III Study Comparing Gemcitabine, Cisplatin, and Bevacizumab to Gemcitabine, Cisplatin, and Placebo in Patients with Advanced Transitional Cell Carcinoma.” Dr. Flaig. Activated: 8/15/09.
- CTSU/R0524, “A Phase I/II Trial of a Combination of Paclitaxel and Trastuzumab with Daily Irradiation or Paclitaxel Alone with Daily Irradiation Following Transurethral Surgery for Non-Cystectomy Candidates with Muscle-Invasive Bladder Cancer.” Dr. Swanson. Activated: 12/15/06.

## Prostate

Organ Site Chairs: Drs. Maha H.A. Hussain (Advanced) and Martin E. Gleave and David Raben (Local)

## Active Studies

- S0925, “A Phase II Randomized Study of Combined Androgen Deprivation versus Combined Androgen Deprivation with IMC-A12 for Patients with New Hormone-Sensitive Metastatic Prostate Cancer.” Drs. Yu and Higano. Activated: 12/15/10.

# GENITOURINARY COMMITTEE

- S1014, "Abiraterone Acetate Treatment for Prostate Cancer Patients with a PSA of More Than Four Following Initial Androgen Deprivation Therapy, Phase II." Drs. Flaig and Hussain. Activated: 8/9/11.
- CTSU/C90202, "A Randomized Double-Blind, Placebo-Controlled Phase III Study of Early versus Standard Zoledronic Acid to Prevent Skeletal Related Events in Men with Prostate Cancer Metastatic to Bone." Dr. Bhoopalam. Activated: 8/1/04.
- CTSU/C90203, "A Randomized Phase III Study of Neo-Adjuvant Docetaxel and Androgen Deprivation Prior to Radical Prostatectomy Versus Immediate Radical Prostatectomy in Patients with High-Risk, Clinically Localized Prostate Cancer." Dr. Kim. Activated: 7/1/07.
- CTSU/E3805, "CHAARTED: ChemoHormonal Therapy versus Androgen Ablation Randomized Trial for Extensive Disease in Prostate Cancer." Dr. Garcia. Activated: 9/1/08.

## Closed Studies

- S0421, "Phase III Study of Docetaxel and Atrasentan versus Docetaxel and Placebo for Patients with Advanced Hormone Refractory Prostate Cancer." Drs. Quinn, Hussain, Lara, Garzotto, Mack, Moinpour and Baranowski. Activated: 8/21/06; Closed: 5/1/10.

## Renal Cell

Organ Site Chairs: Drs. Primo N. Lara, Jr. (Advanced) and Edward M. Messing (Local)

## Active Studies

- S0931, "EVEREST: EVerolimus for Renal Cancer Ensuing Surgical Therapy, A Phase III Study." Drs. Ryan, Heath, Lara, Palapattu and Mack. Activated: 4/1/11.

## Proposed Studies

- S1107, "Parallel (Randomized) Phase II Evaluation of ARQ 197 and ARQ 197 in Combination with Erlotinib in Papillary Renal Cell Carcinoma." Dr. Twardowski.

## Cancer Control

Organ Site Chair: Dr. Peter J. Van Veldhuizen

## Active Studies

- S0702, "A Prospective Observational Multicenter Cohort Study to Assess the Incidence of Osteonecrosis of the Jaw (ONJ) in

Cancer Patients with Bone Metastases Starting Zoledronic Acid Treatment." Drs. Van Poznak, Gralow, Bagravian, and Schubert, and Lisa Hansen, R.N. Activated: 12/15/08.

- CTSU/C70807, "The Men's Eating and Living (MEAL) Study: A Randomized Trial of Diet to Alter Disease Progression in Prostate Cancer Patients on Active Surveillance." Dr. Van Veldhuizen. Activated: 6/1/11.

## Publications

The publications listed below are those that have been received in published, submitted or accepted form by the Group Chair's Office since the Spring 2011 meeting agenda booklet publication list.

**All PCPT and SELECT publications are listed under Cancer Control & Prevention Committees.**

## Published/Accepted Manuscripts

- S9917 Selenium supplementation and prostate cancer among men with high grade prostatic intraepithelial neoplasia: SWOG-directed intergroup trial S9917. JR Marshall, C Tangen, W Sakr, DP Wood, D Berry, E Klein, S Lippman, H Parnes, D Alberts, D Jarrard, WR Lee, JM Gaziano, ED Crawford, B Ely, M Ray, W Davis, L Minasian, I Thompson. Cancer Prevention Research, 2011 Sep 6 [Epub ahead of print]. (N.B.: also listed under Prevention Committee)
- S9921 Adjuvant androgen deprivation for high-risk prostate cancer after radical prostatectomy: SWOG S9921. T Dorff, T Flaig, C Tangen, M Hussain, G Swanson, DP Wood, W Sakr, N Dawson, N Haas, ED Crawford, NJ Vogelzang, IM Thompson, LM Glode. Journal of Clinical Oncology, 29(15):2040-2045, 2011.
- S0032 Phase II evaluation of early oral estramustine, oral etoposide and intravenous paclitaxel in combination with hormone therapy in patients with high risk metastatic adenocarcinoma of the prostate: Southwest Oncology Group (SWOG) S0032. DC Smith, C Tangen, PJ Van Veldhuizen, GW Harrer, A Golshayan, GM Mills, NJ Vogelzang, IM Thompson, MHA Hussain. Urology, 77(5):1172-1176, 2011.
- 4B951 A phase III study of molecularly targeted adjuvant therapy in locally advanced urothelial cancer of the bladder based on p53 status. W Stadler, SP Lerner, S Groshen, JP Stein, E Tuazon, D Skinner, D Raghavan, D Esrig, G Steinberg, D Wood, L Klotz, C Hall, R Cote. Journal of Clinical Oncology, 29(25):3443-9, 2011.

# GENITOURINARY COMMITTEE

## Submitted Manuscripts

- S8894/S9346 Has survival prognosis of men with newly diagnosed M1 prostate cancer changed over time? A SWOG phase III trial experience (S8894 & S9346). C Tangen, M Hussain, C Higano, M Eisenberger, E Small, G Wilding, B Donnelly, D McLeod, P Schellhammer, ED Crawford, N Vogelzang, I Powell, IM Thompson. Journal of Clinical Oncology, submitted 7/11.
- S9109 Long-term follow-up of neoadjuvant therapy prior to radical prostatectomy for clinical T3/T4 prostate cancer: a Southwest Oncology Group study 9109. RK Berglund, C Tangen, IJ Powell, BA Lowe, GP Haas, PR Carroll, ED Canby-Hagino, RW de Vere White, GP Hemstreet, ED Crawford, IM Thompson, E Klein. Urology, submitted 8/11.

**Genitourinary Committee**  
**Cumulative Accrual by Institution and Study**  
**For the Period Ending August 17, 2011**

	C90202	C90203	C90601	E2804	E2805	E3805	MDA3410	PR11	R0415	R0521	R0524	S0337	S0421	S0925	S0931
Arizona, U of	-	-	-	-	5	-	-	-	-	-	-	-	5	-	-
Arkansas, U of	5	-	3	3	11	1	1	-	-	-	-	-	1	-	-
Atlanta Reg CCOP	-	-	-	-	20	-	-	-	-	-	-	-	14	-	-
BAMC/WHMC	-	1	-	-	11	-	-	-	-	1	-	7	5	-	-
Baylor College	29	-	1	1	4	-	-	-	-	-	-	-	19	-	-
Baylor College-UCOP	-	-	-	-	13	-	-	-	-	-	-	34	-	-	-
Beaumont CCOP	-	-	-	-	8	-	-	1	-	-	-	-	-	-	-
Boston Univ Med Ctr	-	-	-	-	-	2	-	-	-	-	-	-	4	-	-
Cedars-Sinai Med Ctr	-	-	-	-	-	-	-	-	-	-	-	1	-	-	-
Central IL CCOP	-	-	-	-	-	-	-	-	5	-	-	-	17	1	-
Cincinnati MC, U of	1	-	-	-	5	-	-	-	-	-	-	-	12	-	-
City of Hope Med Ctr	-	10	-	-	9	-	-	-	-	-	-	-	51	1	-
Cleveland Clinic OH	-	-	2	1	24	31	-	-	-	-	-	1	1	-	-
Colorado, U of	1	11	7	-	12	7	-	3	-	-	-	13	16	1	-
Columbia River CCOP	-	-	-	-	1	-	-	-	-	-	-	-	9	-	-
Columbia Univ-UCOP	-	-	-	-	-	-	-	-	-	-	-	8	1	-	-
Columbia University	-	-	2	1	12	5	-	-	-	-	-	-	9	-	-
Columbus CCOP	-	-	1	-	-	-	-	-	-	-	-	-	-	-	-
Davis, U of CA	-	6	2	1	28	6	3	-	-	1	-	16	42	-	-
Dayton CCOP	-	-	-	-	2	-	-	-	-	-	-	-	11	1	1
E Virginia UCOP	1	-	-	-	9	-	-	-	-	-	-	-	-	-	-
Galveston, U of TX	-	-	-	-	-	-	1	-	-	-	-	-	-	-	-
Grand Rapids CCOP	-	-	-	4	14	-	-	-	-	-	-	-	4	1	-
Greenville CCOP	-	-	-	-	5	-	-	-	-	4	-	-	-	-	-
Gulf Coast MBCCOP	-	-	-	-	1	-	-	-	-	-	-	-	-	-	-
H Lee Moffitt CC	8	2	-	-	52	-	1	-	-	-	-	-	8	1	-
Hawaii MBCCOP, U of	2	-	-	-	3	-	-	-	-	-	-	-	6	-	-
Henry Ford Hosp	1	1	-	-	3	-	-	-	-	-	-	6	19	-	-
Irvine, U of CA	-	-	-	1	8	-	-	-	-	-	-	-	1	-	-
KaiserPermanenteNCAL	-	-	-	-	9	-	-	-	-	-	-	-	-	-	-
Kansas City CCOP	-	-	-	-	7	-	-	-	-	-	-	-	4	-	-
Kansas, U of	4	9	-	2	19	-	-	-	1	5	3	21	32	2	-
Kentucky, U of	-	-	1	-	3	4	-	-	-	-	-	-	-	-	-
LSU-New Orleans CCOP	-	2	-	-	-	-	-	-	-	-	-	-	6	-	-
LSU-Shreveport CCOP	2	1	-	-	3	-	-	-	-	-	-	14	2	-	-
Loyola University	12	10	-	-	10	3	3	-	-	-	-	6	24	-	-
MD Anderson	-	3	-	-	59	-	-	-	-	-	-	4	-	-	-

**Genitourinary Committee**  
**Cumulative Accrual by Institution and Study**  
**For the Period Ending August 17, 2011**

	C90202	C90203	C90601	E2804	E2805	E3805	MDA3410	PR11	R0415	R0521	R0524	S0337	S0421	S0925	S0931
MUSC, Hollings CC	-	-	1	-	6	-	-	-	-	-	-	-	7	-	-
Michigan CRC CCOP	-	2	1	-	-	-	-	-	-	-	-	-	9	-	-
Michigan, U of	-	-	-	-	13	6	-	-	-	-	-	-	18	4	1
Michigan, U of-UCOP	-	-	-	-	-	-	-	-	-	-	-	23	-	-	-
Mississippi, Univ of	-	-	1	1	12	3	-	-	-	-	-	-	8	-	-
Montana CCOP	-	-	-	-	1	1	-	-	-	-	-	-	10	-	-
Nevada Cancer Inst	-	-	-	-	-	-	-	-	-	-	-	-	2	-	-
New Mexico MBCCOP	-	1	-	-	-	-	-	-	-	-	-	-	-	-	-
Northwest CCOP	1	-	-	-	6	-	-	-	-	-	-	-	14	2	-
Oklahoma, U of-UCOP	-	-	-	-	-	-	-	-	-	-	-	13	-	-	-
Oregon Hlth Sci Univ	-	-	-	-	11	-	-	-	-	-	-	-	-	-	1
Ozarks Reg CCOP	-	-	-	2	2	2	-	-	-	-	-	-	1	-	-
Providence Hosp	-	-	-	1	-	-	-	-	-	-	-	-	3	-	-
Puget Sound	4	1	-	4	30	-	-	-	1	-	-	-	16	10	1
Rochester, Univ of	-	2	-	1	9	1	-	-	-	-	-	38	7	-	-
San Antonio, U of TX	-	-	-	3	18	13	4	-	-	-	-	24	24	-	-
Scott & White CCOP	-	-	-	-	-	-	-	-	-	-	-	-	8	-	-
So Calif, U of	1	3	1	2	10	10	-	-	-	-	-	2	48	-	-
Southeast CCC CCOP	-	-	-	1	24	3	6	-	-	-	-	-	16	-	-
Southern Nevada CCOP	-	-	-	-	-	-	-	-	-	-	-	-	3	4	-
St Louis CCOP	-	-	1	3	16	4	-	-	-	-	-	-	5	-	1
St Louis University	-	-	-	-	2	4	-	-	-	-	-	-	-	-	-
Tennessee, U of	-	-	-	11	7	-	3	-	-	-	-	-	16	-	-
Upstate Carolina	-	1	1	1	5	-	-	-	-	-	-	-	3	-	-
Urology Ctr of CO	-	-	-	-	-	-	-	-	-	-	-	2	-	-	-
Utah, U of	3	-	-	-	11	-	-	-	-	-	-	5	31	5	-
Virginia Mason CCOP	-	7	-	-	14	3	-	4	-	1	-	-	7	-	-
Wayne State Univ	-	4	-	-	16	-	-	-	-	-	-	-	12	1	-
Wichita CCOP	-	-	3	-	-	-	-	-	-	-	2	-	7	2	1
ACOSOG	-	-	-	-	-	-	-	-	-	-	-	-	4	-	-
CALGB	-	-	-	-	-	-	-	-	-	-	-	-	113	-	-
CTSU-NOS	-	-	-	-	-	-	-	-	-	-	-	-	17	-	-
ECOG	-	-	-	-	-	-	-	-	-	-	-	-	200	-	3
NCCTG	-	-	-	-	-	-	-	-	-	-	-	-	84	-	1
NSABP	-	-	-	-	-	-	-	-	-	-	-	-	13	-	-
RTOG	-	-	-	-	-	-	-	-	-	-	-	-	9	-	-
<b>Total</b>	<b>75</b>	<b>77</b>	<b>28</b>	<b>44</b>	<b>583</b>	<b>109</b>	<b>22</b>	<b>8</b>	<b>1</b>	<b>18</b>	<b>5</b>	<b>238</b>	<b>1,038</b>	<b>36</b>	<b>10</b>

Note: Some studies may not be listed because they were either closed prior to July 1, 2010 or because they are currently active and but have not had any accrual through August 17, 2011. Accrual to Cancer Control Studies is listed in the Cancer Control Sections.

# GYNECOLOGIC COMMITTEE

The Gynecologic Committee was formally closed as of September 1, 2010.

### Closed Studies

- S0904, "Randomized Phase II Study of Docetaxel Followed by Vandetanib (ZD6474) vs. Docetaxel Plus Vandetanib in Patients with Persistent or Recurrent Epithelial Ovarian, Fallopian Tube, or Primary Peritoneal Carcinoma." Drs. Coleman and Sood. Activated: 3/15/10; Closed 8/1/11.

### Proposed Studies

- NCIC CTG OV.21, "A Phase II/III Study of Intraperitoneal (IP) Plus Intravenous (IV) Chemotherapy Versus IV Carboplatin Plus Paclitaxel in Patients with Epithelial Ovarian Cancer Optimally Debulked at Surgery Following Neoadjuvant Intravenous Chemotherapy." Dr. Armstrong.

No publication information for this cycle.

Gynecologic Committee  
Cumulative Accrual by Institution and Study  
For the Period Ending August 17, 2011

	S0904
Arizona, U of	7
Arkansas, U of	2
Bay Area CCOP	3
Colorado, U of	1
Davis, U of CA	6
Fox Chase Cancer Ctr	4
Irvine, U of CA	1
Loyola University	1
MD Anderson	36
Mississippi, Univ of	1
Montana CCOP	3
Ozarks Reg CCOP	19
Puget Sound	10
So Calif, U of	3
Southeast CCC CCOP	4
Southern Nevada CCOP	1
St Louis CCOP	2
Tulane University	1
Univ of Chicago MC	5
Univ of Maryland	2
Wichita CCOP	19
<b>Total</b>	<b>131</b>

Note: Some studies may not be listed because they were either closed prior to July 1, 2010 or because they are currently active but have not had any accrual through August 17, 2011.

# LEUKEMIA COMMITTEE

## Committee Leadership

Chair:	Frederick R. Appelbaum, M.D.
Vice-Chair:	Alan F. List, M.D.
Executive Officer:	Harry P. Erba, M.D., Ph.D.
Statisticians:	Megan Othus, Ph.D. Kenneth J. Kopecky, Ph.D. Holly Gundacker, M.S.

## Scientific Leadership

Translational Medicine:	Jerald P. Radich, M.D.
Pathology:	David R. Head, M.D.
Cytogenetics Liaison:	Diane Roulston, Ph.D. Min Fang, M.D., Ph.D.

## Designates

Clinical Research Associates:	Emilia G. Cantu Gaye L. Winakur, C.C.R.A. Connie Sparks
Data Coordinators:	Jean Barce Tracy Maher Camille White, C.C.R.P.
Nurse:	Keisha C. Humphries, R.N., B.S.N. Patricia A. Messina, R.N., O.C.N.
Patient Advocate:	Michelle J. Worman, L.V.N.
Pharmaceutical Science:	Holly O. Chan, Pharm.D. Craig Elg, Pharm.D.
Protocol Coordinator:	Sandi Fredette

## Time/Location

### Friday, October 14, 2011

Room: Regency East #1 & #2 (Ballroom Level)  
3:00 p.m. – 7:00 p.m.

## Agenda

### Introduction

Current Status of the Leukemia Committee - Dr. Appelbaum

## APL Studies

### Active Studies

- S0535, "A Phase II Study of ATRA, Arsenic Trioxide and Gemtuzumab Ozogamicin in Patients with Previously Untreated High-Risk Acute Promyelocytic Leukemia." Dr. Lancet. Activated: 11/15/07.

## AML/MDS Studies

### Active Studies

- S0703, "A Phase II Trial of Azacitidine (NSC-102816) Plus Gemtuzumab Ozogamicin as Induction and Post-Remission Therapy in Patients of Age 60 and Older with Previously Untreated Non-M3 Acute Myeloid Leukemia." Dr. Nand. Activated: 12/1/08.
- S0919, "A Phase II Study of Idarubicin and Ara-C in Combination with Pravastatin for Relapsed Acute Myelogenous Leukemia (AML)." Dr. Advani. Activated: 8/15/09.
- CTSU/E2905, "Randomized Phase III Trial Comparing the Frequency of Major Erythroid Response (MER) to Treatment with Lenalidomide (Revlimid) Alone and in Combination with Epoetin Alpha (Procrit®) in Subjects with Low-or Intermediate-1 Risk MDS and Symptomatic Anemia" Dr. Schiffer. Activated by ECOG: 1/29/09; Endorsed by SWOG: 2/15/09.
- CTSU/C10603, "A Phase III Randomized, Double-Blind Study of Induction (Daunorubicin/Cytarabine) and Consolidation (High-Dose Cytarabine) Chemotherapy + Midostaurin (PKC 412) (IND#101261) or Placebo in Newly Diagnosed Patients < 60 Years of Age with Flt3 Mutated Acute Myeloid Leukemia (AML)." Dr. Medeiros. Activated by CALGB: 4/1/08; Endorsed by SWOG: 2/1/09.
- E1905, "A Randomized Phase II Trial of Azacitidine with or without the Histone Deacetylase Inhibitor Entinostat for the Treatment of Myelodysplastic Syndrome, Chronic Myelomonocytic Leukemia (Dysplastic Type), and Acute Myeloid Leukemia with Multilineage Dysplasia." Dr. Erba. Activated by ECOG: 8/18/06; Activated by SWOG: 10/1/06.

### Closed Studies

- S0106, "A Phase III Study of the Addition of Gemtuzumab Ozogamicin (Mylotarg®) Induction Therapy Versus Standard Induction With Daunomycin and Cytosine Arabinoside Followed by Consolidation and Subsequent Randomization to Post-Consolidation Therapy With Gemtuzumab Ozogamicin (Mylotarg®) or No Additional Therapy for Patients Under Age 61 With Previously Untreated De Novo Acute Myeloid Leukemia (AML)." Drs. Petersdorf, Slovak and Willman. Activated: 5/15/04; Closed: 8/20/09.



# LEUKEMIA COMMITTEE

## Proposed Studies

- S1117, "A Randomized Phase II Study of Azacitidine in Combination with Lenalidomide vs. Azacitidine in Combination with Vorinostat vs. Azacitidine alone for Higher-Risk Myelodysplastic Syndromes (MDS)." Dr. Sekeres.

## ALL Studies

### Active Studies

- S0805, "Phase II Study of Combination of Hyper-CVAD and Dasatinib (NSC-732517) With or Without Allogenic Stem Cell Transplant in Patients With Philadelphia (Ph) Chromosome Positive and/or BCR-ABL Positive Acute Lymphoblastic Leukemia (ALL) (A BMT Study)." Dr. Ravandi. Activated: 9/1/09.
- S0910, "A Phase II Study of Epratuzumab (NSC-716711) in Combination with Cytarabine and Clofarabine for Patients with Relapsed or Refractory PH-Negative Precursor B-cell Acute Lymphoblastic Leukemia (ALL)." Dr. Advani. Activated: 8/15/10.
- C10403, "An Intergroup Phase II Clinical Trial for Adolescents and Young Adults with Untreated Acute Lymphoblastic Leukemia (ALL)." Dr. Advani. Activated by CALGB: 11/15/07; Activated by SWOG: 1/15/08.

### Proposed Studies

- C10701, "A Phase II Study of Dasatinib (Sprycel®)(IND #73969, NSC #732517) as Primary Therapy Followed by Transplantation for Adults  $\geq$  50 Years with Newly Diagnosed Ph+ Acute Lymphoblastic Leukemia by CALGB, ECOG, SWOG and NCIC CTG(CALGB 10701). Dr. Liedtke.

## CLL Studies

### Active Studies

- C10404, "A Genetic Risk-Stratified Randomized Phase II Study of Four Fludarabine/Antibody Combinations for Patients with Symptomatic, Previously Untreated Chronic Lymphocytic Leukemia." Dr. Godwin. Activated by CALGB: 1/15/08; Activated by SWOG: 3/15/09.
- E1908, "A Phase II Randomized Trial Comparing Standard and Low Dose Rituximab: Initial Treatment of Progressive Chronic Lymphocytic Leukemia in Elderly Patients Using Alemtuzumab and Rituximab." Dr. Libby. Activated by ECOG: 10/8/10; Endorsed by SWOG: 11/15/10.

## Other Studies

### Active Studies

- SWOG-9007, "Cytogenetic Studies in Leukemia Patients." Dr. Roulston. Activated: 7/15/91.
- S9910, "Leukemia Centralized Reference Laboratories and Tissue Repositories, Ancillary." Drs. Willman and Radich. Activated: 4/15/99.

### Proposed Studies

- "A Randomized Study of Standard Cytarabine Plus Daunomycin (7+3) Therapy vs. Idarubicin with High Dose Cytarabine (IA) with or without Vorinostat in Younger Patients with Previously Untreated Acute Myeloid Leukemia (AML)." Dr. Appelbaum.

## Publications

The publications listed below are those that have been received in published, submitted or accepted form by the Group Chair's Office since the Spring 2011 meeting agenda booklet publication list.

### Published/Accepted Manuscripts

- S0605 A phase 2 study of lenalidomide monotherapy in patients with deletion 5q acute myeloid leukemia: SWOG study S0605. M Sekeres, H Gundacker, J Lancet, A Advani, S Petersdorf, J Liesveld, D Mulford, T Norwood, C Willman, A List, F Appelbaum. Blood 118(3):523-528, 2011.
- Multiple Studies Influence of residual normal metaphases in acute myeloid leukemia patients with monosomal karyotype. B Xie, M Othus, B Medeiros, M Fang, F Appelbaum, E Estey. Haematologica 96(4):631-632, 2011.
- Multiple Studies Outcome of acute myeloid leukemia patients with monosomal karyotype who undergo hematopoietic cell transplantation. M Fang, B Storer, E Estey, M Othus, L Zhang, B Sandmaier, F Appelbaum. Blood 118(6):1490-1494, 2011.
- Multiple Studies Cytarabine dose for acute myeloid leukemia. Letter to the editor, BC Medeiros, M Othus, FR Appelbaum. New England Journal of Medicine, 364(22):2167-2168, 2011.
- Multiple Studies Prognostic implications of the IDH1 synonymous SNP rs11554137 in pediatric and adult AML: a Children's Oncology Group and Southwest Oncology Group Study. P Ho, K Kopecky, T Alonzo, R Gerbing, K. Miller, J Kuhn, R Ries, S

# LEUKEMIA COMMITTEE

Raimondi, B Hirsch, V Oehler, C Hurwitz, J Franklin, A Gamiš, S Petersdorf, J Anderson, J Godwin, G Reaman, C Willman, I Bernstein, J Radich, F. Appelbaum, D. Stirewalt, S. Meshinchi. Blood, 2011 Aug 26 [Epub ahead of print].

- E2997 Incidence of therapy-related myeloid neoplasia after initial therapy for CLL with fludarabine-cyclophosphamide versus fludarabine: long-term follow-up of US Intergroup study E2997. MR Smith, D Neuberg, IW Flinn, MR Grever, HM Lazarus, JM Rowe, G Dewald, JM Bennett, EM Paietta, JC Byrd, MA Hussein, FR Appelbaum, RA Larson, MR Litzow, MS Tallman. Blood 2011 Jul 29 [Epub ahead of print].

## Submitted Manuscripts

No publication information for this cycle.

**Leukemia Committee**  
**Cumulative Accrual by Institution and Study**  
**For the Period Ending August 17, 2011**

	C10403	C10404	C10501	C10603	E1905	E2905	S0521	S0535	S0605	S0703	S0805	S0910	S0919
Arkansas, U of	-	1	1	-	1	-	-	1	-	-	-	-	-
Atlanta Reg CCOP	-	-	-	1	-	-	-	-	-	-	-	-	-
Baylor College	-	-	-	1	-	-	-	-	-	-	-	1	1
Boston Univ Med Ctr	-	-	-	1	1	-	-	-	-	-	-	-	-
Central IL CCOP	-	-	-	-	-	-	1	-	1	6	-	-	-
Cincinnati MC, U of	-	-	-	1	-	-	-	-	1	-	-	-	-
Cleveland Clinic OH	12	-	-	-	1	-	-	-	7	-	-	2	10
Colorado, U of	-	-	-	-	1	-	-	-	3	-	-	-	-
Columbia River CCOP	-	-	-	-	-	-	-	-	-	7	-	-	-
Columbia University	-	-	-	-	-	1	-	-	-	-	-	-	-
Davis, U of CA	-	1	-	3	1	4	-	-	2	-	-	-	-
Grand Rapids CCOP	-	-	-	-	-	-	-	1	-	2	-	-	-
Greenville CCOP	-	-	-	-	-	1	-	-	-	-	-	1	-
H Lee Moffitt CC	-	-	-	4	-	7	-	-	11	-	-	-	-
Irvine, U of CA	-	-	-	3	-	-	-	-	-	-	-	-	-
Kansas City CCOP	-	-	-	-	1	1	-	-	-	3	-	-	-
Kansas, U of	-	-	-	-	-	-	-	-	-	4	-	-	-
Kentucky, U of	3	-	-	1	-	-	-	-	-	12	1	-	-
LSU-Shreveport CCOP	-	-	-	1	-	-	-	-	-	-	-	-	-
Loyola University	-	-	-	3	-	-	3	1	-	20	1	1	1
MD Anderson	-	-	-	-	-	-	-	-	-	-	2	-	-
MUSC, Hollings CC	6	7	2	6	-	-	1	2	-	3	-	-	-
Michigan CRC CCOP	1	-	-	-	-	-	-	-	-	2	-	-	-
Michigan, U of	4	-	-	-	1	-	4	-	1	12	-	-	-
Mississippi, Univ of	-	-	-	-	1	-	-	-	-	1	-	2	-
Montana CCOP	-	-	-	-	3	2	-	-	1	1	-	-	-
New Mexico MBCCOP	2	3	-	-	-	-	1	-	-	6	-	-	3
Ozarks Reg CCOP	-	-	-	-	1	-	-	-	-	-	-	-	-
Providence Hosp	-	-	-	2	-	-	-	-	2	-	-	-	-
Puget Sound	1	-	2	-	-	-	1	1	6	-	3	-	1
Rochester, Univ of	-	2	-	-	2	-	3	-	4	-	-	2	-
San Antonio, U of TX	-	2	-	-	-	-	-	-	-	-	-	-	-
Santa Rosa CCOP	-	-	-	-	1	-	-	-	-	-	-	-	-
So Calif, U of	-	-	-	-	-	-	-	-	-	1	-	-	-
Southeast CCC CCOP	-	-	-	-	2	-	1	-	-	3	-	-	-

**Leukemia Committee**  
**Cumulative Accrual by Institution and Study**  
**For the Period Ending August 17, 2011**

	C10403	C10404	C10501	C10603	E1905	E2905	S0521	S0535	S0605	S0703	S0805	S0910	S0919
St Louis CCOP	-	-	1	-	2	-	-	-	-	-	-	-	-
St Louis University	-	1	-	-	-	-	-	-	-	-	-	-	-
Stanford University	19	-	-	7	-	-	9	4	-	12	-	1	-
Tennessee, U of	-	-	-	2	4	-	-	-	1	-	-	-	-
Tulane University	-	-	-	-	-	-	1	-	-	-	-	-	-
Upstate Carolina	-	-	-	-	-	-	-	-	1	-	-	-	-
Utah, U of	2	-	2	-	-	-	1	1	-	-	-	2	-
Wayne State Univ	2	-	-	-	-	1	1	-	-	7	-	-	-
Wichita CCOP	1	3	-	1	-	-	3	2	-	4	-	-	1
CALGB	-	-	-	-	-	-	47	18	-	-	2	-	-
ECOG	-	-	-	-	-	-	28	11	-	-	2	-	-
<b>Total</b>	<b>53</b>	<b>20</b>	<b>8</b>	<b>37</b>	<b>23</b>	<b>17</b>	<b>105</b>	<b>42</b>	<b>41</b>	<b>106</b>	<b>11</b>	<b>12</b>	<b>17</b>

Note: Some studies may not be listed because they were either closed prior to July 1, 2010 or because they are currently active but have not had any accrual through August 17, 2011.

# LUNG COMMITTEE

## Committee Leadership

Chair:	David R. Gandara, M.D.
Vice-Chair:	TBD
Executive Officer:	Anne Schott, M.D.
Statisticians:	Mary Redman, Ph.D. James Moon, M.S. John Crowley, Ph.D.

## Scientific Leadership

Translational Medicine:	Philip C. Mack, Ph.D. Fred R. Hirsch, M.D., Ph.D.
Radiation Oncology:	Laurie E. Gaspar, M.D.
Surgery:	TBD
Medical Oncology:	Karen Kelly, M.D.
Pathology:	Ignacio I. Wistuba, M.D.
Developmental Therapeutics:	Roy S. Herbst, M.D., Ph.D.
Early Therapeutics:	Shirish M. Gadgeel, M.D.
<b>Designates</b>	
Clinical Research Associate:	Courtney L. Williamson, C.C.R.P.
Cancer Control Liaison:	Gary E. Goodman, M.D.
Community Affiliate:	Paul J. Hesketh, M.D.
Data Coordinators:	Larry Kaye Brian Zeller Camille White, C.C.R.P.
Nurses:	Kimberly M. Belzer, M.S., P.A.C.
Patient Advocate:	Bonnie J. Addario
Pharmaceutical Science:	Gilland Dea, Pharm.D. Jorge G. Avila, Pharm.D.
Protocol Coordinator:	Matthew Lozano

## Time/Location

### Saturday, October 15, 2011

Room: Regency Center (Ballroom Level)

11:30 a.m. - 3:30 p.m.

## Agenda

Opening Remarks

## Scientific Session

**"BATTLE-2: A Multi-Arm, Adaptive Randomization, Biomarker-Driven, Clinical Trial Program for Refractory NSCLC."** - Vassiliki Papadimitrakopoulou, M.D., MD Anderson Cancer Center.

**"Cancer Stem Cell-Directed Therapy in Lung Cancer."** - Gregory Kalemkerian, M.D., University of Michigan.

## New Proposals

- N107C, "A Phase III Trial of Post-Surgical Stereotactic Radiosurgery (SRS) Compared with Whole Brain Radiotherapy (WBRT) for Resected Metastatic Brain Disease." Dr. Brown.
- "A Randomized, Multi-Center, Open Label, Phase II Study of Neoadjuvant Chemotherapy or Neoadjuvant Chemoradiation Therapy with Cisplatin and Pemetrexed +/- Cetuximab in Lymph Node Positive, Stage II-IIIa, Non-Squamous, Non-Small Cell Lung Cancers Amenable for Surgical Resection." Dr. Kim.
- "Randomized Phase III Study of Whole Brain Radiation Therapy (WBRT) Versus WBRT + Tarceva for Patients with Non-Small Cell Lung Cancer (NSCLC) with Brain Metastases." Dr. Welsh.

## Active Studies

- S0905, "A Phase I / Randomized Phase II Study of Cediranib (NSC #732208) Versus Placebo in Combination with Cisplatin and Pemetrexed in Chemo-naïve Patients with Malignant Pleural Mesothelioma." Dr. Tsao. Activated: 3/15/10; Phase I Closed: 7/18/11.
- S0819, "A Randomized, Phase III Study Comparing Carboplatin / Paclitaxel or Carboplatin / Paclitaxel / Bevacizumab with or without Concurrent Cetuximab in Patients with Advanced Non-Small Cell Lung Cancer (NSCLC)." Drs. Herbst, Kim, Semrad, Gandara and Hirsch. Activated: 7/15/09.
- S0802, "A Randomized Phase II Trial of Weekly Topotecan with and without AVE0005 (Aflibercept; NSC-724770) in Patients with Platinum Treated Extensive Stage Small Cell Lung Cancer (E-SCLC)." Drs. Allen, Gadgeel, Kelly and Mack. Activated: 5/15/09; Platinum Refractory Stratum Closed: 7/15/11; Platinum Sensitive Stratum: Actively accruing.
- S0720, "Phase II ERCC1 and RRM1-Based Adjuvant Therapy Trial in Patients with Stage I Non-Small Cell Lung Cancer (NSCLC)." Drs. Zinner, Calhoun, Kernstine, Williams and Mack. Activated: 11/15/08; Temporarily Closed: 4/1/11.
- S0709, "A Phase II Selection Design of Pharmacodynamic Separation of Carboplatin / Paclitaxel / OSI-774 (Erlotinib; NSC-718781) or OSI-774 Alone in Advanced Non-Small Cell Lung Cancer (NSCLC) Patients with Performance Status 2 (PS-2) Selected by Serum Proteomics." Drs. Lara, Hesketh, Mack and Hirsch. Activated: 12/1/08.

# LUNG COMMITTEE

- S0702, "A Prospective Observational Multicenter Cohort Study to Assess the Incidence of Osteonecrosis of the Jaw (ONJ) in Cancer Patients with Bone Metastases Starting Zoledronic Acid Treatment." Drs. Van Poznak, Gralow, Schubert and Bagramian, and Ms. Hansen. Activated: 12/15/08.
- CTSU/CALGB 140503, "A Phase III Randomized Trial of Lobectomy versus Sublobar Resection for Small ( $\leq 2$  cm) Peripheral Non-Small Cell Lung Cancer." Dr. Mitchell. Activated: 1/15/08.
- CTSU/CALGB 30801, "A Randomized Phase III Double Blind Trial Evaluating Selective COX-2 Inhibition in COX-2 Expressing Advanced Non-Small Cell Lung Cancer." Dr. Reckamp. Activated: 2/15/10.
- CTSU/CALGB 30610, "Phase III Comparison of Thoracic Radiotherapy Regimens in Patients with Limited Small Cell Lung Cancer also Receiving Cisplatin and Etoposide." Drs. Gaspar and Gadgeel. Activated: 4/1/08.
- CTSU/E1505, "A Phase III Randomized Trial of Adjuvant Chemotherapy with or without Bevacizumab for Patients with Completely Resected Stage IB ( $\geq 4$  cm) – IIIA Non-Small Cell Lung Cancer (NSCLC)." Drs. Gandara and Vallieres. Activated: 7/1/07.

## Closed Studies

- S0722, "A Phase II Trial of MTOR Inhibitor, Everolimus (RAD001), in Malignant Pleural Mesothelioma (MPM)." Drs. Ou, Garland and Mack. Activated: 12/1/08; Closed: 9/15/11.
- S0635, "A Phase II Trial of the Combination of OSI-774 (Erlotinib; NSC-718781) and Bevacizumab (Rhumab VEGF; NSC-704865) in Stage IIIB and IV Bronchioloalveolar Carcinoma (BAC) and Adenocarcinoma with BAC Features (AdenoBAC)." Drs. West, Lau, Hirsch and Wozniak. Activated: 7/15/07; Closed: 8/15/11.
- S0526, "Phase II Trial of Pemetrexed in Patients with Selected Stage IIIB and IV Bronchioloalveolar Carcinoma (BAC)." Drs. Lau, Sanborn, Hirsch and Franklin. Activated: 7/1/06; Closed: 10/1/08.
- S0509, "A Phase II Trial of Novel Oral Anti-Angiogenic Agent AZD2171 (NSC-732208) in Malignant Pleural Mesothelioma." Drs. Garland, Wozniak and Pass. Activated: 11/1/05; Closed: 4/1/08.
- S0429, "A Pilot (Phase I) Study of Weekly Docetaxel and Cetuximab Chemoradiation for Poor Risk Stage III Non-Small Cell Lung Cancer." Drs. Chen, Pandya, Kelly, Lau, Gaspar and Hirsch. Activated: 4/1/06; Closed: 8/15/09.

- S0424, "Molecular Epidemiology Case-Series Study of Non-Small Cell Lung Cancer in Smoking and Non-Smoking Women and Men." Drs. Ambrosone, Santella, Albain and Mack. Activated: 10/1/05; Closed: 3/15/11.

## Proposed Studies

- S0908, "Personalized Chemoradiation for Stage III Nonsmall Cell Lung Cancer (NSCLC) Patients with Large ( $> 37\%$ ) V20." Dr. Gaspar.
- S1114, "Phase II/III Trial to Test the Efficacy of AZD2171 in Combination with Cisplatin and Etoposide for Subjects with Previously Untreated Extensive Stage Small Cell Lung Cancer." Dr. Heymach.

## Publications

The publications listed below are those that have been received in published, submitted or accepted form by the Group Chair's Office since the Spring 2011 meeting agenda booklet publication list.

## Published/Accepted Manuscripts

- S9336 (R9309) Higher biologically effective dose of radiotherapy is associated with improved outcomes for locally advanced non-small cell lung carcinoma treated with chemoradiation: an analysis of the Radiation Therapy Oncology Group. M Machtay, K Bae, B Movsas, R Paulus, EM Gore, R Komaki, K Albain, WT Sause, WJ Curran. International Journal of Radiation Oncology, Biology and Physics, 2010 Oct 25 [Epub ahead of print]
- S0509 Phase II study of AZD2171 in patients with malignant pleural mesothelioma: SWOG S0509. LL Garland, K Chansky, A Wozniak, A Tsao, SM Gadgeel, C Verschraegen, MA DaSilva, M Redman, DR Gandara. Journal of Thoracic Oncology, accepted 5/27/11.
- R0214 Phase III comparison of prophylactic cranial irradiation versus observation in patients with locally advanced non-small-cell lung cancer: primary analysis of radiation therapy oncology group study RTOG 0214. EM Gore, K Bae, S Wong, A Sun, J Bonner, SE Schild, LE Gaspar, JA Bogart, M Werner-Wasik, H Choy. Journal of Clinical Oncology 29(3):272-278, 2011.

## Submitted Manuscripts

No publication information for this cycle.

**Lung Committee**  
**Cumulative Accrual by Institution and Study**  
**For the Period Ending August 17, 2011**

	C140503	C30610	C30801	E1505	S0533	S0635	S0636	S0709	S0720	S0722	S0802	S0819	S0905
Arizona, U of	-	-	-	-	-	-	-	-	5	1	6	-	-
Arkansas, U of	-	1	-	1	1	1	-	1	-	-	3	4	-
Atlanta Reg CCOP	-	-	-	3	-	3	3	-	-	-	4	5	-
BAMC/WHMC	-	-	-	2	-	-	-	-	-	-	1	-	-
Bay Area CCOP	-	-	-	-	-	-	-	-	-	-	-	1	-
Baylor College	-	-	-	-	-	-	-	-	-	-	1	2	-
Beaumont CCOP	-	-	-	7	-	-	-	-	-	-	-	-	-
Boston Univ Med Ctr	-	-	-	2	-	-	-	-	-	-	-	-	-
Central IL CCOP	-	3	-	-	-	4	-	2	3	1	17	28	-
Cincinnati MC, U of	-	-	-	4	-	-	-	-	1	-	1	-	-
City of Hope Med Ctr	-	-	-	-	-	-	-	-	3	-	2	-	-
Cleveland Clinic OH	-	-	-	4	-	-	-	-	-	-	1	-	-
Colorado, U of	2	-	-	6	4	4	-	-	2	3	3	8	-
Columbia River CCOP	-	-	-	-	-	-	3	-	4	3	1	-	-
Columbia University	-	-	-	2	-	-	-	-	-	-	2	2	-
Columbus CCOP	-	-	-	-	-	5	-	-	2	1	-	4	-
Davis, U of CA	3	4	1	14	1	8	12	9	8	-	11	44	-
Dayton CCOP	-	-	-	3	-	-	-	-	4	2	12	10	-
Grand Rapids CCOP	-	-	-	7	-	8	1	-	2	-	3	5	-
Greenville CCOP	-	-	-	11	-	-	-	-	1	-	-	15	-
Gulf Coast MBCCOP	-	-	-	3	2	-	-	-	-	-	2	1	-
H Lee Moffitt CC	-	-	-	16	-	-	2	-	5	-	-	8	-
Harrington CC	-	-	-	1	-	-	-	-	-	-	-	-	-
Hawaii MBCCOP, U of	-	-	1	4	-	-	-	-	7	-	-	3	-
Henry Ford Hosp	-	-	-	4	-	4	1	-	-	-	-	2	-
INCan	-	-	-	-	-	-	-	-	-	-	-	2	-
Irvine, U of CA	-	-	-	3	-	-	-	-	-	3	-	8	-
KaiserPermanenteNCAL	-	1	-	8	-	8	17	4	-	-	-	-	-
Kansas City CCOP	-	-	-	-	-	-	-	-	-	-	-	9	-
Kansas, U of	-	-	-	10	3	5	3	7	-	-	11	14	-
Kentucky, U of	-	-	-	-	-	1	1	-	-	-	2	15	-
LSU-New Orleans CCOP	-	-	-	-	-	-	-	-	-	-	5	3	-
LSU-Shreveport	-	-	-	-	1	-	-	-	-	-	-	-	-
LSU-Shreveport CCOP	-	-	1	-	-	-	-	-	-	-	-	5	-
Lahey Clinic Med Ctr	-	-	-	1	-	-	-	-	-	-	1	-	-
Loyola University	-	-	-	2	2	1	2	-	-	-	4	7	-

**Lung Committee**  
**Cumulative Accrual by Institution and Study**  
**For the Period Ending August 17, 2011**

	C140503	C30610	C30801	E1505	S0533	S0635	S0636	S0709	S0720	S0722	S0802	S0819	S0905
MD Anderson	-	-	-	-	-	-	-	-	14	-	8	16	
MUSC, Hollings CC	-	1	-	-	3	4	-	-	-	-	5	-	
Michigan CRC CCOP	-	-	-	-	3	6	1	12	3	8	10	-	
Michigan, U of	-	1	-	2	-	-	-	1	3	4	-	4	
Mississippi, Univ of	-	-	-	4	-	3	-	1	1	-	2	-	
Montana CCOP	-	-	-	4	1	6	5	-	3	2	4	3	-
Nevada Cancer Inst	-	-	-	-	-	-	-	-	-	-	3	-	
New Mexico MBCCOP	-	-	-	-	-	-	-	-	2	-	-	-	
Northwest CCOP	-	-	-	3	-	-	-	-	-	-	4	-	
Oregon Hlth Sci Univ	-	-	-	2	2	-	-	3	-	2	4	-	
Ozarks Reg CCOP	-	-	1	2	-	3	2	2	-	3	-	-	
Providence Hosp	-	-	-	-	-	-	-	2	-	-	-	-	
Puget Sound	5	-	-	8	-	3	14	-	3	1	1	6	-
Rochester, Univ of	-	-	-	6	5	5	-	-	2	2	9	-	
San Antonio, U of TX	-	1	-	8	-	-	-	-	-	3	7	-	
Santa Rosa CCOP	-	-	-	-	1	-	-	-	-	-	-	-	
Scott & White CCOP	-	-	-	-	-	-	-	4	-	1	-	-	
So Calif, U of	-	-	-	3	-	-	-	-	-	-	2	-	
Southeast CCC CCOP	-	-	-	6	3	1	-	-	3	19	6	-	
Southern Nevada CCOP	-	-	-	-	-	-	-	-	-	1	3	-	
St Louis CCOP	-	-	-	3	-	-	-	-	-	2	2	-	
St Louis University	-	-	-	-	-	-	-	-	1	-	-	-	
Tennessee, U of	2	-	-	5	2	-	-	-	-	3	5	-	
Upstate Carolina	-	-	-	3	-	1	1	-	2	-	2	5	-
Utah, U of	-	-	-	5	-	1	-	3	-	-	5	13	-
Wayne State Univ	-	1	-	10	1	-	-	-	3	7	3	7	-
Wichita CCOP	-	12	-	-	-	9	8	-	7	-	12	3	-
ACOSOG	-	-	-	-	-	-	-	-	-	-	6	-	
CALGB	-	-	-	-	-	-	-	-	-	-	57	-	
CTSU-NOS	-	-	-	-	-	-	-	-	-	-	3	-	
ECOG	-	-	-	-	-	-	-	-	-	-	43	-	
NCCTG	-	-	-	-	-	-	-	-	-	-	59	-	
NSABP	-	-	-	-	-	-	-	-	-	-	9	-	
RTOG	-	-	-	-	-	-	-	-	-	-	7	-	
<b>Total</b>	<b>12</b>	<b>25</b>	<b>4</b>	<b>192</b>	<b>29</b>	<b>84</b>	<b>89</b>	<b>29</b>	<b>85</b>	<b>57</b>	<b>163</b>	<b>502</b>	<b>20</b>

Note: Some studies may not be listed because they were either closed prior to July 1, 2010 or because they are currently active but have not had any accrual through August 17, 2011.

# LYMPHOMA COMMITTEE

## Committee Leadership

Chair:	Richard I. Fisher, M.D.
Vice-Chair:	Thomas P. Miller, M.D.
Executive Officer:	Harry P. Erba, M.D., Ph.D.
Statisticians:	Michael LeBlanc, Ph.D. Bryan Goldman, M.S. Joseph M. Unger, M.S.

## Scientific Leadership

Translational Medicine:	Richard E. Davis, M.D.
Radiation Oncology:	Louis S. Constine, M.D.
Pathology	Rita M. Brazier, M.D.
Early Therapeutics:	Daruka Mahadevan, M.D., Ph.D.

## Designates

Clinical Research Associates:	Ellen Chase, B.S. Erin M. Cebula, M.P.H. John W. Hayslip, M.D.
Cancer Control:	John W. Hayslip, M.D.
Data Coordinators:	Jeri Jardine Iris Syquia
Nurse:	Nancy H. Sprouse, R.N.
Patient Advocate:	Hildy Dillon, M.P.H.
Pharmaceutical Science:	Lara M. Aug, Pharm.D. Craig Elg, Pharm.D.
Protocol Coordinator:	Megan Wardeski

## Time/Location

**Saturday, October 15, 2011**

Room: Regency East (Ballroom Level)

11:30 a.m. – 3:30 p.m.

## Agenda

### Hodgkin Lymphoma

- S0806, "A Phase I/II Trial of Vorinostat (SAHA) (NSC-701852) in Combination with Rituximab-CHOP in Patients with Newly Diagnosed Advanced Stage Diffuse Large B-Cell Lymphoma (DLBCL)." Drs. Persky, Miller and Rimsza. Activated: 11/15/10.
- S0816, "A Phase II Trial of Response-Adapted Therapy of Stage III-IV Hodgkin Lymphoma Using Early Interim FDG-PET Imaging." Drs. Press, Friedberg, Brown, Rimsza and Cook. Activated: 7/1/09.
- CTSU/CALGB 50604, "Phase II Trial of Response-Adapted Chemotherapy Based on Positron Emission Tomography for Non-Bulky Stage I and II Hodgkin Lymphoma." Dr. Shustov. Activated: 8/1/10.

### Non-Hodgkin Lymphoma

- S1001, "A Phase II Trial of PET-Directed Therapy for Early Stage Diffuse Large B-Cell Lymphoma." Dr. Persky. Activated: 7/18/11.
- CTSU/BMT CTN 0701, "Phase II Trial of Non-Myeloablative Allogeneic Hematopoietic Cell Transplantation for Patients with Relapsed Follicular Non-Hodgkin's Lymphoma Beyond First Complete Response." Dr. Nademanee. Activated: 4/1/09.
- CTSU/CALGB 50303, "Phase III Randomized Study of R-CHOP v. Dose-Adjusted EPOCH-R with Molecular Profiling in Untreated De Novo Diffuse Large B-Cell Lymphomas." Dr. Fisher. Activated: 9/15/06.

### Closed Studies

- SWOG-8819, "Central Lymphoma Repository Tissue Procurement Protocol." Drs. Rimsza, Miller, and Fisher. Activated: 2/15/89; Closed: 7/1/11.
- SWOG-8947, "Central Lymphoma Serum Repository Protocol." Dr. Fisher. Activated: 4/15/90; Closed: 7/1/11.
- SWOG-9245, "Central Lymphoma Repository Tissue Procurement Protocol for Relapse or Recurrent Disease." Drs. Rimsza, Miller, and Fisher. Activated: 3/15/93; Closed: 7/1/11.
- S0350, "Phase II Trial of Cisplatin Plus Etoposide Plus Gemcitabine Plus Solumedrol (PEGS) in Peripheral T-Cell Non-Hodgkin's Lymphoma." Drs. Mahadevan, Persky, and Spier. Activated: 9/15/05; Closed: 12/1/10.

- S0801, "A Phase II Study of Iodine-131 Labeled Tositumomab in Combination with Cyclophosphamide, Doxorubicin, Vincristine, Prednisone and Rituximab Therapy for Patients with Advanced Stage Follicular Non-Hodgkin's Lymphoma." Drs. Friedberg, Press and Rimsza. Activated: 4/1/09; Closed: 12/15/10.

### Proposed Studies

- S1106, "A Randomized Phase II Trial of R-HCVAD-MTX/ARA-C Induction Followed by Consolidation With an Autologous Stem Cell Transplant vs. R-Bendamustine Induction Followed by Consolidation With an Autologous Stem Cell Transplant for Previously Untreated Patients  $\leq$  65 Years of Age With mantle Cell Lymphoma." Dr. Bernstein. (Scheduled for Activation 10/1/11).

# LYMPHOMA COMMITTEE

- S1108, “Phase II Trial of the Aurora Kinase A Inhibitor, MLN8237, in Peripheral T-Cell Non-Hodgkin Lymphoma.” Dr. Barr. (Scheduled for Activation 9/29/11).
- E1410, “Intergroup Randomized Phase 2 Four Arm Study In Patients  $\geq$  60 With Previously Untreated Mantle Cell Lymphoma Of Therapy With: Arm A = Rituximab + Bendamustine Followed By Rituximab Consolidation (RB  $\rightarrow$  R); Arm B = Rituximab + Bendamustine + Bortezomib Followed By Rituximab Consolidation (RBV  $\rightarrow$  R), Arm C = Rituximab + Bendamustine Followed By Lenalidomide + Rituximab Consolidation (RB  $\rightarrow$  LR) or Arm D = Rituximab + Bendamustine + Bortezomib Followed By Lenalidomide + Rituximab Consolidation (RBV  $\rightarrow$  LR).” Dr. Till.
- antibody plus chemo-therapy but not chemotherapy alone. DO Persky, D Dornan, BH Goldman, RM Braziel, RI Fisher, M LeBlanc, DG Maloney, OW Press, TP Miller, LM Rimsza. Haematologica, submitted 7/11.
- Multiple Studies Genetic polymorphisms in oxidative stress-related genes are associated with outcomes following anthracycline-based therapy for aggressive B-cell non-Hodgkin lymphoma. HL Tardiff, S Yao, BH Goldman, K Lee, CM Spier, ML LeBlanc, LM Rimsza, DO Persky, TP Miller, RI Fisher, CB Ambrosone, MM Briehl. Clinical Cancer Research, submitted 8/11.

## Translational Medicine Studies

- S8809/S9800/S9911, “Association of Fcg receptor genotypes with response and clinical benefit with addition of rituximab to CHOP chemotherapy in patients with follicular lymphoma (FL) and diffuse large B cell lymphoma (DLBCL)” Drs. Persky and Rimsza.
- S8516/S8736/S9125/S9240/S9349/S9704/S0014, “Pharmacogenomics of Oxidative Stress-Related Genes in Lymphoma.” Drs. Briehl, Rimsza, and Ambrosone.
- S8947/S9800/S9911/S0016, “Vitamin D Insufficiency and Follicular Lymphoma Prognosis.” Drs. Kelly and Friedberg.

## Other Business

Translational Medicine Subcommittee Report (Dr. Davis)

## Publications

The publications listed below are those that have been received in published, submitted or accepted form by the Group Chair’s Office since the Spring 2011 meeting agenda booklet publication list.

## Published/Accepted Manuscripts

- S0517 A phase 2 study of vorinostat for treatment of relapsed or refractory Hodgkin lymphoma: SWOG S0517. M Kirschbaum, B Goldman, J Zain, JR Cook, L Rimsza, S Forman, RI Fisher. Leukemia & Lymphoma, 2011 Aug 8 [Epub ahead of print].

## Submitted Manuscripts

- Multiple Studies Fc gamma receptor 3a genotype predicts overall survival for follicular lymphoma patients treated on Southwest Oncology Group trials with combined monoclonal



**Lymphoma Committee**  
**Cumulative Accrual by Institution and Study**  
**For the Period Ending August 17, 2011**

	C50303	C50604	CTN0701	S0350	S0433	S0801	S0806	S0816
Arizona, U of	-	-	-	7	5	8	2	1
Arkansas, U of	-	-	-	1	-	-	-	2
Atlanta Reg CCOP	-	-	-	-	1	-	-	-
BAMC/WHMC	1	-	-	-	-	-	-	-
BC Cancer Agency	-	-	-	1	-	-	-	-
Boston Univ Med Ctr	-	-	-	-	-	-	-	2
Central IL CCOP	2	1	-	3	-	8	-	5
City of Hope Med Ctr	-	2	-	-	5	-	2	-
Cleveland Clinic OH	1	-	-	-	1	-	-	2
Colorado, U of	-	-	-	-	-	-	-	1
Columbia River CCOP	-	-	-	-	-	-	-	2
Columbia University	-	-	-	-	-	-	-	3
Columbus CCOP	-	-	-	-	-	3	-	-
Davis, U of CA	4	-	2	2	-	-	-	1
Dayton CCOP	-	-	-	-	10	5	-	1
Grand Rapids CCOP	-	-	-	-	-	4	-	1
H Lee Moffitt CC	-	-	1	-	3	-	-	-
Harrington CC	3	-	-	-	-	-	-	-
Hawaii MBCCOP, U of	-	-	-	-	-	-	-	2
KaiserPermanenteNCAL	-	-	-	1	-	-	-	-
Kansas, U of	5	-	-	-	1	2	-	2
Kentucky, U of	-	-	-	2	-	-	-	-
LSU-Shreveport CCOP	-	-	-	2	-	-	-	2
Loyola University	1	-	-	2	2	6	-	1
MD Anderson	-	-	-	-	-	-	-	13
MUSC, Hollings CC	2	-	-	-	-	-	-	1
Michigan CRC CCOP	-	-	-	1	-	-	-	1
Michigan, U of	-	-	-	-	4	-	-	7
Montana CCOP	-	-	-	-	-	3	-	1
New Mexico MBCCOP	1	-	-	-	-	-	-	1
Providence Hosp	2	-	-	-	-	-	-	-
Puget Sound	7	-	-	2	13	19	-	7
Rochester, Univ of	1	2	-	9	35	11	2	10
San Antonio, U of TX	5	-	-	-	-	-	-	-
So Calif, U of	1	-	-	-	-	-	-	-
Southeast CCC CCOP	-	-	-	-	-	2	-	1

**Lymphoma Committee**  
**Cumulative Accrual by Institution and Study**  
**For the Period Ending August 17, 2011**

	C50303	C50604	CTND701	S0350	S0433	S0801	S0806	S0816
St Louis CCOP	-	-	-	-	3	2	-	-
St Louis University	2	1	-	-	-	-	-	-
Tennessee, U of	-	-	-	-	-	1	-	-
Upstate Carolina	-	-	-	1	3	1	-	2
Utah, U of	-	-	-	-	-	6	-	2
Wayne State Univ	-	-	-	-	-	-	-	2
Wichita CCOP	1	1	-	-	-	6	3	3
CALGB	-	-	-	-	-	-	-	51
ECOG	-	-	-	-	-	-	-	34
NCCTG	-	-	-	-	-	-	-	8
NSABP	-	-	-	-	-	-	-	2
<b>Total</b>	<b>39</b>	<b>7</b>	<b>3</b>	<b>34</b>	<b>86</b>	<b>87</b>	<b>9</b>	<b>174</b>

Note: Some studies may not be listed because they were either closed prior to July 1, 2010 or because they are currently active but have not had any accrual through August 17, 2011.

# MELANOMA COMMITTEE

## Committee Leadership

Chair:	Antoni Ribas, M.D.
Vice-Chair:	William E. Carson III, M.D.
Executive Officer:	Bruce Redman, D.O.
Statisticians:	Megan Othus, Ph.D. James Moon, M.S.

## Scientific Leadership

Translational Medicine:	TBD John P. Fruehauf, M.D., Ph.D.
Radiation Oncology:	TBD
Surgery:	Robert H.I. Andtbacka, M.D.
Medical Oncology:	Lawrence E. Flaherty, M.D.
Pathology:	Ralph J. Tuthill, M.D.
Non-Melanoma Skin Cancer:	TBD
Early Therapeutics:	Ragini R. Kudchadkar, M.D.
<b>Designates</b>	
Clinical Research Associates:	Sandy Allten, R.N., O.C.N.
Cancer Control Liaison:	TBD
Data Coordinator:	Jennie Barrett
Nurse:	Karen L. Mack, R.N.P. Ann M. Lau Clarke, B.S.N., R.N.
Patient Advocate:	Valerie Guild
Pharmaceutical Science:	Jorge G. Avila, Pharm.D.
Protocol Coordinator:	Matthew Lozano

## Time/Location

### Friday, October 14, 2011

Room: Regency East #1 & #2 (Ballroom Level)  
7:30 a.m. – 9:30 a.m.

## Agenda

### Scientific Session

7:30 – 7:50 am	<b>“The last 20 years and SWOG’s role in the evolution of the management of melanoma.”</b> Vernon K. Sondak, M.D., Moffitt Cancer Center.
7:50 – 8:10 am	<b>“Metastatic melanoma in 2011: Breakthroughs and opportunities for improvement.”</b> - Antoni Ribas, M.D., UCLA.
8:10 – 8:30 am	Update of open SWOG and CTSU trials.
8:30 – 8:40 am	Update on S0008 final results – Lawrence Flaherty, M.D.

## Newly Proposed Studies (5 – 10 minutes each)

- “HDIFN for One Month Followed by Pegylated-Interferon.” Dr. Carson.
- “EORTC 18081: Adjuvant Pegylated-Interferon in Stage III N1.” Dr. Sondak.
- “Radiation Use During Vemurafenib Treatment.” Dr. Grossmann.
- “Dual Inhibition of MEK and PI3Kinase in NRAS Mutant Melanoma.” Dr. Daud.
- “Ipilimumab 3 vs 10 mg/kg, With or Without Maintenance Therapy.” Dr. Chmielowski.
- “Ipilimumab After SRT With and Without Temozolomide.” Dr. Margolin.
- “Phase II Study of Vemurafnib/Carboplatin/Paclitaxel in Patients With Metastatic Melanoma Whose Disease Has Progressed on a Prior BRAF Inhibitor Treatment.” Dr. Kim.
- “Phase II Study of Vemurafnib/Ipilimumab in Patients With Metastatic Melanoma Harboring V600 BRAF Mutation Whose Disease has Progressed on a Prior BRAF Inhibitor Treatment.” Dr. Kim.
- “Ipilimumab in Patients With Metastatic Choroidal Melanoma.” Dr. Lao.

## Active Studies

- S0933, “Phase II Study of R04929097 (NSC-749225) in Advanced Melanoma.” Drs. Margolin and Gajewski. Activated: 10/28/10.
- CTSU/E1609, “A Phase III Randomized Study of Adjuvant Ipilimumab Anti-CTLA4 Therapy Versus High-Dose Interferon Alpha-2b for Resected High-Risk Melanoma” Dr. Flaherty. Activated: 7/15/11.

## Closed Studies

- S0826, “A Phase II Trial of SCH 727965 (NSC 747135) in Patients with Stage IV Melanoma.” Drs. Lao and Fruehauf. Activated: 7/1/09; Closed: 2/9/10.

## Proposed Studies

# MELANOMA COMMITTEE

## Publications

The publications listed below are those that have been received in published, submitted or accepted form by the Group Chair's Office since the Spring 2011 meeting agenda booklet publication list.

### Published/Accepted Manuscripts

- S9430 A phase II trial of complete surgical resection for stage IV melanoma: results of SWOG clinical trial S9430. JA Sosman, J Moon, RJ Tuthill, JA Warneke, JT Vetto, BG Redman, PY Liu, JM Unger, LE Flaherty, V Sondak. Cancer, 2011 Mar 31 [Epub ahead of print].

### Submitted Manuscripts

No publication information for this cycle.

**Melanoma Committee**  
**Cumulative Accrual by Institution and Study**  
**For the Period Ending August 17, 2011**

	E1697	S0826	S0933
Arizona, U of	10	-	1
Arkansas, U of	10	2	-
Atlanta Reg CCOP	12	-	-
Bay Area CCOP	-	1	-
Beaumont CCOP	3	-	-
Boston Univ Med Ctr	-	1	-
Cincinnati MC, U of	4	-	-
City of Hope Med Ctr	2	-	-
Cleveland Clinic OH	3	-	-
Colorado, U of	2	3	-
Columbia River CCOP	14	4	-
Columbia University	-	-	1
Columbus CCOP	-	-	3
Davis, U of CA	16	-	-
Dayton CCOP	9	4	1
Grand Rapids CCOP	-	6	1
Gulf Coast MBCCOP	-	-	1
H Lee Moffitt CC	2	-	-
Harrington CC	2	-	-
Irvine, U of CA	-	1	-
Kaiser Permanente NCAL	10	-	-
Kansas City CCOP	-	2	1
Kansas, U of	2	1	1
LSU-New Orleans CCOP	-	2	-
LSU-Shreveport	1	-	-
Loyola University	1	3	2
MD Anderson	1	-	-
Michigan CRC CCOP	-	2	-
Michigan, U of	1	11	6
Montana CCOP	-	-	2
Nevada Cancer Inst	-	2	-
Oregon Hlth Sci Univ	1	1	-
Ozarks Reg CCOP	2	-	-
Puget Sound	5	1	3
Rochester, Univ of	2	2	-
San Antonio, U of TX	6	2	2
Southeast CCC CCOP	7	4	2
Southern Nevada CCOP	-	-	1
St Louis CCOP	-	3	2
Tennessee, U of	-	2	-

**Melanoma Committee**  
**Cumulative Accrual by Institution and Study**  
**For the Period Ending August 17, 2011**

	E1697	S0826	S0933
Upstate Carolina	-	-	1
Utah, U of	8	4	-
Wayne State Univ	8	8	-
Wichita CCOP	-	-	1
<b>Total</b>	144	72	32

Note: Some studies may not be listed because they were either closed prior to July 1, 2010 or because they are currently active but have not had any accrual through August 17, 2011.

## Future Group Meeting Dates Mark Your Calendar!

### 2012

— April 11-14 —  
San Francisco, CA

— October 17-20 —  
Chicago, IL

### 2013

— May 1-4 —  
San Francisco, CA

— October 9-12 —  
Chicago, IL

### 2014

— April 30-May 3 —  
San Francisco, CA

— Oct 29-Nov 1 —  
Chicago, IL

Check the SWOG website ([swog.org](http://swog.org)) for updates!







**Do you have a few minutes between meetings? Stop by the SWOG registration desk in the Los Rios Foyer to check your e-mail and/or print your boarding pass!**

---

---

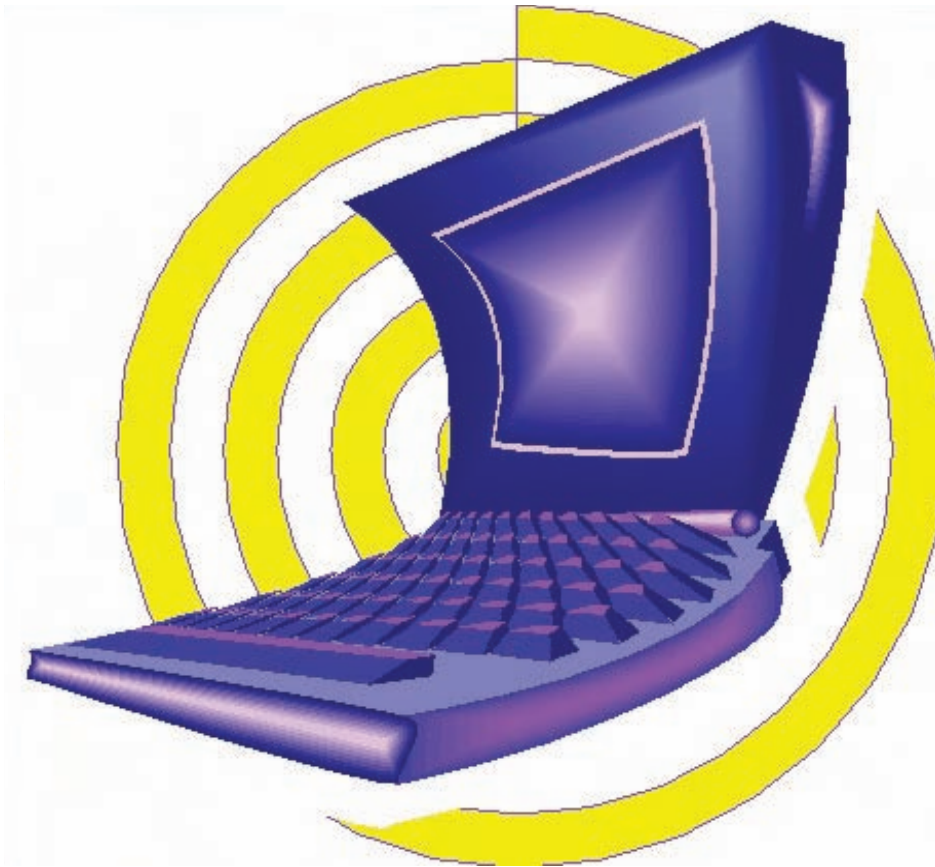

# Fall 2011 Group Meeting Commercial Supporters

## CME SUPPORTERS

### Double Platinum

Novartis

### Platinum

Amgen

Eli Lilly & Co.

### Gold

Otsuka

### Silver

Abbott Pharmaceuticals

Eisai

Merck

### Bronze

Astellas Pharmaceuticals

## NON-CME SUPPORTERS

### Double Platinum

Genentech

GlaxoSmithKline

Millennium Pharmaceuticals

Sanofi-Aventis

### Platinum

Boehringer Ingelheim

Pharmaceuticals

### Silver

Sigma Tau Pharmaceuticals

### Bronze

DDOTS, Inc.

Myriad Genetics

Prometheus Labs

Varian Medical Systems

**We appreciate their support!**